

PNEUMATIC ELEVATOR TROLLEY

Two-column, pneumatically operated elevator in mobile version for reciprocating and diaphragm pumps.

Part nbr. 79717 012002

DESCRIPTION

The pneumatic elevator trolley essentially consists of the stand area (base plate) ①, designed for 30 liter containers ②, the wheels ③ and the steering rollers ④ as well as the air operated elevator (guide tubes ⑤, tube stirrup ⑥, pump support ⑦ and manual lever valve ⑧).

By operating the manual lever valve (turn it upwards), the tube stirrup in conjunction with the guide tubes acts as two pneumatic cylinders joined together, travels to its top end position.

The pump, that is fixed to the height-adjustable pump support, is lifted; the suction tube of the pump ⑨ leaves the container.

After the empty container has been replaced by a new one, the manual lever valve is operated again (by turning it downwards). The tube stirrup with pump support and pump travels to its bottom end position; the suction tube dips into the container.

- Upwards and downwards strokes are carried out at reduced speed.

The wheels at the rear enable safe handling of the elevator trolley and make it possible to go up and down stairs.

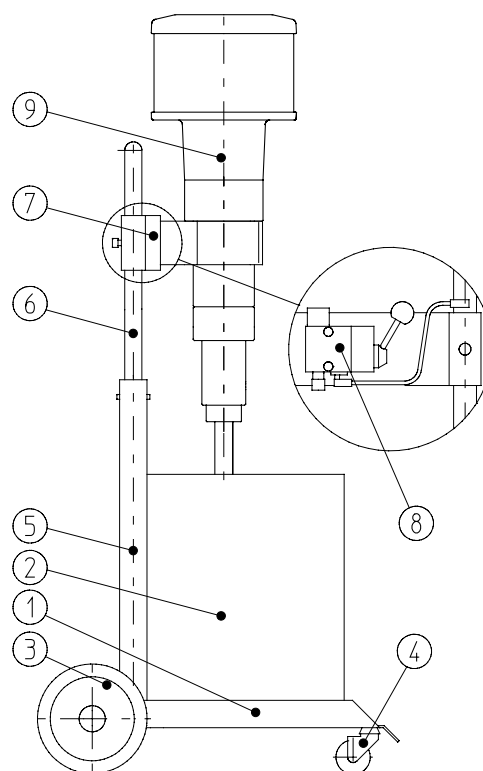
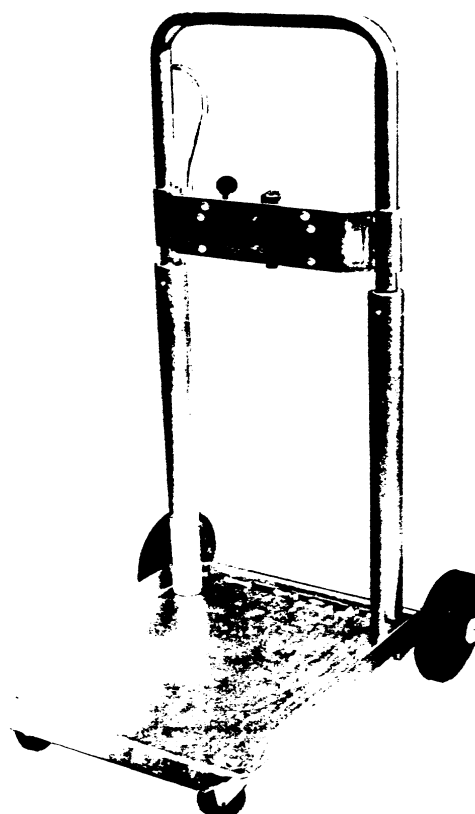

Replacement for issue of 06.92

Subject to change

Page 1 of 3

Prepared 07.12.99 Stengele

Checked 10.12.99 Kuhn

USER INFORMATION
- TECHN. PRODUCT DESCRIPTION -

Issued 12.99

B.17.05.07-P

TECHNICAL DATA

Operating air pressure	7	bar
Stroke	375	mm
Pressure line	DN 6	DA 8
Load carrying capacity approx.	40	kg
Weight	15.7	kg

CONSTRUCTION MATERIALS

Frame	Galvanized steel
Wheels	Plastic/non-conducting

DIMENSIONS

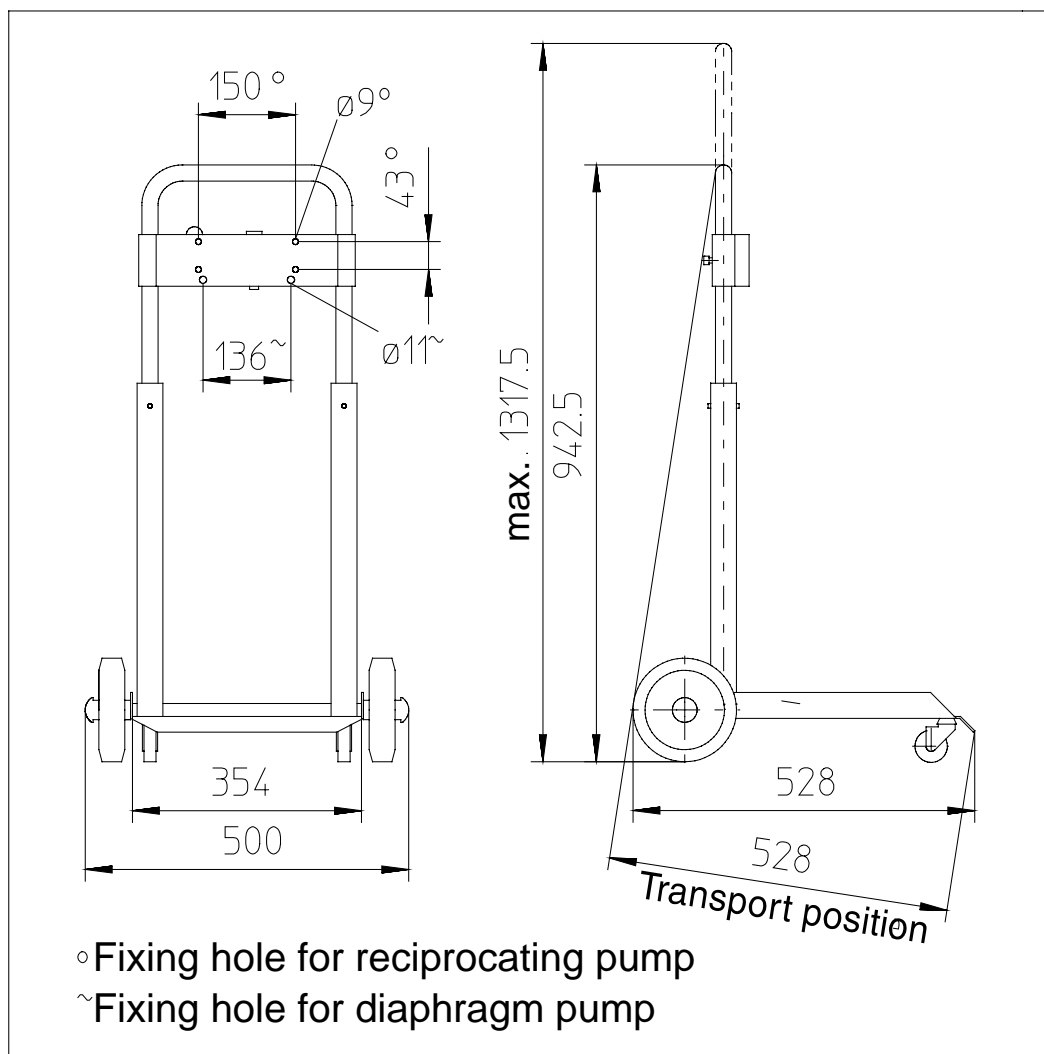

REMARK

This technical product description also serves as operating instructions.

Documentation and directives to be complied with

- ZH/200 Richtlinien für die Vermeidung von Zündgefahren
 infolge elektrostatischer Aufladung
 Carl Heymanns Verlag KG., Köln
- VBG 23 Verarbeiten von Anstrichstoffen
 Hauptverband der gewerblichen Berufsgenossenschaften
 Carl Heymanns Verlag KG., Köln

Associated documentation

- List of repair parts B.17.05.07-E
List of items in figure B.17.05.07-S

GRACO N.V.
Industrieterrein "Oude Bunders"
Loc. 2206 - Slakweidestraat 31
3630 Maasmechelen - Belgium
Tel.: 32 89 770 700 Fax: 32 89 770

PNEUMATIC ELEVATOR TROLLEY

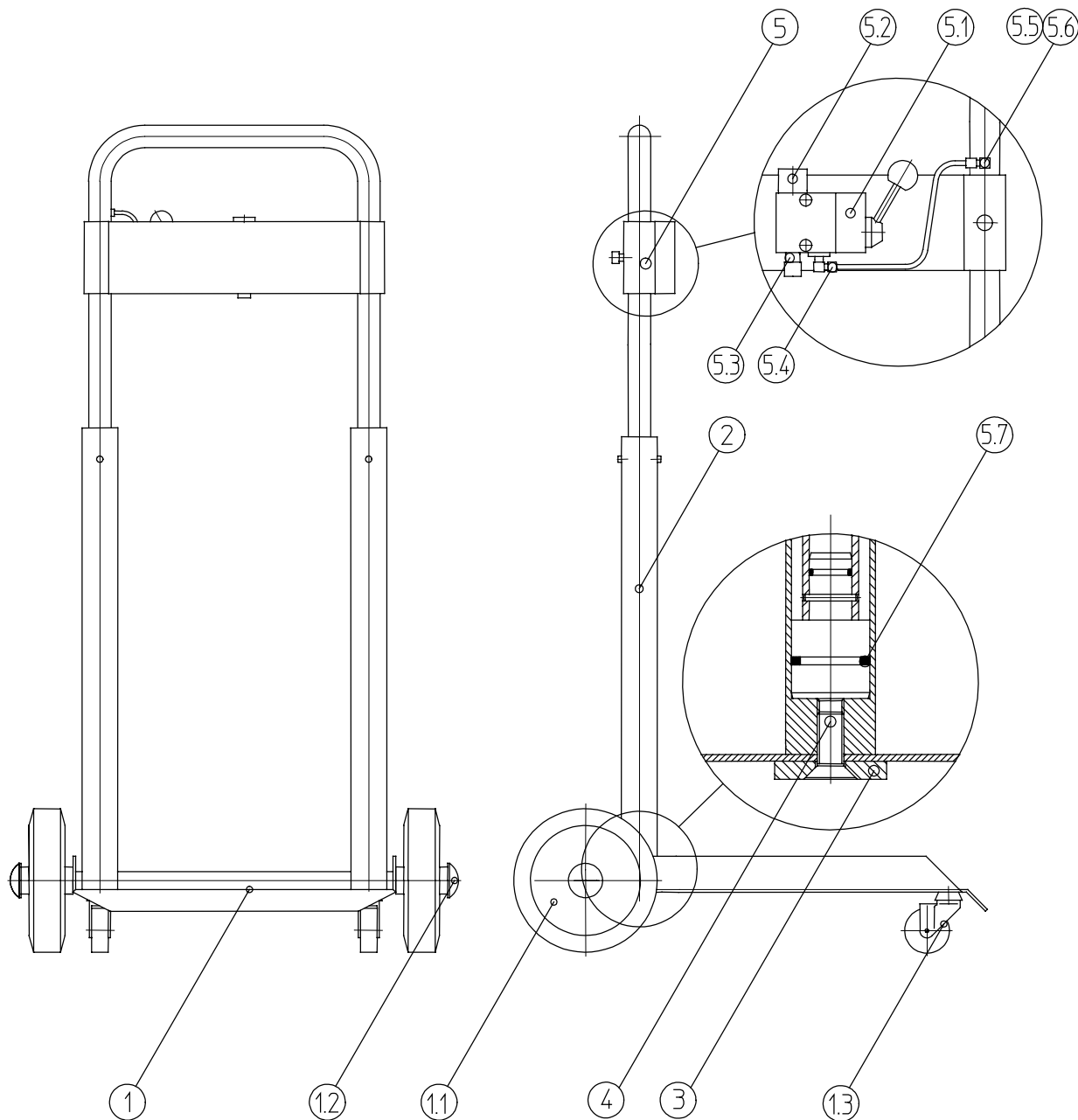

Note protection mark in accordance with DIN 34

Replacement for issue of 06.92

Subject to change

Prepared 07.12.99 Stengele	USER INFORMATION - LIST OF REPAIR PARTS -	Issued 12.99
Checked		B.17.05.07-E

PNEUMATIC ELEVATOR TROLLEY

Part nbr. 79717 012002

Pos.	Off	Part nbr.	Description
1	1	77708 004002	Trolley complete
		Wearing parts:	
1.1	2	75345 016001	Wheel D 160/58
1.2	2	75123 003027	Fixing washer D 20
1.3	2	75347 005001	Steering roller D 50
2	2	77576 047002	Cylinder tube complete 40 x 2.5 x 505
3	1	76824 029002	Plate 50 x 10 x 360
4	2	74020 063023	Countersunk screw M 12 x 30
5	1	77650 024003.	Pump support complete
		Wearing parts:	
5.1	1	75585 006001	Manual lever valve 3/2-way
5.2	1	75665 006003	Silencer G ¼
5.3	1	75201 001010	Plug G-R ¼
5.4	1	75202 001002	Plug W-G 1/8
5.5	1	75210 001002	Plug SW-M 5
5.6	1	75188 036006	Seal 5 x 7.5 x 1
5.7	1	75730 065028	Piston seal 35 x 27 x 3.25

GRACO STANDARD WARRANTY

Graco warrants all equipment referenced in this document which is manufactured by Graco and bearing its name to be free from defects in material and workmanship on the date of sale by an authorized Graco distributor to the original purchaser for use. With the exception of any special, extended, or limited warranty published by Graco, Graco will, for a period of twelve months from the date of sale, repair or replace any part of the equipment determined by Graco to be defective. This warranty applies only when the equipment is installed, operated and maintained in accordance with Graco's written recommendations.

This warranty does not cover, and Graco shall not be liable for general wear and tear, or any malfunction, damage or wear caused by faulty installation, misapplication, abrasion, corrosion, inadequate or improper maintenance, negligence, accident, tampering, or substitution of non-Graco component parts. Nor shall Graco be liable for malfunction, damage or wear caused by the incompatibility of Graco equipment with structures, accessories, equipment or materials not supplied by Graco, or improper design, manufacture, installation, operation or maintenance of structures, accessories, equipment or materials not supplied by Graco.

This warranty is conditioned upon the repaid return of equipment claimed to be defective to an authorized Graco distributor for verification of claimed defect. If the claimed defect is verified, Graco will repair or replace free of charge any defective parts. The equipment will be returned to the original purchaser transportation prepaid. If inspection of the equipment does not disclose any defect in material or workmanship, repairs will be made at a reasonable charge, which charges may include the costs of parts, labor, and transportation.

THIS WARRANTY IS EXCLUSIVE, AND IS IN LIEU OF ANY OTHER WARRANTIES, EXPRESS OR IMPLIED, INCLUDING BUT NOT LIMITED TO WARRANTY OF MERCHANTABILITY OR WARRANTY OF FITNESS FOR A PARTICULAR PURPOSE.

Graco's sole obligation and buyer's sole remedy for any breach of warranty shall be as set forth above. The buyer agrees that no other remedy (including, but not limited to, incidental or consequential damages for lost profits, lost sales, injury to person or property, or any other incidental or consequential loss) shall be available. Any action for breach of warranty must be brought within two (2) years of the date of sale.

Graco does not extend its warranty to accessories, appliances, materials or components which are sold by Graco but are not manufactured by Graco and makes no guarantee, however implied, with regard to the brand capability and suitability for a certain purpose. These parts sold by Graco but not manufactured by Graco (such as electric motors, switches, hoses, etc.) are covered by the warranties of the respective manufacturers. Graco will support the buyer in enforcing any warranty claim with the proviso that in no event can Graco be made liable for indirect, incidental, special or consequential damages which arise from the supply of appliances by Graco under the conditions governed by these provisions, or the supply, performance or use of any products or other goods which are sold under the conditions governed by these provisions, whether as the result of breach of contract, breach of warranty, negligence on the part of Graco or for any other reason.

GRACO N.V.

Industrieterrein "Oude Bunders"

Loc. 2206 - Slakweidestraat 31

3630 Maasmechelen – Belgium

Tel.: 32 89 770 700 Fax: 32 89 770

