

MECHANICAL LIFTING TROLLEY

Two-column lifting appliance operated manually in a mobile version for reciprocating and diaphragm pumps.

Part nbr. 79717 011002

DESCRIPTION

The lifting trolley essentially consists of the support area (base plate) ① for a container ②, the wheels ③ and the steering rollers ④ as well as the lifting appliance (guide tubes ⑤, tube stirrup ⑥ and height-adjustable pump support ④).

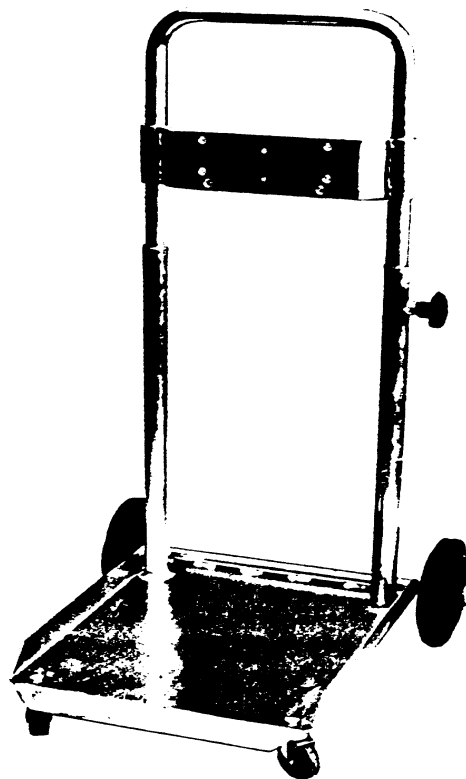

In order to change the container, the star grip screw ⑧ is used to fix the vertically movable tube stirrup (with pump support and pump ⑨) at the necessary height.

The base plate is designed for a 30 l container.

The wheels at the rear enable secure handling and make it possible to go up and down stairs.

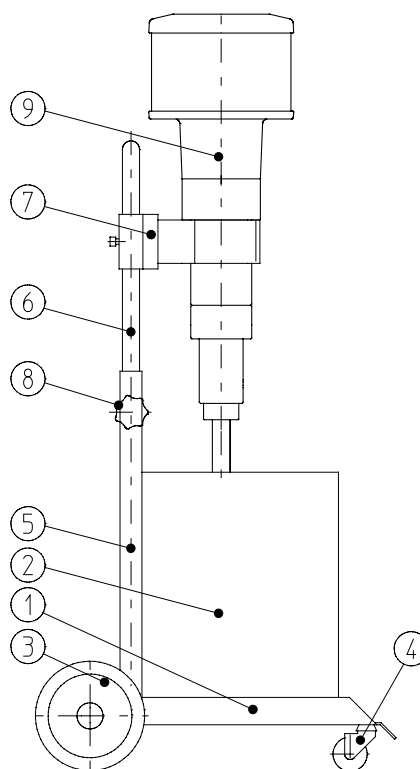

Replacement for issue of

Subject to change

Page 1 of 3

Prepared 07.12.99 Stengele

Checked 10.12.99 Kuhn

USER INFORMATION - TECHN. PRODUCT DESCRIPTION -

Issued 12.99

B.17.05.06-P

Technical data

Stroke	395	mm
Load carrying capacity approx.	40	kg
Weight	13.5	kg

CONSTRUCTION MATERIALS

Frame	Galvanized steel
Wheels	Plastic/non-conducting

Dimensions

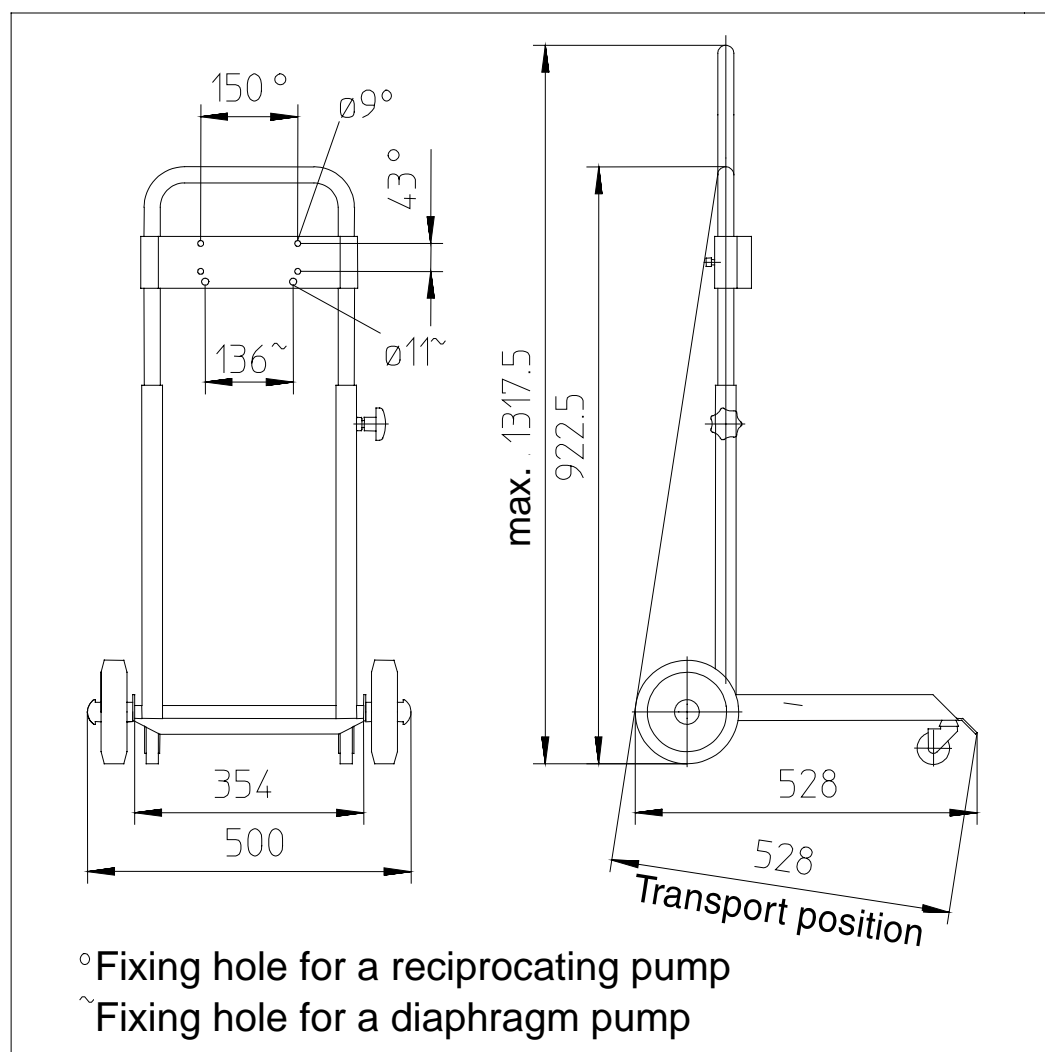

REMARKS

This technical product description also serves as operating instructions.

Documentation and directives to be complied with

- ZH/200 Richtlinien für die Vermeidung von Zündgefahren
 infolge elektrostatischer Aufladung
 Carl Heymanns Verlag KG., Köln
- VBG 23 Verarbeiten von Anstrichstoffen
 Hauptverband der gewerblichen Berufsgenossenschaften
 Carl Heymanns Verlag KG., Köln

Associated documentation

- | | |
|-----------------------------|--------------|
| List of repair parts | B.17.05.06-E |
| List of items in the figure | B.17.05.07-S |

GRACO N.V.
Industrieterrein "Oude Bunders"
Loc. 2206 - Slakweidestraat 31
3630 Maasmechelen - Belgium
Tel.: 32 89 770 700 Fax: 32 89 770

MECHANICAL LIFTING TROLLEY

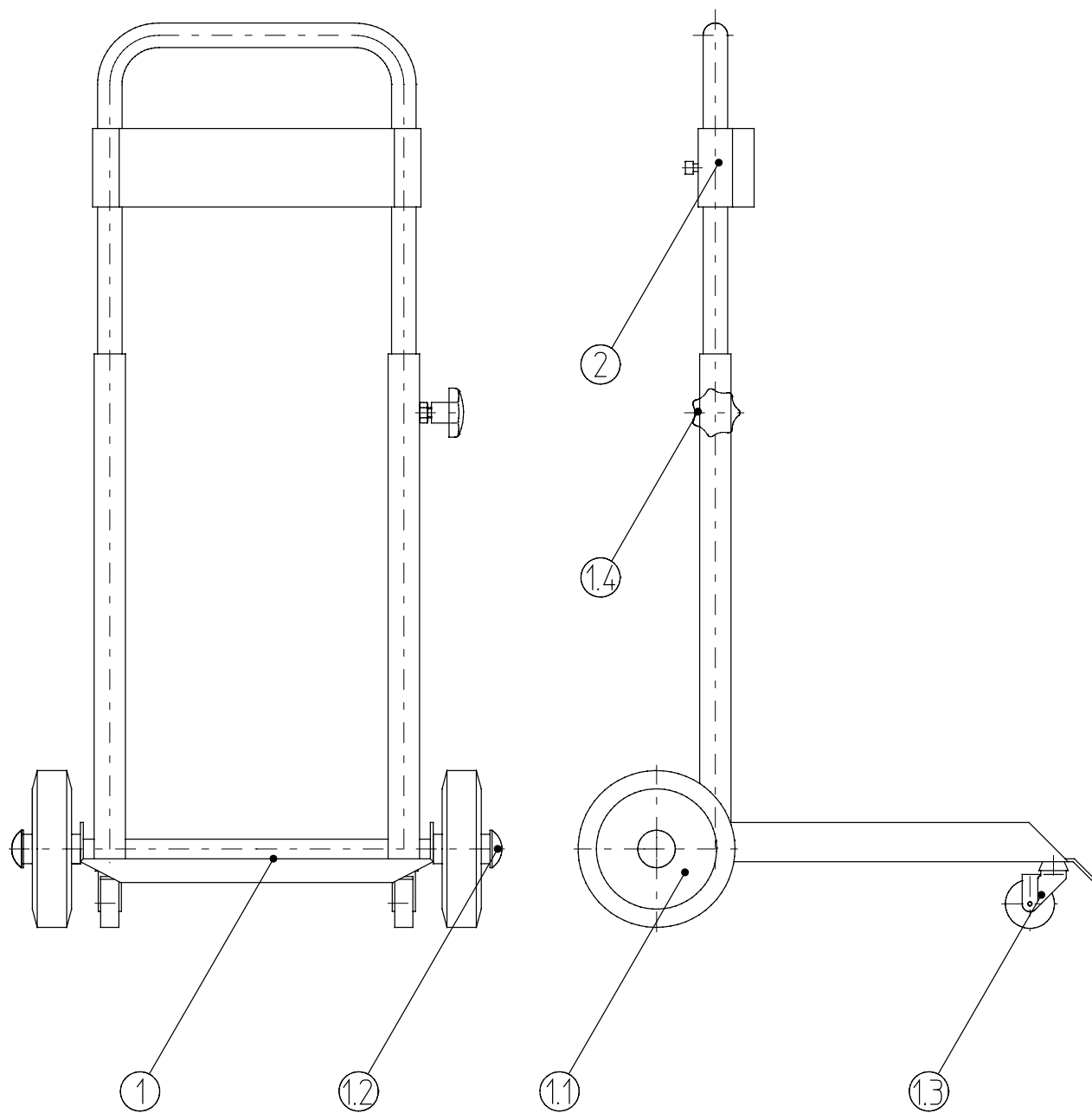

Note protection mark in accordance with DIN 34

Replacement for issue of 06.92

Subject to change		Page 1 of 2	
Prepared	07.12.99 Stengele	USER INFORMATION - LIST OF REPAIR PARTS -	
Checked			
		Issued	12.99
		B.17.05.06-E	

MECHANICAL LIFTING TROLLEY

Part nbr. 79717 011002

Pos	Off	Part nbr.	Description
1	1	77708 006002	Trolley complete.
		Wearing parts:	
1.1	2	75345 016001	Wheel D 160/58
1.2	2	75123 003027	Fixing washer D 20
1.3	2	75347 005001	Steering roller D 50
1.4	1	75027 005020	Star grip screw D 50 M 10 x 15
2	1	77650 024002	Pump support complete

GRACO STANDARD WARRANTY

Graco warrants all equipment referenced in this document which is manufactured by Graco and bearing its name to be free from defects in material and workmanship on the date of sale by an authorized Graco distributor to the original purchaser for use. With the exception of any special, extended, or limited warranty published by Graco, Graco will, for a period of twelve months from the date of sale, repair or replace any part of the equipment determined by Graco to be defective. This warranty applies only when the equipment is installed, operated and maintained in accordance with Graco's written recommendations.

This warranty does not cover, and Graco shall not be liable for general wear and tear, or any malfunction, damage or wear caused by faulty installation, misapplication, abrasion, corrosion, inadequate or improper maintenance, negligence, accident, tampering, or substitution of non-Graco component parts. Nor shall Graco be liable for malfunction, damage or wear caused by the incompatibility of Graco equipment with structures, accessories, equipment or materials not supplied by Graco, or improper design, manufacture, installation, operation or maintenance of structures, accessories, equipment or materials not supplied by Graco.

This warranty is conditioned upon the repaid return of equipment claimed to be defective to an authorized Graco distributor for verification of claimed defect. If the claimed defect is verified, Graco will repair or replace free of charge any defective parts. The equipment will be returned to the original purchaser transportation prepaid. If inspection of the equipment does not disclose any defect in material or workmanship, repairs will be made at a reasonable charge, which charges may include the costs of parts, labor, and transportation.

THIS WARRANTY IS EXCLUSIVE, AND IS IN LIEU OF ANY OTHER WARRANTIES, EXPRESS OR IMPLIED, INCLUDING BUT NOT LIMITED TO WARRANTY OF MERCHANTABILITY OR WARRANTY OF FITNESS FOR A PARTICULAR PURPOSE.

Graco's sole obligation and buyer's sole remedy for any breach of warranty shall be as set forth above. The buyer agrees that no other remedy (including, but not limited to, incidental or consequential damages for lost profits, lost sales, injury to person or property, or any other incidental or consequential loss) shall be available. Any action for breach of warranty must be brought within two (2) years of the date of sale.

Graco does not extend its warranty to accessories, appliances, materials or components which are sold by Graco but are not manufactured by Graco and makes no guarantee, however implied, with regard to the brand capability and suitability for a certain purpose. These parts sold by Graco but not manufactured by Graco (such as electric motors, switches, hoses, etc.) are covered by the warranties of the respective manufacturers. Graco will support the buyer in enforcing any warranty claim with the proviso that in no event can Graco be made liable for indirect, incidental, special or consequential damages which arise from the supply of appliances by Graco under the conditions governed by these provisions, or the supply, performance or use of any products or other goods which are sold under the conditions governed by these provisions, whether as the result of breach of contract, breach of warranty, negligence on the part of Graco or for any other reason.

GRACO N.V.

Industrieterrein "Oude Bunders"

Loc. 2206 - Slakweidestraat 31

3630 Maasmechelen – Belgium

Tel.: 32 89 770 700 Fax: 32 89 770

