

INSTRUCTIONS FOR INSTALLING THROAT PACKING KIT #241782 ON GRACO THERM-O-FLOW™ SYSTEMS WITH CHECK-MATE™ 800 PUMPS

For full details and safety information refer to pump service form # 308570 in your manual.

It will take approximately 30 - 45 minutes to change throat packings on warm Therm-O-Flow units if you follow these instructions. The only tools you will need are a large slip-joint pliers, a small slip-joint pliers and an adjustable wrench. **WEAR LEATHER GLOVES, PROTECTIVE SLEEVES AND EYE PROTECTION WHEN WORKING ON WARM UNIT!**

1. While the pump and follower plate are hot, raise the follower plate from the surface of the material, **but not out of the drum**. Open the pump bleed port or trigger the gun and pump as much adhesive out of the pump as possible. **Keep the bleed port open to be sure all pressure is relieved.**
2. If a lot of material has collected in the wet cup, clean it out so it does not restrict the shaft.
3. Disconnect the air motor from the pump connector rod using small slip-joint pliers and the adjustable wrench. Remove the coupler nut. **See Image A**
4. Retain the half-moon shaped shims from the coupler nut. These must be reinstalled when you reassemble the pump.
5. Jog the air motor to force the pump plunger into the down position, then slowly raise the air motor plunger rod. **Keep hands clear of the moving parts.** The plunger should disconnect from the air motor. Allow the air motor to reach the top of its stroke and shut off the air. **Lock off the air motor control ball valve.**
6. Remove the coupling nut/wet cup assembly with the large channel lock. Be sure that the o-ring seal on the bottom of the assembly comes out. Note: it may be necessary to loosen the top screws on the pump heat shroud to remove and install this assembly. **See Image B**
7. Remove the old packing assembly, clean off the shaft, wet cup and threaded area. Lubricate the shaft with lithium grease. **See Image C**

continued on next page...



A Wet cup nut is loose and coupling nut loosened and ready to be removed



B Removing wet cup assembly: Lift assembly, then tilt it to clean the pump shaft.



C Pump shaft threads are clean and the wet cup assembly is ready for reinstallation.

8. Install new packing kit no. 241782. If you have a series A pump that was built before May 1999, you will also need to replace the packing nut with part no. 237799. **See Illustration for Kit Components**
9. Reassemble the wet cup **See Image D** and reconnect the pump to the air motor plunger. **Keep hands clear of moving parts.** In order for the nut to catch the threads it may be necessary to raise the pump-lower shaft. Don't forget to reinstall the shims. Refill the wet cup with throat seal liquid. Lower the platen to the surface of the material, prime the pump and you are ready to go! **See Image E**

Important note: The tolerances on the Check-Mate™ pump are very tight to prevent leaking. If the assembly cools down too much, it will be too tight to reinstall on the shaft. Should this happen, re-warm the assembly in an oven, or by placing it on the warm platen for a while before attempting to reassemble the pump.

For further information, refer to service manual 308-570 or contact Graco Technical Assistance at 1-800-543-0339



D Reinstalling wet cup assembly



E Both nuts retightened. Fill wet cup with lubricant and re-start the pump.

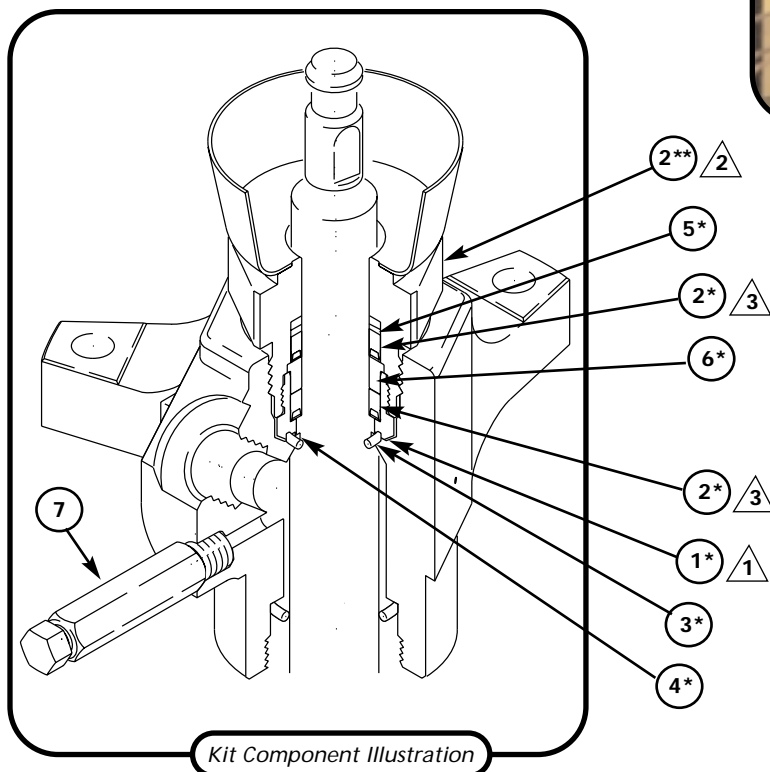

Kit Component Illustration

Kit Components Key

Item	Description
①	Retaining Nut
②	U-Cup
③	O-Ring
④	Lower Scraper
⑤	Medium Scraper
⑥	Large Scraper
⑦	Fluid Bleed Valve
①	Torque to 97-106 N.m (71-78 ft-lb)
②	Torque to 190-217 N.M (140-160 ft-lb)
③	Lips of u-cup packings must face down
*	Included in repair kit 241782
**	237799 wet cup housing needed to convert series A pumps (pre 6/99) to use repair kit 241782



GRACO INC.
P.O. Box 1441
Minneapolis, MN 55440-1441
©2000 Form No. 314-934