

Control Board Replacement Kit

312188 rev.A

SR7 and ProX7 Control Board Replacement Kit: 288705
ProX9 Control Board Replacement Kit: 288900



Important Safety Instructions

Read all warnings and instructions in this manual. Save these instructions. For detailed sprayer information and warnings, see your Operation manual.



To reduce the risk of fluid injection or splashing in the eyes or on the skin, relieve all fluid pressure in system before you install, remove, or replace any parts. See the **Pressure Relief Procedure** provided in your Operating Instruction manual.

Disassembly

1. Unplug electrical cord and **relieve pressure**.
2. Remove enclosure mounting screws (A). Pull enclosure (B) away from drive housing (C). Take care to not pull on the leads from the electrical cord and the power switch.
3. Disconnect motor harness (D), electrical cord and power switch lead from control board (E). (Also see wiring diagram for your sprayer model.)
4. Remove screw (F) that mounts control board (E) and pull control board approximately 2 in. (50 mm) back from drive housing (C).
5. Disconnect pressure control and AutoPrime® wiring harnesses from connectors (G) on front of control board (E). Using a fingernail or flat blade screwdriver, press tab on right side of connector to release.

Installation

1. Connect pressure control and AutoPrime wiring harnesses to new control board connector (G).
2. Install new control board (E) on drive housing (C) and tighten control board mounting screw (F).
3. Connect power switch, electrical cord leads and motor harness (D) to control board (E). (Also see wiring diagram for your sprayer model.)
4. Replace enclosure (B) and tighten enclosure mounting screws (A). When reassembling enclosure, take care not to pinch leads.

PROVEN QUALITY. LEADING TECHNOLOGY.



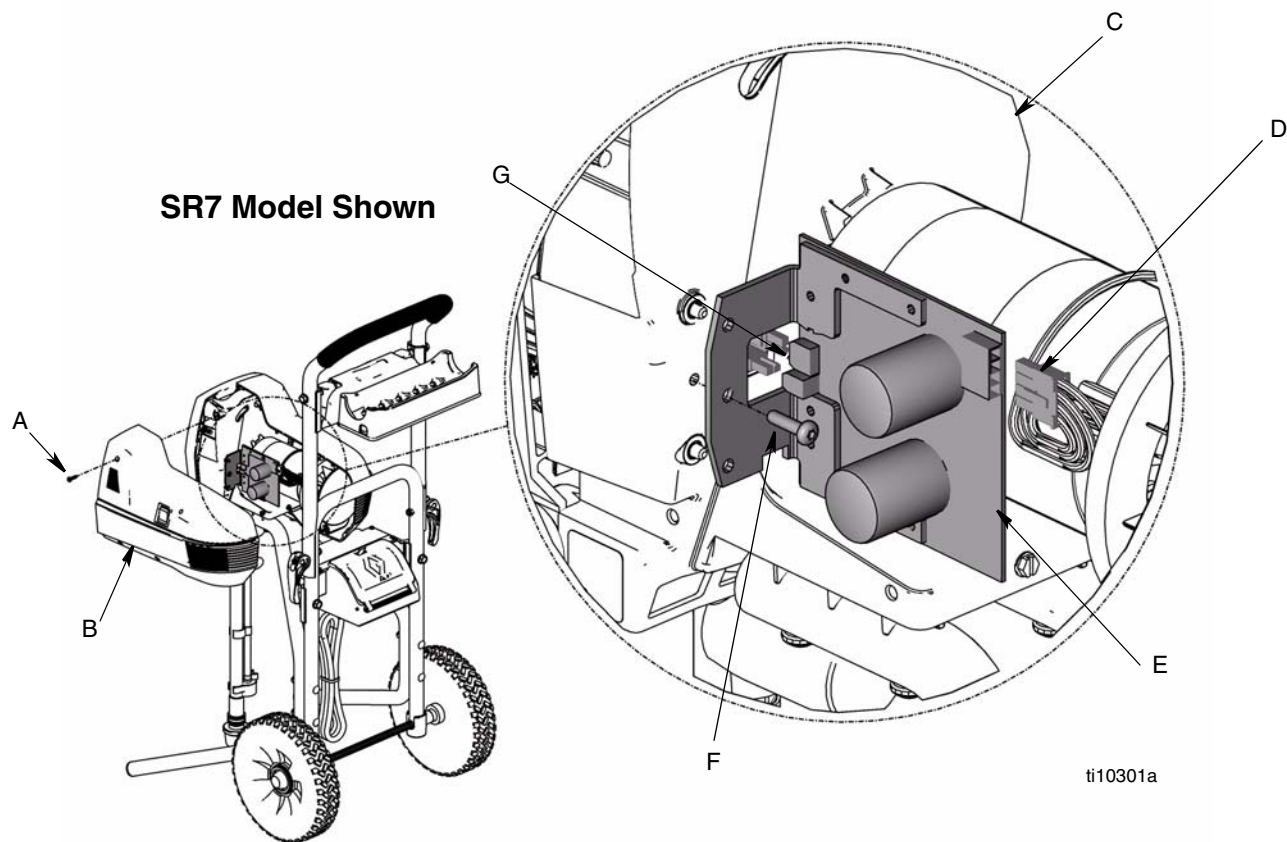

SR7 Model Wiring Diagram

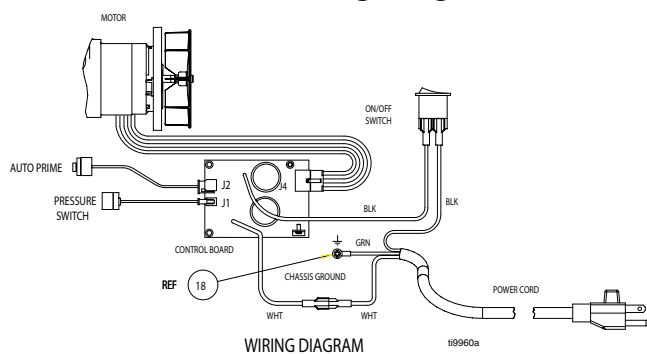

ProX Models Wiring Diagram

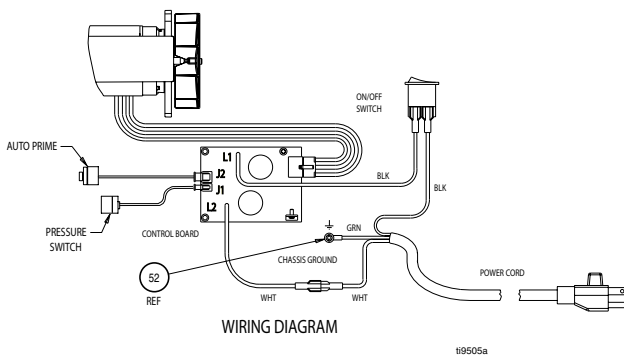

All written and visual data contained in this document reflect the latest product information available at the time of publication.
Graco reserves the right to make changes at any time without notice.

Graco Headquarters: Minneapolis
International Offices: Belgium, China, Japan, Korea
GRACO INC. P.O. BOX 1441 MINNEAPOLIS, MN 55440-1441
www.graco.com
 5/2007