

Repair

Accessory Hopper Kit for:

Ultra 395/495/595™; Ultra Max II 490/495/595™

Ultimate Nova 395™; Ultimate MX II 490/495/595™

Ultimate SuperNova 495/595™

ST Max 395/495/595™; ST Max II 490/495/595™

Performance Max 395/495/595™; 390™

FinishPro™ 390/395



312184 rev. A



Important Safety Instructions

Read all warnings and instructions in related instruction/operation manual. Save these instructions.

Use with Hi-Boy and Lo-Boy models

288526, Series A

Pressure Relief Procedure



INJECTION HAZARD

System pressure must be manually relieved to prevent system from starting or spraying accidentally. Fluid under high pressure can be injected through skin and cause serious injury. To reduce risk of injury from injection, splashing fluid, or moving parts, follow Pressure Relief Procedure whenever you:

- are instructed to relieve pressure,
- stop spraying,
- check or service any system equipment,
- or install or clean spray tip.

1. Lock gun safety latch.
2. Turn ON/OFF switch to OFF
3. Unplug power supply cord.
4. Unlock gun safety latch. Hold metal part of gun firmly to grounded metal pail. Trigger gun to relieve pressure.
5. Lock gun safety latch.
6. Open pressure drain valve. Leave pressure drain valve open until ready to spray again.

If suspected that spray tip or hose is completely clogged, or that pressure has not been fully relieved after following steps above, VERY SLOWLY loosen tip guard retaining nut or hose end coupling to relieve pressure gradually, then loosen completely. Now clear tip or hose obstruction.

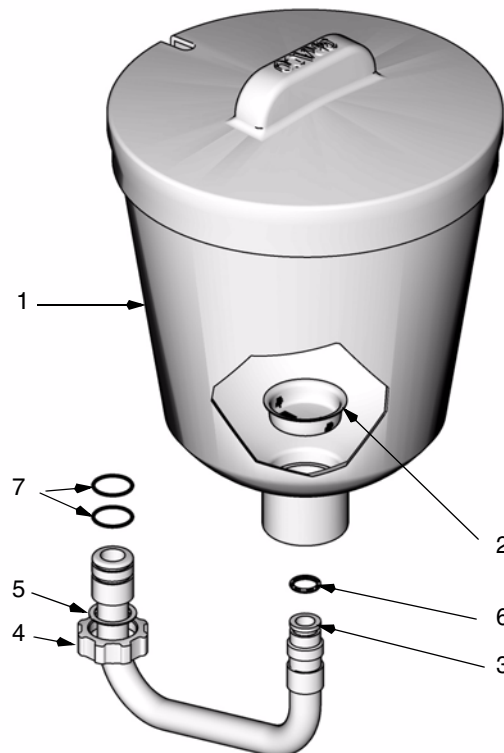

Ref	Part	Description	Qty
1	188787	HOPPER, 1.5 GALLON	1
2	112133	SCREEN, HOPPER	1
3	287049	TUBE, INLET, HOPPER	1
4	15E813	NUT, JAM	1
5	15B652	WASHER, SUCTION	1
6	104938	PACKING, O-RING	1
7	117559	O-RING	2

1. Follow **Pressure Relief Procedure**.

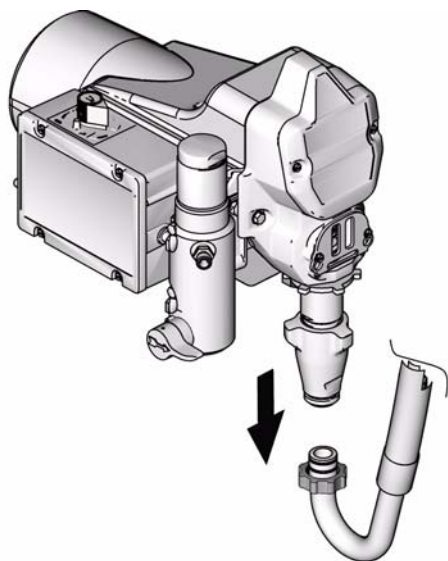

2. Remove suction set.

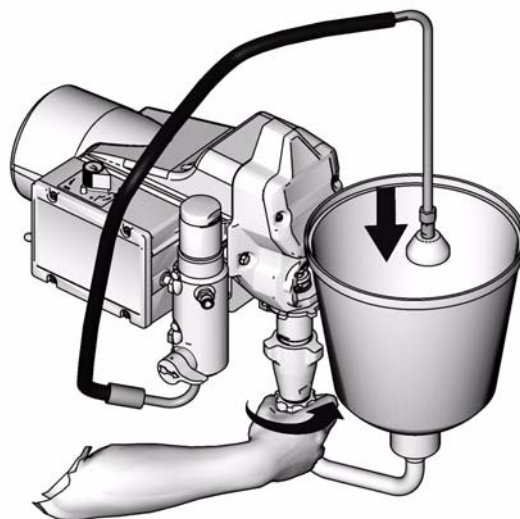

4. Hand-tighten jam nut. Place drain tube into hopper.

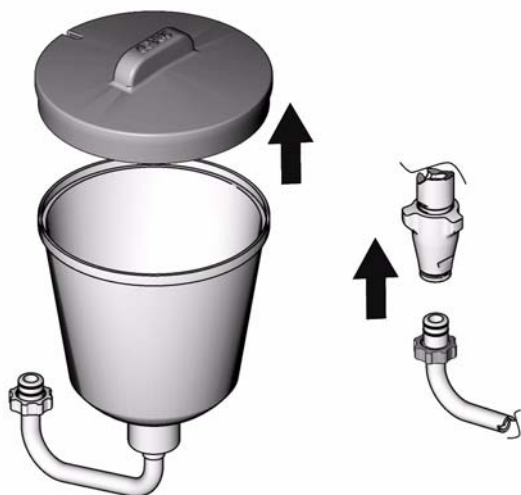

3. Remove hopper lid. Insert hopper tube into pump.

All written and visual data contained in this document reflects the latest product information available at the time of publication.
Graco reserves the right to make changes at any time without notice.

This manual contains English. MM 312184

Graco Headquarters: Minneapolis

International Offices: Belgium, China, Japan, Korea

GRACO INC. P.O. BOX 1441 MINNEAPOLIS, MN 55440-1441

www.graco.com

312184A, 3/2007