

Air Motor Bottom Plate Kit

311966 rev.A

To replace air motor bottom plate on Reactor A-20 Proportioner.



Important Safety Instructions

Read all warnings and instructions in manual 311512. Save those instructions.

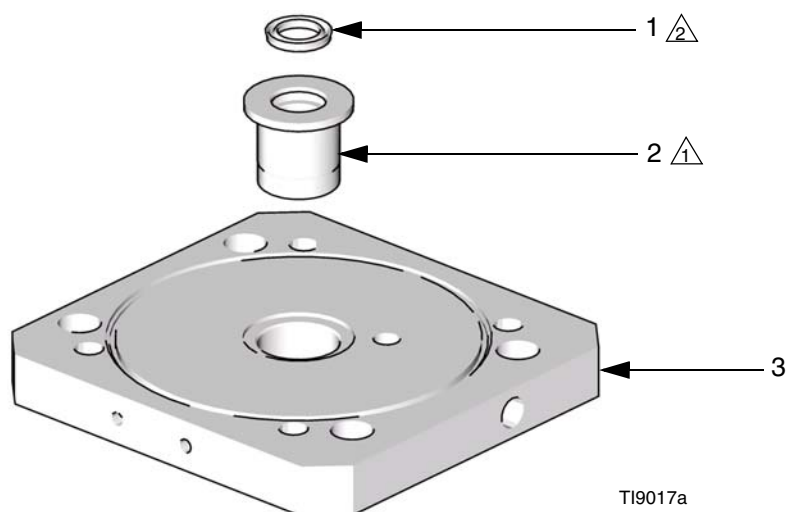

1 Press fit bushing with flange bottomed against counterbore step.

2 Install seal into internal groove of bushing with vee facing flange end.

Note: See manual 311512 for installation and lubrication instructions.

Parts included with kit 288340:

Ref.	Part	Description	Qty.
1	120554	SEAL, u-cup, bevel lip	1
2	15J149	BUSHING, rod, air motor	1
3	15J587	PLATE, cylinder, air, bottom	1

PROVEN QUALITY. LEADING TECHNOLOGY.

*All written and visual data contained in this document reflects the latest product information available at the time of publication.
Graco reserves the right to make changes at any time without notice.*

MM 311966

Graco Headquarters: Minneapolis

International Offices: Belgium, China, Japan, Korea

GRACO INC. P.O. BOX 1441 MINNEAPOLIS, MN 55440-1441

www.graco.com

12/2006