

Pump Mounting Kits

311619 rev.A

Mounting kits for pumps powered by NXT air motors.



Important Safety Instructions

Read all warnings and instructions in your separate pump manual. Save these instructions.

255143 Wall Mounting Kit

Ref. No.	Part No.	Description	Qty.
7		BRACKET, mounting	1
8	100101	SCREW, cap, hex hd	4
9	100133	WASHER, lock	4

1. Select a solid position on a wall for the mounting bracket (7). Be sure the wall is capable of supporting the pump and accessories that will be attached to the bracket, any additional weight of fluid used in the pump, and any stress or strain that may be applied during pump operation.

 Approximate weights of the pump and accessories are 82-150 lb (37-67 kg).

2. Drill four 7/16 in. (11 mm) diameter holes for the mounting bolts, approximately 5 ft (1.5 m) above the floor, using the wall bracket as a template. Use any of the three mounting hole groupings (see **Mounting Hole Diagram**, page 3).
3. Bolt the bracket securely to the wall. Use bolts designed to hold in the wall's construction.
4. Place the pump and accessories over the bracket's mounting holes and secure with screws (8) and washers (9) supplied.

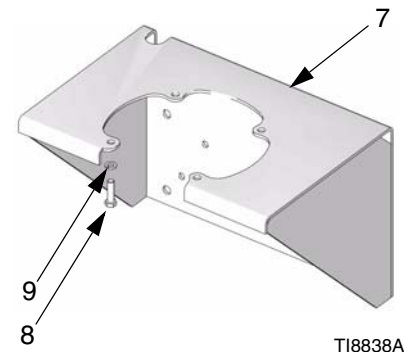

 Adapter plate 247312 is required to mount an NXT 2200 air motor to the bracket. Order separately.

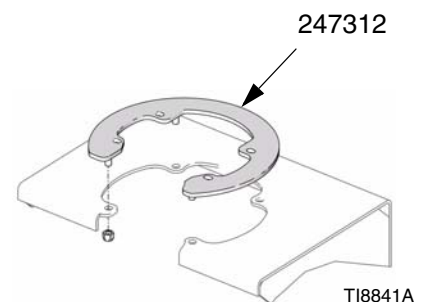

PROVEN QUALITY. LEADING TECHNOLOGY.

253692 Floor Stand

 Adapter plate 247312 is required to mount an NXT 2200 air motor to the floor stand.

1. Assemble the stand as shown in the parts drawing.

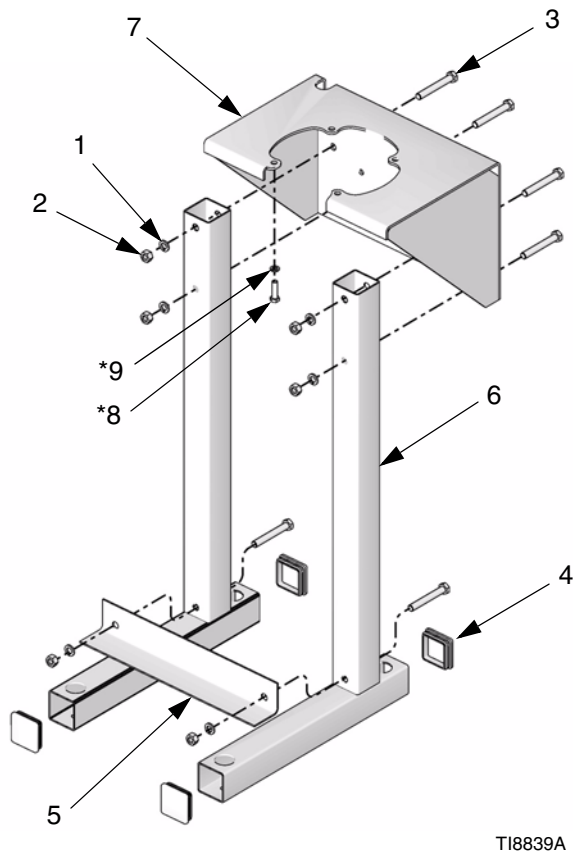

2. Secure the stand to the floor. The bolts should extend about 6 in. (152 mm) into the concrete floor to prevent the pump from tipping.
3. Use a hoist or elevator to lower the pump into the stand. Secure the pump to the stand.

 Adapter plate 247312 is required to mount an NXT 2200 air motor to the bracket. Order separately.

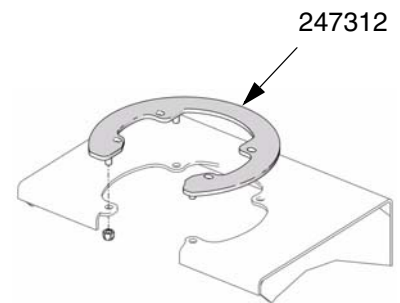

TI8841A

Ref. No.	Part No.	Description	Qty.
1	100018	WASHER, lock	6
2	100321	NUT	6
3	100679	SCREW, cap, hex hd	6
4	120486	CAP, plug	4
5	15H893	FRAME	1
6	253691	LEG	2
7	255143	MOUNTING KIT (includes items 8 and 9, see page 1)	1
8*	100101	SCREW, cap, hex hd	4
9*	100133	WASHER, lock	4

* Included in 255143 Mounting Kit.

Mounting Hole Diagram

 Bracket 253679 has three sets of four holes. The inner set of holes matches an existing hole pattern used for a President wall bracket. The outer set is for mounting the bracket to the floor stand. The middle set matches existing Graco wall mounts.

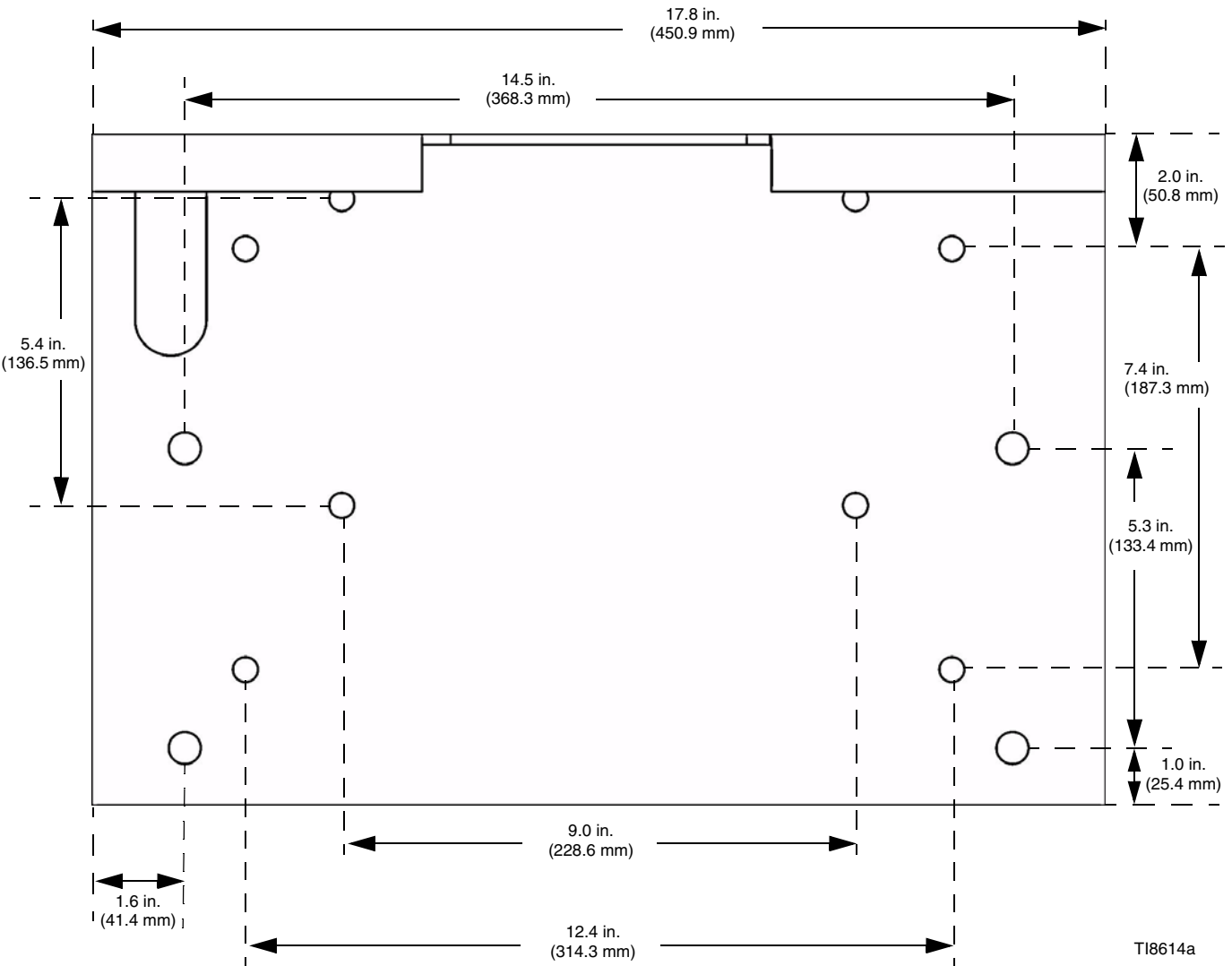

*All written and visual data contained in this document reflects the latest product information available at the time of publication.
Graco reserves the right to make changes at any time without notice.*

MM 311619

Graco Headquarters: Minneapolis

International Offices: Belgium, China, Japan, Korea

GRACO INC. P.O. BOX 1441 MINNEAPOLIS, MN 55440-1441

www.graco.com

11/2006