

# Motor Coupler Kits

311605 rev.A

To install electric motors on E-Flo™ Plus Electric Circulation Pumps.

## 15H880 Motor Coupler Kit

For NEMA 184TC Frame Electric Motors

## 15J893 Motor Coupler Kit

For IEC 112M/B5 Frame Electric Motors

## 15J827 Motor Coupler Removal Tool



### Important Safety Instructions

Read all warnings and instructions in this manual  
and in E-Flo Plus Repair-Parts manual 311594.  
Save these instructions.

### 15H880 Kit for NEMA 184TC Frame Motor

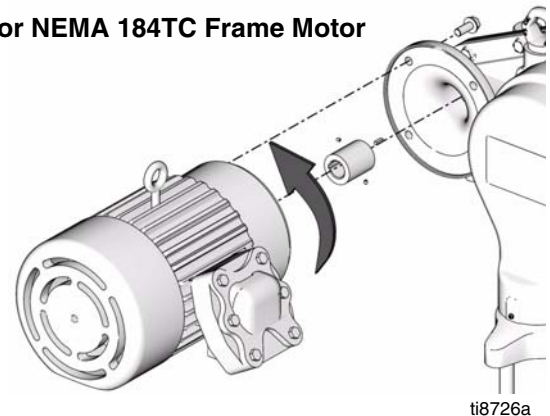

ti8726a

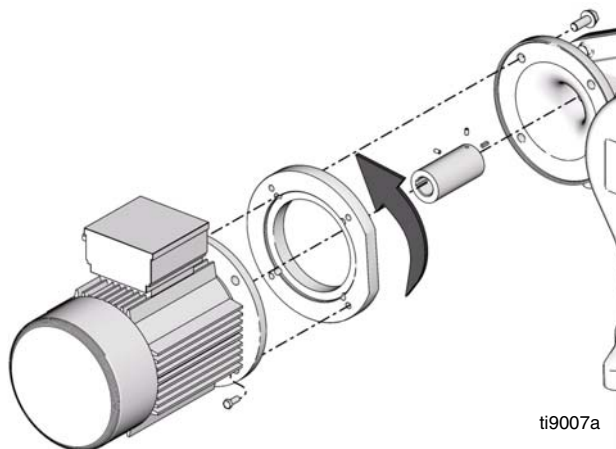

### 15J893 Kit for IEC 112M/B5 Frame Motor



ti9007a

PROVEN QUALITY. LEADING TECHNOLOGY.

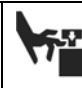
# Pressure Relief Procedure



System pressure can cause the pump to cycle unexpectedly, which could result in serious injury from splashing or moving parts.

1. Set START/STOP switch to STOP.
2. Push in SECURE DISABLE switch.
3. Open the back pressure regulator and all fluid drain valves in the system, having a waste container ready to catch drainage. Leave open until you are ready to pressurize system again.
4. Check that pressure gauges on fluid supply and return lines read zero. If gauges do not read zero, determine cause and carefully relieve pressure by VERY SLOWLY loosening a fitting. Clear obstruction before pressurizing system again.

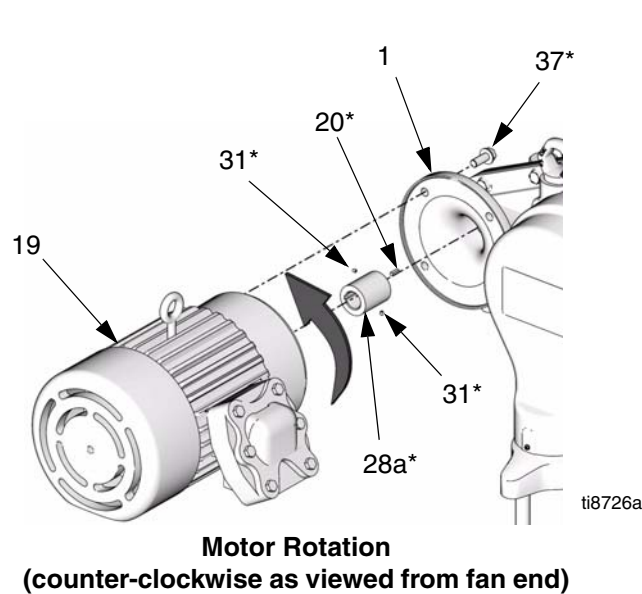



FIG. 1. NEMA 184 TC Frame Electric Motors

# Kit Parts

-  Motor Coupler Kit 15H880 includes parts to install a NEMA 184 TC Frame electric motor on the E-Flo Plus Pump. Parts included in the kit are marked with an asterisk, for example (20\*). Use all the new parts in the kit. See FIG. 1.
- Motor Coupler Kit 15J893 includes parts to install an IEC 112M/B5 Frame electric motor on the E-Flo Plus Pump. Parts included in the kit are marked with an asterisk, for example (20\*). Use all the new parts in the kit. See FIG. 2.

Ref. No.	Part No.	Description	Qty
20*	120376	KEY, square	1
28a*	n/a	MOTOR COUPLER; for kit 15H880 only	1
28b*	n/a	MOTOR COUPLER; for kit 15J893 only	1
31*	100664	SCREW, set, socket-head; 1/4-20 x 1/2 in. (13 mm)	2
37*	111195	SCREW, cap, flange-head; 1/2-13 x 1.25 in. (31 mm)	4
59*	105324	SCREW, cap, hex-head; M12 x 1.75 x 30 mm; for kit 15J893 only	4
60*	15J892	PLATE, adapter; for kit 15J893 only	1

Parts designated n/a are not available separately.

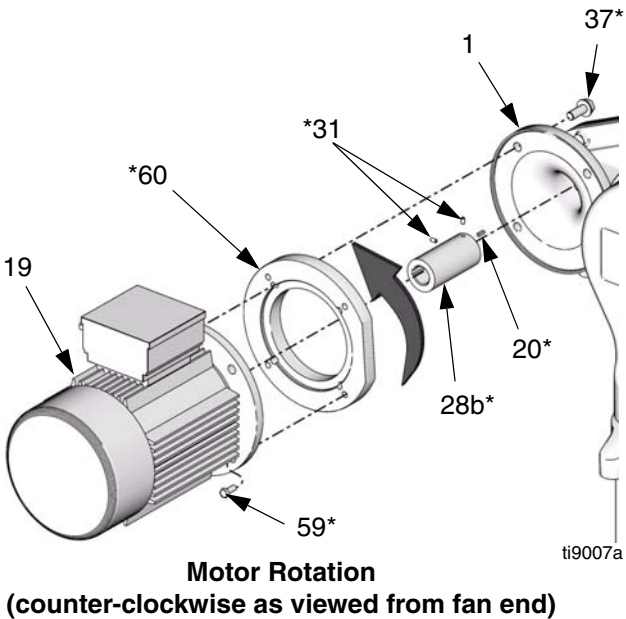
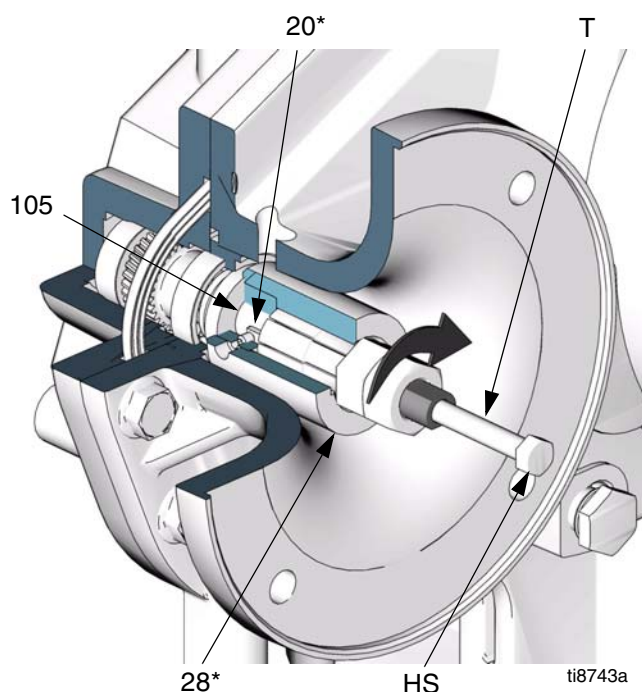

FIG. 2. IEC 112M/B5 Frame Electric Motors

# Coupler Removal



1. Relieve pressure, page 2.
2. Shut off electrical power to the unit.
3. See FIG. 1 for NEMA 184 TC Frame electric motors. See FIG. 2 for IEC 112M/B5 Frame electric motors. While one person supports the motor (19), remove the screws (37\*). Pull the motor away from the gear reducer.
4. See FIG. 3. Loosen both setscrews (31). Insert the coupler removal tool (T) into the coupler (28). Turn nut clockwise until tight, then pull the coupler off the gear reducer input shaft (105) by turning hex-head screw (HS) clockwise.



**FIG. 3. Motor Coupler Removal**

# Installation

1. See FIG. 4. Assemble the key (20\*) and two setscrews (31\*) in the coupler (28\*). Slide the coupler into the gear reducer so the key mates with the input shaft (105). Slide on until coupler and key bottom. Tighten setscrews to 66-78 in-lb (7.5-8.8 N•m). Apply antiseize lubricant to bore of coupling.

 When installing an IEC 112M/B5 Frame electric motor, ensure that the motor adapter (60\*) and screws (59\*) are in place before mounting the motor on the gear reducer. See FIG. 2.

## CAUTION

If installing an IEC 112M/B5 Frame electric motor which is not supplied by Graco, ensure that the motor shaft key cannot move out of position. If the key works loose it could cause excessive heat and equipment damage.

2. Lift the motor (19) into position. Align the key on the motor shaft with the mating slot of the motor coupler, and the four mounting holes with the holes in the gear reducer (1). Slide the motor into place.
3. While one person supports the motor (19), install the screws (37\*). Tighten securely.

 Apply antiseize lubricant to bore of coupling (28).

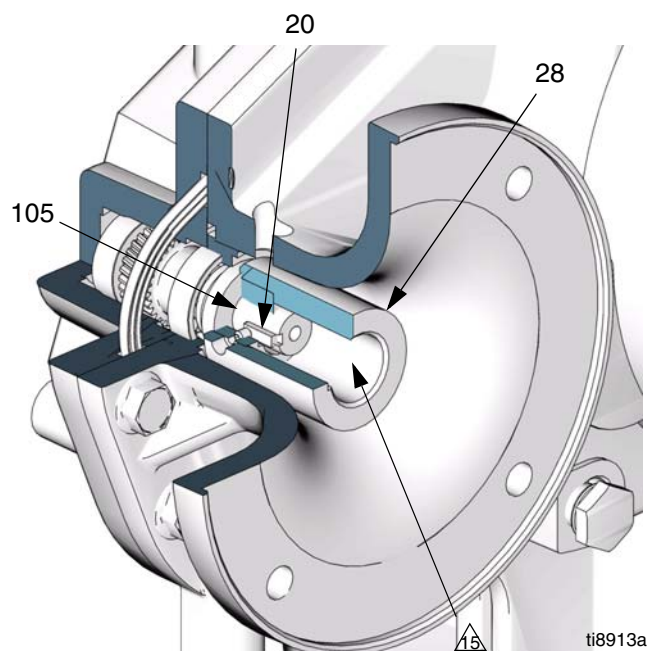

**FIG. 4. Motor Coupler Installation**

# Graco Standard Warranty

Graco warrants all equipment referenced in this document which is manufactured by Graco and bearing its name to be free from defects in material and workmanship on the date of sale to the original purchaser for use. With the exception of any special, extended, or limited warranty published by Graco, Graco will, for a period of twelve months from the date of sale, repair or replace any part of the equipment determined by Graco to be defective. This warranty applies only when the equipment is installed, operated and maintained in accordance with Graco's written recommendations.

This warranty does not cover, and Graco shall not be liable for general wear and tear, or any malfunction, damage or wear caused by faulty installation, misapplication, abrasion, corrosion, inadequate or improper maintenance, negligence, accident, tampering, or substitution of non-Graco component parts. Nor shall Graco be liable for malfunction, damage or wear caused by the incompatibility of Graco equipment with structures, accessories, equipment or materials not supplied by Graco, or the improper design, manufacture, installation, operation or maintenance of structures, accessories, equipment or materials not supplied by Graco.

This warranty is conditioned upon the prepaid return of the equipment claimed to be defective to an authorized Graco distributor for verification of the claimed defect. If the claimed defect is verified, Graco will repair or replace free of charge any defective parts. The equipment will be returned to the original purchaser transportation prepaid. If inspection of the equipment does not disclose any defect in material or workmanship, repairs will be made at a reasonable charge, which charges may include the costs of parts, labor, and transportation.

**THIS WARRANTY IS EXCLUSIVE, AND IS IN LIEU OF ANY OTHER WARRANTIES, EXPRESS OR IMPLIED, INCLUDING BUT NOT LIMITED TO WARRANTY OF MERCHANTABILITY OR WARRANTY OF FITNESS FOR A PARTICULAR PURPOSE.**

Graco's sole obligation and buyer's sole remedy for any breach of warranty shall be as set forth above. The buyer agrees that no other remedy (including, but not limited to, incidental or consequential damages for lost profits, lost sales, injury to person or property, or any other incidental or consequential loss) shall be available. Any action for breach of warranty must be brought within two (2) years of the date of sale.

**GRACO MAKES NO WARRANTY, AND DISCLAIMS ALL IMPLIED WARRANTIES OF MERCHANTABILITY AND FITNESS FOR A PARTICULAR PURPOSE, IN CONNECTION WITH ACCESSORIES, EQUIPMENT, MATERIALS OR COMPONENTS SOLD BUT NOT MANUFACTURED BY GRACO.** These items sold, but not manufactured by Graco (such as electric motors, switches, hose, etc.), are subject to the warranty, if any, of their manufacturer. Graco will provide purchaser with reasonable assistance in making any claim for breach of these warranties.

In no event will Graco be liable for indirect, incidental, special or consequential damages resulting from Graco supplying equipment hereunder, or the furnishing, performance, or use of any products or other goods sold hereto, whether due to a breach of contract, breach of warranty, the negligence of Graco, or otherwise.

## **FOR GRACO CANADA CUSTOMERS**

The Parties acknowledge that they have required that the present document, as well as all documents, notices and legal proceedings entered into, given or instituted pursuant hereto or relating directly or indirectly hereto, be drawn up in English. Les parties reconnaissent avoir convenu que la rédaction du présent document sera en Anglais, ainsi que tous documents, avis et procédures judiciaires exécutés, donnés ou intentés, à la suite de ou en rapport, directement ou indirectement, avec les procédures concernées.

# Graco Information

**TO PLACE AN ORDER,** contact your Graco distributor or call to identify the nearest distributor.

**Phone:** 612-623-6921 **or Toll Free:** 1-800-328-0211 **Fax:** 612-378-3505

*All written and visual data contained in this document reflects the latest product information available at the time of publication.  
Graco reserves the right to make changes at any time without notice.*

MM 311605

**Graco Headquarters:** Minneapolis

**International Offices:** Belgium, China, Japan, Korea

**GRACO INC. P.O. BOX 1441 MINNEAPOLIS, MN 55440-1441**

[www.graco.com](http://www.graco.com)

1/2007