

Piston Hand Pump

311308 rev.B

Model 260407

For petroleum products and other fluids compatible with aluminum and buna-N seals.

Model 260406

For herbicides and other chemicals or fluids compatible with fluoroelastomer seals, aluminum, and EPDM.



Important Safety Instructions

Read all warnings and instructions in this manual.
Save these instructions.

Contents





Warnings	2
Installation	3
Operation	3
Maintenance	3
Flushing pump	3
Parts	4
Technical Data	5
Graco Standard Warranty	6
Graco Information	6



PROVEN QUALITY. LEADING TECHNOLOGY.

Warnings

The following general warnings are for the setup, use, grounding, maintenance, and repair of this equipment. Additional, more specific warnings may be found throughout the body of this manual where applicable. *Symbols appearing in the body of the manual refer to these general warnings. When these symbols appear throughout the manual, refer back to these pages for a description of the specific hazard.*

 WARNING	
	<p>FIRE AND EXPLOSION HAZARD</p> <p>When flammable fluids are present in the work area, such as gasoline and windshield wiper fluid, be aware that flammable fumes can ignite or explode. To help prevent fire and explosion:</p> <ul style="list-style-type: none"> • Use equipment only in well ventilated area. • Eliminate all ignition sources, such as cigarettes and portable electric lamps. • Keep work area free of debris, including rags and spilled or open containers of solvent and gasoline. • Do not plug or unplug power cords or turn lights on or off when flammable fumes are present. • Ground all equipment in the work area. • Use only grounded hoses. • If there is static sparking or you feel a shock, stop operation immediately. Do not use equipment until you identify and correct the problem. • Keep a fire extinguisher in the work area.
	<p>PERSONAL PROTECTIVE EQUIPMENT</p> <p>You must wear appropriate protective equipment when operating, servicing, or when in the operating area of the equipment to help protect you from serious injury, including eye injury, inhalation of toxic fumes, burns, and hearing loss. This equipment includes but is not limited to:</p> <ul style="list-style-type: none"> • Protective eyewear • Clothing and respirator as recommended by the fluid and solvent manufacturer • Gloves • Hearing protection
	<p>EQUIPMENT MISUSE HAZARD</p> <p>Misuse can cause death or serious injury.</p> <ul style="list-style-type: none"> • Do not operate the unit when fatigued or under the influence of drugs or alcohol. • Do not exceed the maximum working pressure or temperature rating of the lowest rated system component. See Technical Data in all equipment manuals. • Use fluids and solvents that are compatible with equipment wetted parts. See Technical Data in all equipment manuals. Read fluid and solvent manufacturer's warnings. For complete information about your material, request MSDS forms from distributor or retailer. • Check equipment daily. Repair or replace worn or damaged parts immediately with genuine Graco replacement parts only. • Do not alter or modify equipment. • Use equipment only for its intended purpose. Call your Graco distributor for information. • Route hoses and cables away from traffic areas, sharp edges, moving parts, and hot surfaces. • Do not kink or over bend hoses or use hoses to pull equipment. • Keep children and animals away from work area. • Comply with all applicable safety regulations.

Installation



Use chemical or petroleum compatible sealant on standpipe threads before assembling into pump inlet port. Failure to seal threads will cause difficulty in priming. See **Parts**, page 4.

1. Determine correct length of standpipe.
2. Install bung adapter (19) into tank. Insert threaded end of standpipe into tank through bung adapter (19) until threaded end of pipe rests on bottom of tank.
3. Mark length of standpipe at top of bung adapter (19).
4. Remove standpipe and cut pipe 1 in. (25.4 mm) shorter than marked length.
5. Tighten bung adapter (19) into tank. Insert standpipe through bung adapter and position pump in desired position for convenient operation. Tighten two locking screws (24).
6. Apply sealant to both ends of hose. Assemble hose to pump and assemble nozzle to other end of hose.

Operation

CAUTION

For Model 260406, all fluids pumped must be compatible with fluoroelastomer, aluminum, and EPDM.

For Model 260407, all fluids pumped must be compatible with aluminum and buna-N.

1. Insert nozzle into container being filled. Cycle handle to pump fluid.
2. Always stow nozzle in nozzle holder to prevent contamination from entering hose and nozzle.
3. If pump fails to prime, remove plug on pump outlet and pour 8 oz (0.24 liter) of compatible fluid into the pump.

Maintenance

Flushing pump

Proper flushing of pump after use with herbicides and chemicals is essential for long service life. Many herbicides dry quickly and will make pump inoperative if allowed to dry inside pump.

CAUTION

For Model 260406, all fluids pumped must be compatible with fluoroelastomer, aluminum, and EPDM.

For Model 260407, all fluids pumped must be compatible aluminum and buna-N.

1. Remove pump from tank and insert suction pipe into water or chemical agent recommended by chemical manufacturer.
2. Operate pump until fluid discharge is free of chemical.
3. For extended storage after use with herbicide or chemical, flush pump, and fill with diesel fuel.

Parts

260407, 260406

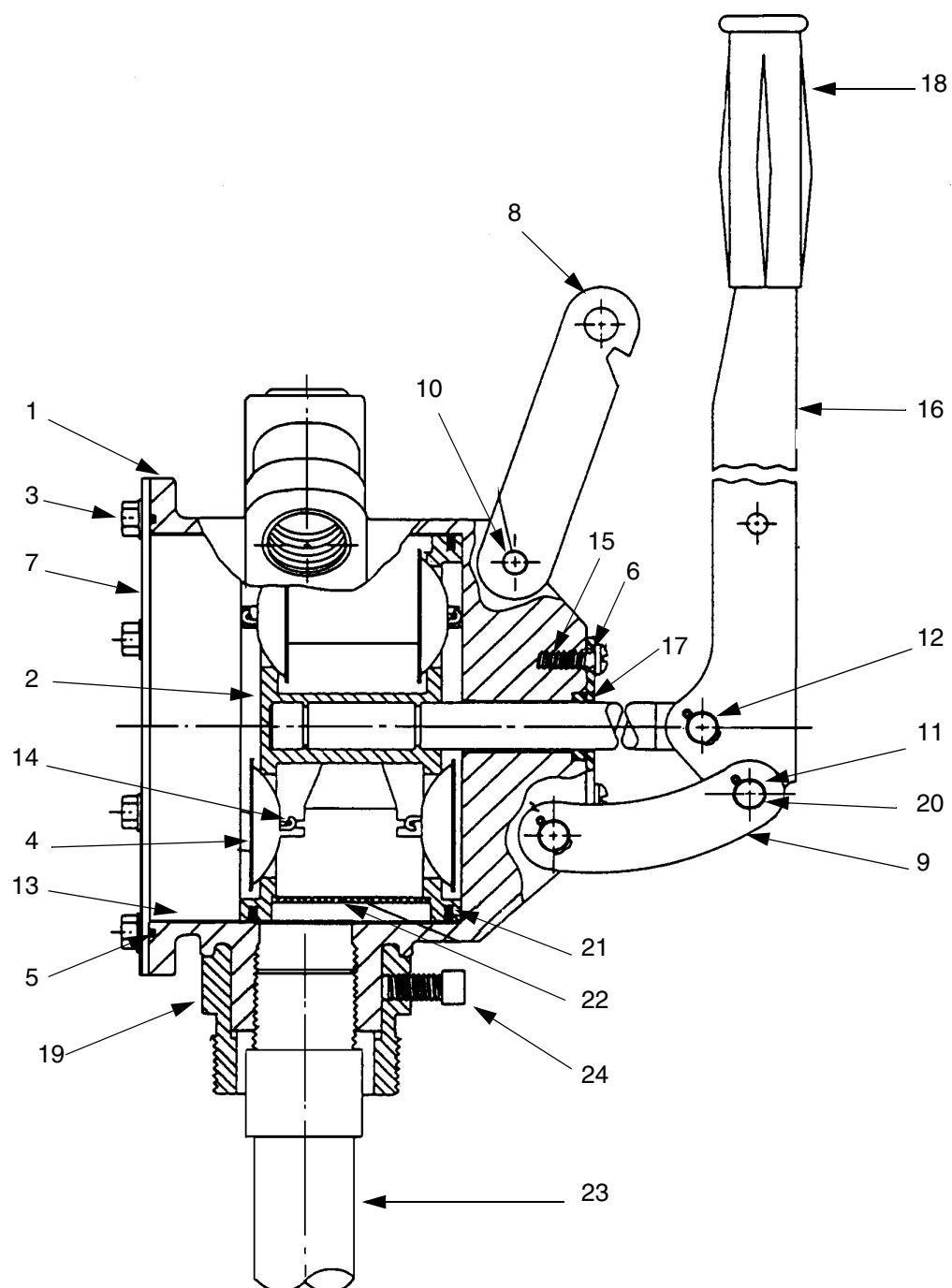

260407, 260406

Ref. No.	Description	Qty.	Ref. No.	Description	Qty.
1	HOUSING, pump	1	15	SCREW, 10-24 x 1/2 in.	2
2	PISTON and SHAFT	1	16	HANDLE	1
3	BOLT, 1/4-20 x 3/8 in.	8	17a	SEAL, shaft, buna-N, model 260407	1
4	POPPET ASSY	4	17b	SEAL, shaft, fluoroelastomer, model 260406	
5a	COVER SEAL, buna-N, model 260407	1	18	GRIP, handle	1
5b	COVER SEAL, fluoroelastomer, model 260406	1	19	ADAPTER, bung	1
6	RETAINER, seal	1	20	PIN, cotter	3
7	COVER	1	21	SEAL, piston	2
8	LATCH	1	22	SCREEN, inlet	2
9	BRACKET, link	2	23	STANDPIPE	1
10	PIN, latch	1	24	BOLT, 3/8-16 x 3/4 in.	2
11	PIN, clevis	2	25	HOSE, fuel, 3/4 in x 8 ft (19 mm x 2.4 m) (not shown)	1
12	PIN, piston	1		HOSE, chemical, 3/4 in x 8 ft (19 mm x 2.4 m) (not shown)	1
13	LINER, piston, sst	1			
14	RETAINER, spring	4	26	NOZZLE (not shown)	1

Kits**Kit**

Number	Description
260431	KIT, seal for 260407
260432	KIT, seal for 260406

Includes Items

4, 5a, 12, 17a, 21
4, 5b, 12, 17b, 21

Technical Data

Inlet Size	1 in. npt
Outlet Size	3/4 in. npt
Weight	12 lb (5.4 kg)
Hose size	Model 260407 3/4 in. x 8 ft (19 mm x 2.4 m) buna-N
	Model 260406 3/4 in. x 8 ft (19 mm x 2.4 m) EPDM
Suction Tube	1in. (25 mm) x 34 in. (864 mm) (2 pieces)
Wetted Parts	aluminum alloy 380, carbon steel with zinc plating, AMS 5688 and 302 stainless steel, nylon, PTFE, PVC, buna-N, fluoroelastomer

Graco Standard Warranty

Graco warrants all equipment referenced in this document which is manufactured by Graco and bearing its name to be free from defects in material and workmanship on the date of sale to the original purchaser for use. With the exception of any special, extended, or limited warranty published by Graco, Graco will, for a period of twelve months from the date of sale, repair or replace any part of the equipment determined by Graco to be defective. This warranty applies only when the equipment is installed, operated and maintained in accordance with Graco's written recommendations.

This warranty does not cover, and Graco shall not be liable for general wear and tear, or any malfunction, damage or wear caused by faulty installation, misapplication, abrasion, corrosion, inadequate or improper maintenance, negligence, accident, tampering, or substitution of non-Graco component parts. Nor shall Graco be liable for malfunction, damage or wear caused by the incompatibility of Graco equipment with structures, accessories, equipment or materials not supplied by Graco, or the improper design, manufacture, installation, operation or maintenance of structures, accessories, equipment or materials not supplied by Graco.

This warranty is conditioned upon the prepaid return of the equipment claimed to be defective to an authorized Graco distributor for verification of the claimed defect. If the claimed defect is verified, Graco will repair or replace free of charge any defective parts. The equipment will be returned to the original purchaser transportation prepaid. If inspection of the equipment does not disclose any defect in material or workmanship, repairs will be made at a reasonable charge, which charges may include the costs of parts, labor, and transportation.

THIS WARRANTY IS EXCLUSIVE, AND IS IN LIEU OF ANY OTHER WARRANTIES, EXPRESS OR IMPLIED, INCLUDING BUT NOT LIMITED TO WARRANTY OF MERCHANTABILITY OR WARRANTY OF FITNESS FOR A PARTICULAR PURPOSE.

Graco's sole obligation and buyer's sole remedy for any breach of warranty shall be as set forth above. The buyer agrees that no other remedy (including, but not limited to, incidental or consequential damages for lost profits, lost sales, injury to person or property, or any other incidental or consequential loss) shall be available. Any action for breach of warranty must be brought within two (2) years of the date of sale.

GRACO MAKES NO WARRANTY, AND DISCLAIMS ALL IMPLIED WARRANTIES OF MERCHANTABILITY AND FITNESS FOR A PARTICULAR PURPOSE, IN CONNECTION WITH ACCESSORIES, EQUIPMENT, MATERIALS OR COMPONENTS SOLD BUT NOT MANUFACTURED BY GRACO. These items sold, but not manufactured by Graco (such as electric motors, switches, hose, etc.), are subject to the warranty, if any, of their manufacturer. Graco will provide purchaser with reasonable assistance in making any claim for breach of these warranties.

In no event will Graco be liable for indirect, incidental, special or consequential damages resulting from Graco supplying equipment hereunder, or the furnishing, performance, or use of any products or other goods sold hereto, whether due to a breach of contract, breach of warranty, the negligence of Graco, or otherwise.

FOR GRACO CANADA CUSTOMERS

The Parties acknowledge that they have required that the present document, as well as all documents, notices and legal proceedings entered into, given or instituted pursuant hereto or relating directly or indirectly hereto, be drawn up in English. Les parties reconnaissent avoir convenu que la rédaction du présente document sera en Anglais, ainsi que tous documents, avis et procédures judiciaires exécutés, donnés ou intentés, à la suite de ou en rapport, directement ou indirectement, avec les procédures concernées.

Graco Information

TO PLACE AN ORDER, contact your Graco distributor or call to identify the nearest distributor.

Phone: 612-623-6928 or **Toll Free:** 1-800-533-9655, **Fax:** 612-378-3590

*All written and visual data contained in this document reflects the latest product information available at the time of publication.
Graco reserves the right to make changes at any time without notice.*

This manual contains English. MM 311308

Graco Headquarters: Minneapolis

International Offices: Belgium, China, Japan, Korea

GRACO INC. P.O. BOX 1441 MINNEAPOLIS, MN 55440-1441

www.graco.com

11/2005 Revised 02/2007