

REACTOR™

310815 rev.C

Complete Electric, Heated, Plural Component Proportioning System.
For spraying polyurethane foam and polyurea coatings.
Not for use in explosive atmospheres.



Important Safety Instructions

Read all warnings and instructions in this manual.
Save these instructions.

See page 2 for model information, including maximum working pressure, and related manuals.

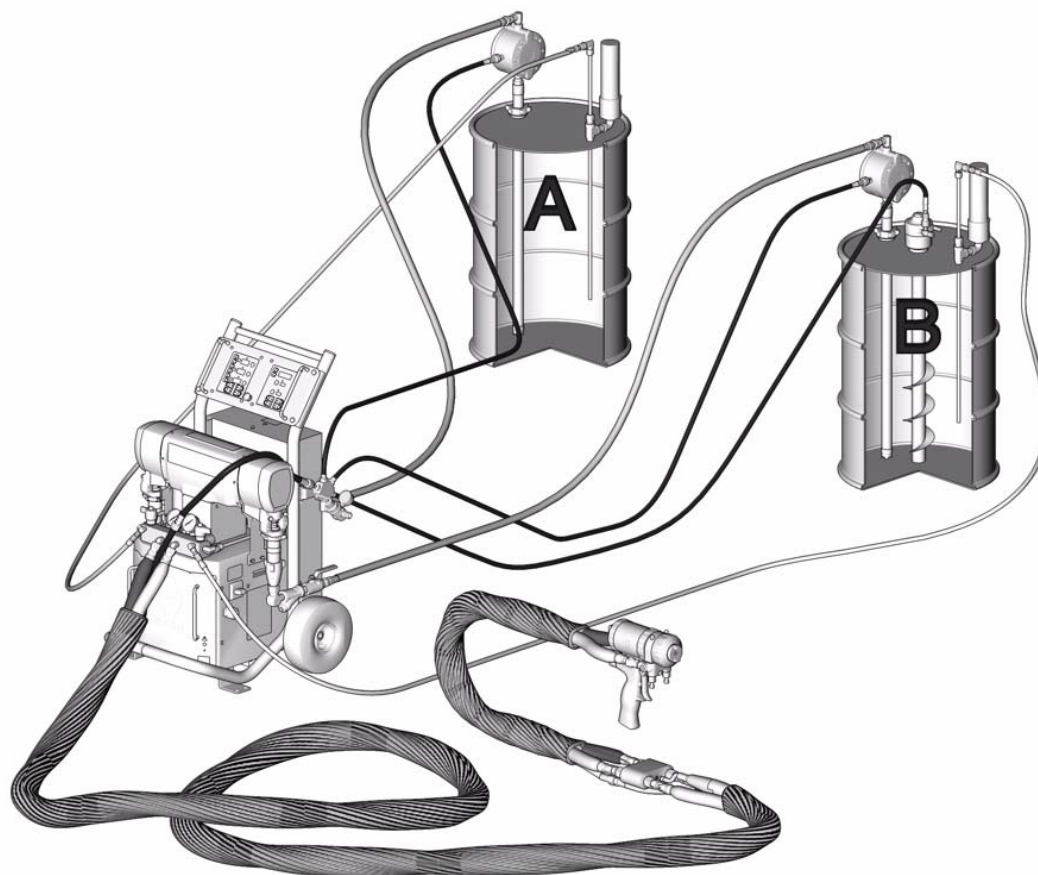

TI6176a

PROVEN QUALITY. LEADING TECHNOLOGY.

Models

Part No.	Maximum Working Pressure psi (MPa, bar)	Description	Includes Fusion Gun
246641	2500 (17.2, 172)	Model E-XP1 Reactor Proportioner; 230V 3 phase	246100
234984	3500 (24.1, 241)	Model E-XP2 Reactor Proportioner; 230V 3 phase	246101
247165	2500 (17.2, 172)	Model E-XP1 Reactor Proportioner; 230V 1 phase	246100
247166	3500 (24.1, 241)	Model E-XP2 Reactor Proportioner; 230V 1 phase	246101
249501	2500 (17.2, 172)	Model E-XP1 Reactor Proportioner; 380V 3 phase	246100
249502	3500 (24.1, 241)	Model E-XP2 Reactor Proportioner; 380V 3 phase	246101

Installation

Refer to **Parts** drawing on page 2 to install the system.

Read all warnings and supplied manuals before operating the system.

Parts

Ref. No.	Part No.	Description	Qty.	Ref. No.	Part No.	Description	Qty.
1	246033	PROPORTIONER, E-XP1, Reactor; 230V 3 phase; used on 246641; see manuals 309551 and 309574	1	5	224854	AGITATOR, helix; see manual 308175	1
	246036	PROPORTIONER, E-XP2, Reactor; 230V 3 phase; used on 234984; see manuals 309551 and 309574	1	6	234983	MANIFOLD, air control	1
	246024	PROPORTIONER, E-XP1, Reactor; 230V 1 phase; used on 247165; see manuals 309551 and 309574	1	7	109126	HOSE, air; buna-N; 1/4 npt (mbe); 10 ft (3.05 m)	3
	246028	PROPORTIONER, E-XP2, Reactor; 230V 1 phase; used on 247166; see manuals 309551 and 309574	1	8	109124	HOSE, air; buna-N; 1/4 npt (mbe); 4 ft (1.2 m)	1
2	246679	HOSE, heated; 50 ft (15.2 m); see manual 309572	1	9	246122	MODULE, interface, data reporting (not shown; installed at factory)	1
3	246055	HOSE, whip, heated; 10 ft (3.05 m); see manual 309572	1	10	208536	COUPLER, quick disconnect, air	3
4	246100	SPRAY GUN, Fusion, air purge; with AR2929 mix chamber; used on 246641, 247165, and 249501; see manual 309550	1	11	169969	FITTING, quick disconnect, air	1
	246101	SPRAY GUN, Fusion, air purge; with AR4242 mix chamber; used on 234984, 247166, and 249502; see manual 309550	1	12	246477	KIT, return tube; see manual 309852	2
				13	H45010	HOSE, fluid; nylon; 1/2 in. (13 mm) ID; 1/2 npsm (fbe); 10 ft (3.05 m)	2
				14	162449	NIPPLE, reducing; 1/2 x 1/4 npt	2
				16	217382	HOSE, fluid; 3/4 npt (mbe); 3/4 in. (19 mm) ID; 10 ft (3.05 m); nylon	2
				17	157785	UNION, swivel; 3/4 npt(m) x 3/4 npsm(f)	2
				18	113344	UNION, swivel; 1/2 npt(m) x 3/4 npsm(f)	2

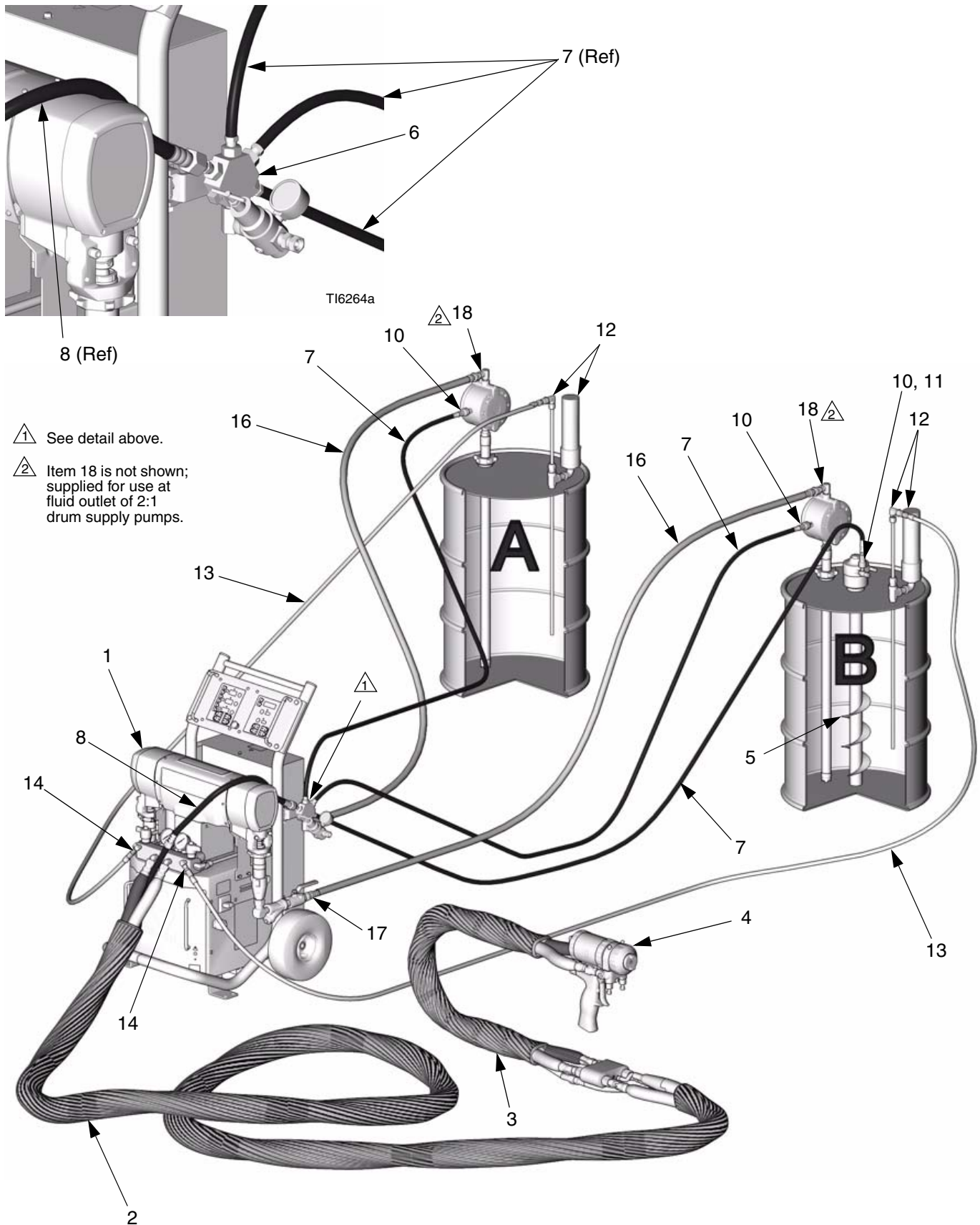

TI6176a

Graco Standard Warranty

Graco warrants all equipment referenced in this document which is manufactured by Graco and bearing its name to be free from defects in material and workmanship on the date of sale to the original purchaser for use. With the exception of any special, extended, or limited warranty published by Graco, Graco will, for a period of twelve months from the date of sale, repair or replace any part of the equipment determined by Graco to be defective. This warranty applies only when the equipment is installed, operated and maintained in accordance with Graco's written recommendations.

This warranty does not cover, and Graco shall not be liable for general wear and tear, or any malfunction, damage or wear caused by faulty installation, misapplication, abrasion, corrosion, inadequate or improper maintenance, negligence, accident, tampering, or substitution of non-Graco component parts. Nor shall Graco be liable for malfunction, damage or wear caused by the incompatibility of Graco equipment with structures, accessories, equipment or materials not supplied by Graco, or the improper design, manufacture, installation, operation or maintenance of structures, accessories, equipment or materials not supplied by Graco.

This warranty is conditioned upon the prepaid return of the equipment claimed to be defective to an authorized Graco distributor for verification of the claimed defect. If the claimed defect is verified, Graco will repair or replace free of charge any defective parts. The equipment will be returned to the original purchaser transportation prepaid. If inspection of the equipment does not disclose any defect in material or workmanship, repairs will be made at a reasonable charge, which charges may include the costs of parts, labor, and transportation.

THIS WARRANTY IS EXCLUSIVE, AND IS IN LIEU OF ANY OTHER WARRANTIES, EXPRESS OR IMPLIED, INCLUDING BUT NOT LIMITED TO WARRANTY OF MERCHANTABILITY OR WARRANTY OF FITNESS FOR A PARTICULAR PURPOSE.

Graco's sole obligation and buyer's sole remedy for any breach of warranty shall be as set forth above. The buyer agrees that no other remedy (including, but not limited to, incidental or consequential damages for lost profits, lost sales, injury to person or property, or any other incidental or consequential loss) shall be available. Any action for breach of warranty must be brought within two (2) years of the date of sale.

GRACO MAKES NO WARRANTY, AND DISCLAIMS ALL IMPLIED WARRANTIES OF MERCHANTABILITY AND FITNESS FOR A PARTICULAR PURPOSE, IN CONNECTION WITH ACCESSORIES, EQUIPMENT, MATERIALS OR COMPONENTS SOLD BUT NOT MANUFACTURED BY GRACO. These items sold, but not manufactured by Graco (such as electric motors, switches, hose, etc.), are subject to the warranty, if any, of their manufacturer. Graco will provide purchaser with reasonable assistance in making any claim for breach of these warranties.

In no event will Graco be liable for indirect, incidental, special or consequential damages resulting from Graco supplying equipment hereunder, or the furnishing, performance, or use of any products or other goods sold hereto, whether due to a breach of contract, breach of warranty, the negligence of Graco, or otherwise.

FOR GRACO CANADA CUSTOMERS

The Parties acknowledge that they have required that the present document, as well as all documents, notices and legal proceedings entered into, given or instituted pursuant hereto or relating directly or indirectly hereto, be drawn up in English. Les parties reconnaissent avoir convenu que la rédaction du présente document sera en Anglais, ainsi que tous documents, avis et procédures judiciaires exécutés, donnés ou intentés, à la suite de ou en rapport, directement ou indirectement, avec les procédures concernées.

Graco Information

TO PLACE AN ORDER, contact your Graco distributor or call to identify the nearest distributor.

Phone: 612-623-6921 **or Toll Free:** 1-800-328-0211 **Fax:** 612-378-3505

*All written and visual data contained in this document reflects the latest product information available at the time of publication.
Graco reserves the right to make changes at any time without notice.*

MM 310815

Graco Headquarters: Minneapolis
International Offices: Belgium, China, Japan, Korea

GRACO INC. P.O. BOX 1441 MINNEAPOLIS, MN 55440-1441

www.graco.com

Printed in USA 310815C

4/2006