

Instructions – Parts List



Paint Preparation System

310693 rev.C

For HVLP, Compliant, and Air Spray Guns.

U.S. Patent Pending



Important Safety Instructions

Read all warnings and instructions in this manual.
Save these instructions.

234773
Siphon Feed

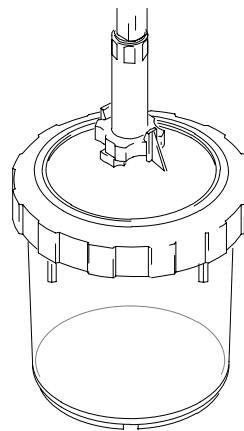

249259 (GT)
234837 (XT)
Gravity Feed

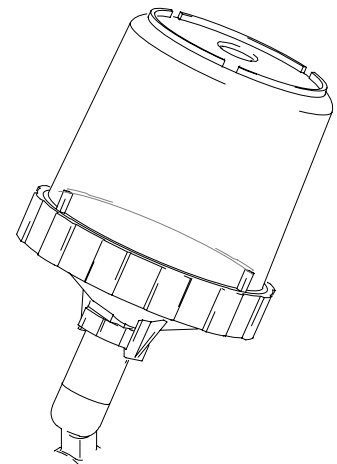

Table of Contents

| | | | |
|-------------------|---|-------------------------------|----|
| Symbols | 2 | Parts | 7 |
| Warnings | 2 | Accessories | 8 |
| Setup | 3 | Graco Standard Warranty | 10 |
| Operation | 5 | Graco Information | 10 |
| Maintenance | 6 | | |

Symbols

Warning Symbol



This symbol alerts you to the possibility of serious injury or death if you do not follow the instructions.

Caution Symbol



This symbol alerts you to the possibility of damage to or destruction of equipment if you do not follow the instructions.

WARNING



PRESSURIZED EQUIPMENT HAZARD



Spray from the gun, hose leaks or ruptured components can splash fluid in the eyes or on the skin and cause serious injury.

- Follow the **Pressure Relief Procedure** on page 5 when: you are instructed to relieve pressure; stop spraying; clean, check or service the equipment; and install or clean fluid nozzles.
- Tighten all fluid connections before operating the equipment.
- Check the hoses, tubes and couplings daily. Replace worn, damaged or loose parts immediately.



INSTRUCTIONS

EQUIPMENT MISUSE HAZARD

Misuse can cause death or serious injury.

- Do not exceed the maximum working pressure or temperature rating of the lowest rated system component. See **Technical Data** in all equipment manuals.
- Use fluids and solvents that are compatible with equipment wetted parts. See **Technical Data** in all equipment manuals. Read fluid and solvent manufacturer's warnings.
- Check equipment daily. Repair or replace worn or damaged parts immediately.
- Do not alter or modify equipment.
- Use equipment only for its intended purpose. Call your Graco distributor for information.
- Route hoses and cables away from traffic areas, sharp edges, moving parts, and hot surfaces.
- Do not kink or overbend hoses or use hoses to pull equipment.
- Comply with all applicable safety regulations.



TOXIC FLUID OR FUMES HAZARD

Toxic fluids or fumes can cause serious injury or death if splashed in the eyes or on skin, inhaled, or swallowed.

- Read MSDS's to know the specific hazards of the fluids you are using.
- Store hazardous fluid in approved containers, and dispose of it according to applicable guidelines.

Setup

Installing 3M™ Paint Preparation System (PPS™)

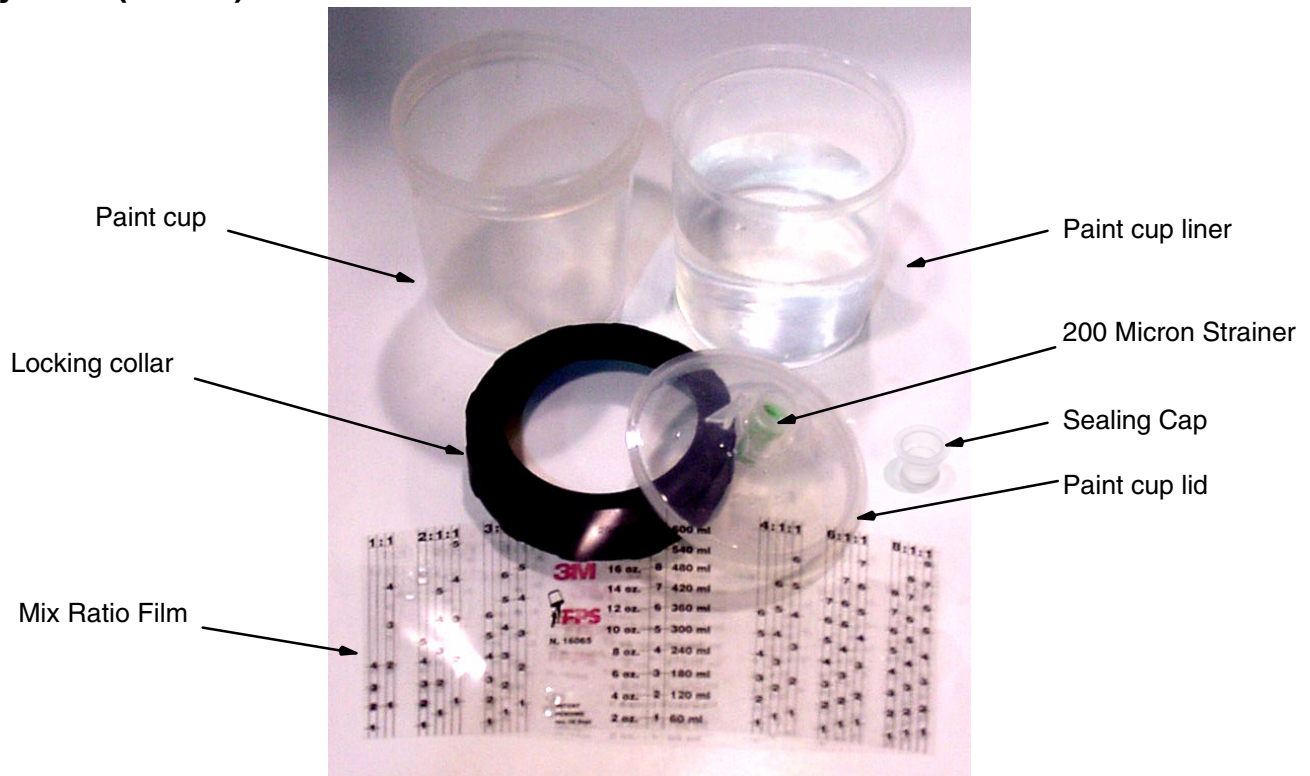

1. Assemble the PPS adapter (3 or 4) to the spray gun fluid inlet. See parts, page 7.
2. Weigh paint in the cup with liner according to paint manufacturers instructions before mixing product.
5. Position locking collar onto the PPS cup and turn until tight.
6. With spray gun inverted, lower onto PPS cup and lock gun adapter, turning clockwise, to lid.



Fig. 1

3. Mix product as needed.
4. Take the lid (with built in strainer) and snap onto the top of PPS cup.



Fig. 2

Setup

7. Make sure that the lid fingers are fully engaged above adapter edge.

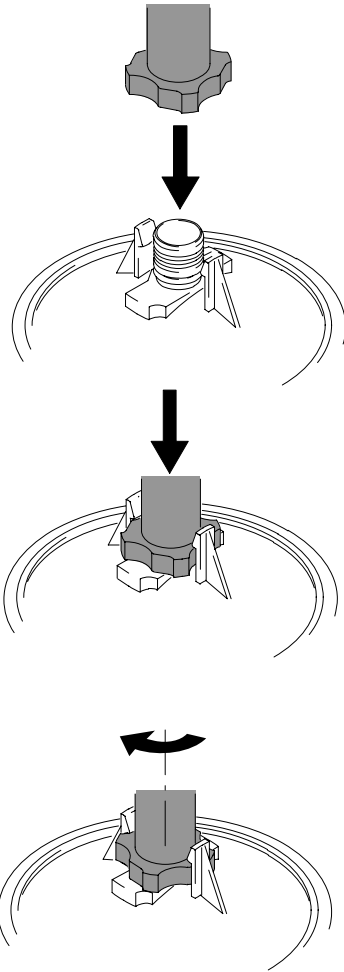

Fig. 3

8. *For gravity feed gun only:* With air line connected, invert gun and pull trigger (fully open NOT partially) to bleed air from the liner.

NOTE: Air only needs to be bled if spraying in the inverted position.

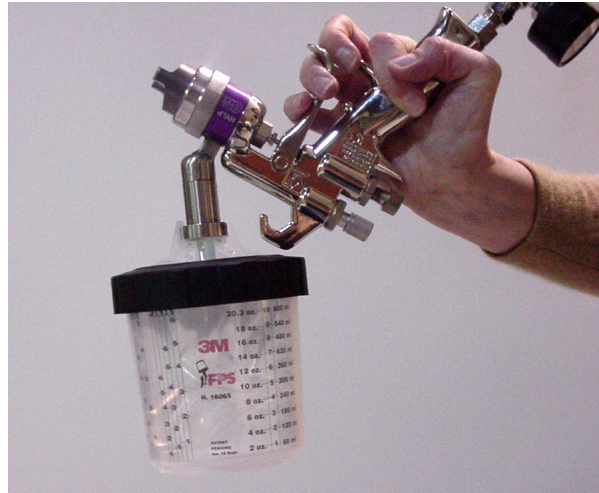

Fig. 4

9. With the air removed from the liner, the gun may be sprayed upside down or in any direction to reach difficult areas.



Fig. 5

Operation

Pressure Relief Procedure

WARNING

PRESSURIZED EQUIPMENT HAZARD

The system pressure must be manually relieved to prevent the system from starting or spraying accidentally. To reduce the risk of an injury from accidental spray from the gun, splashing fluid, or moving parts, follow the **Pressure Relief Procedure** whenever you:

- are instructed to relieve the pressure,
- stop spraying,
- check or service any of the system equipment,
- or install or clean the spray nozzle.

1. Turn off the air supply to the gun.
2. Disconnect air line from the gun.

3. *For gravity feed guns only:* Invert gun and pull trigger (fully open, not partially) to return mix to gun cup.
For siphon feed guns only: Trigger gun returning mix to gun cup.

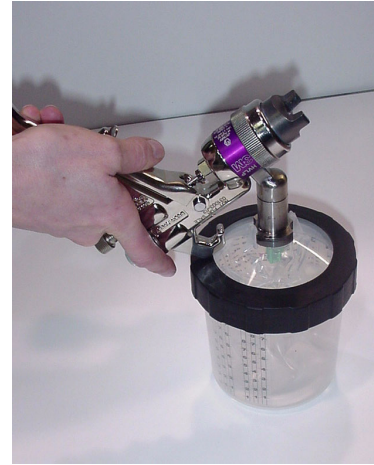

Fig. 6

Maintenance

Removing the paint supply

WARNING

PRESSURIZED EQUIPMENT HAZARD

To reduce the risk of a serious injury whenever you are instructed to relieve pressure, follow the **Pressure Relief Procedure** on page 5.

1. Relieve the pressure, page 5.
2. Remove PPS cup by inverting the gun. Turn the gun counterclockwise unlocking the gun adapter from the paint cup.
3. Flush the spray gun. See Flushing procedure in your gun manual.
4. To retain unused paint, seal the lid with the PPS sealing cap, label, and temporarily store mixed material in PPS cup.

Parts

3M™ PPS™ Paint Cup Assembly

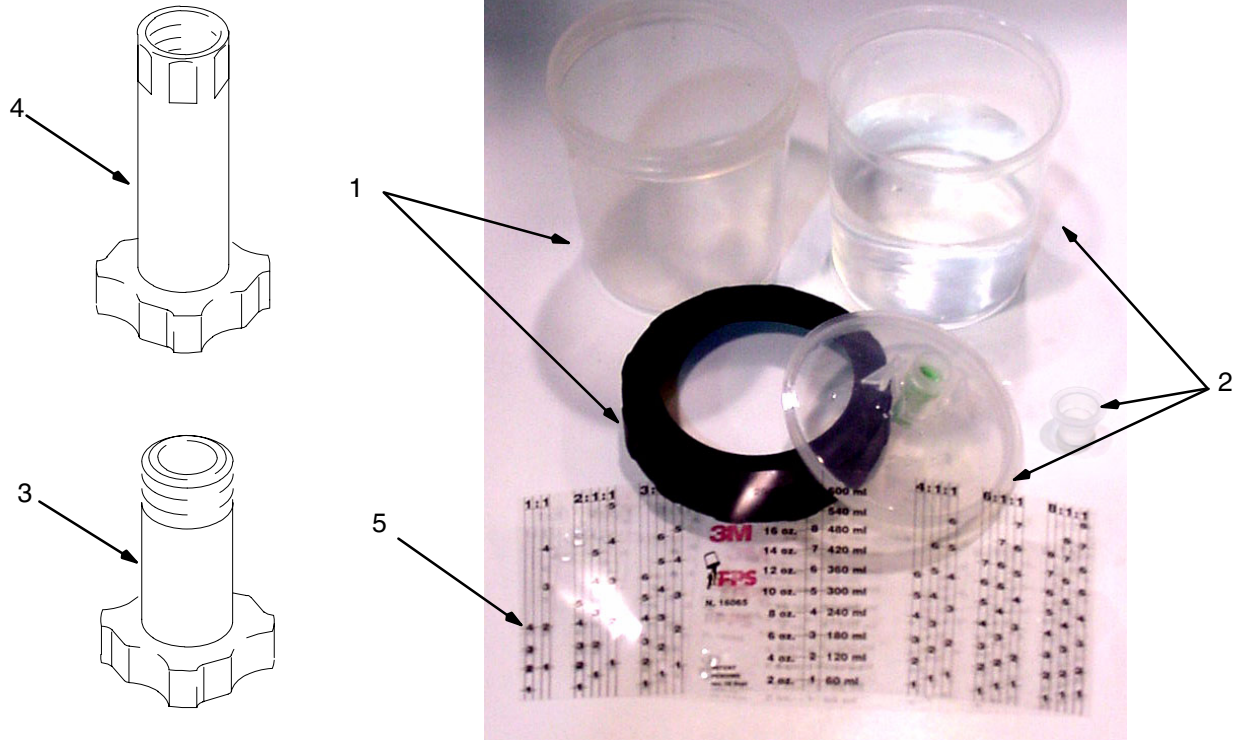

| Ref. No. | Part No. | Description | Qty. |
|----------|----------|----------------------------|---------|
| 1 | 234941 | CUP AND COLLAR 6 oz. | 8 ea. |
| | 234771 | CUP AND COLLAR 25 oz. | 8 ea. |
| | 234937 | CUP AND COLLAR 32 oz. | 4 ea. |
| 2 | 234940 | LIDS AND LINERS 6 oz. | 50 ea. |
| | 234772 | LIDS AND LINERS 25 oz. | 50 ea. |
| | 234938 | LIDS AND LINERS 32 oz. | 25 ea. |
| 3 | 15C464 | ADAPTER, gravity (XT only) | 1 |
| | 15F505 | ADAPTER, gravity (GT only) | 1 |
| 4 | 15D684 | ADAPTER, siphon | 1 |
| 5 | 234942 | RATIO FILM, insert 6 oz. | 50 ea. |
| | 15F531 | RATIO FILM, insert 25 oz. | 100 ea. |
| | 234939 | RATIO FILM, insert 32 oz. | 100 ea. |

Accessories

15E469 3M™ PPS™ Liner Dispenser

Wall mount dispenser for easy storage and handling of liners. Holds 50 of either the 25 or 32 oz. liners.

15E470 3M™ PPS™ Lid Dispenser

Wall mount dispenser for easy storage and handling of lids. Holds 50 of either the 25 or 32 oz. liners.

15E467 3M™ PPS™ Carrier Tray

Carrier tray will fit six 25 or 32 oz. PPS cups. Also comes with wall attachment hardware.

This image shows a single sheet of white paper with horizontal ruling lines. The lines are evenly spaced and run across the width of the page. There are no margins, text, or other markings on the paper.

Graco Standard Warranty

Graco warrants all equipment manufactured by Graco and bearing its name to be free from defects in material and workmanship on the date of sale to the original purchaser for use. With the exception of any special, extended, or limited warranty published by Graco, Graco will, for a period of twelve months from the date of sale, repair or replace any part of the equipment determined by Graco to be defective. This warranty applies only when the equipment is installed, operated and maintained in accordance with Graco's written recommendations.

This warranty does not cover, and Graco shall not be liable for general wear and tear, or any malfunction, damage or wear caused by faulty installation, misapplication, abrasion, corrosion, inadequate or improper maintenance, negligence, accident, tampering, or substitution of non-Graco component parts. Nor shall Graco be liable for malfunction, damage or wear caused by the incompatibility of Graco equipment with structures, accessories, equipment or materials not supplied by Graco, or the improper design, manufacture, installation, operation or maintenance of structures, accessories, equipment or materials not supplied by Graco.

This warranty is conditioned upon the prepaid return of the equipment claimed to be defective to an authorized Graco distributor for verification of the claimed defect. If the claimed defect is verified, Graco will repair or replace free of charge any defective parts. The equipment will be returned to the original purchaser transportation prepaid. If inspection of the equipment does not disclose any defect in material or workmanship, repairs will be made at a reasonable charge, which charges may include the costs of parts, labor, and transportation.

THIS WARRANTY IS EXCLUSIVE, AND IS IN LIEU OF ANY OTHER WARRANTIES, EXPRESS OR IMPLIED, INCLUDING BUT NOT LIMITED TO WARRANTY OF MERCHANTABILITY OR WARRANTY OF FITNESS FOR A PARTICULAR PURPOSE.

Graco's sole obligation and buyer's sole remedy for any breach of warranty shall be as set forth above. The buyer agrees that no other remedy (including, but not limited to, incidental or consequential damages for lost profits, lost sales, injury to person or property, or any other incidental or consequential loss) shall be available. Any action for breach of warranty must be brought within two (2) years of the date of sale.

Graco makes no warranty, and disclaims all implied warranties of merchantability and fitness for a particular purpose in connection with accessories, equipment, materials or components sold but not manufactured by Graco. These items sold, but not manufactured by Graco (such as electric motors, switches, hose, etc.), are subject to the warranty, if any, of their manufacturer. Graco will provide purchaser with reasonable assistance in making any claim for breach of these warranties.

In no event will Graco be liable for indirect, incidental, special or consequential damages resulting from Graco supplying equipment hereunder, or the furnishing, performance, or use of any products or other goods sold hereto, whether due to a breach of contract, breach of warranty, the negligence of Graco, or otherwise.

FOR GRACO CANADA CUSTOMERS

The parties acknowledge that they have required that the present document, as well as all documents, notices and legal proceedings entered into, given or instituted pursuant hereto or relating directly or indirectly hereto, be drawn up in English. Les parties reconnaissent avoir convenu que la rédaction du présente document sera en Anglais, ainsi que tous documents, avis et procédures judiciaires exécutés, donnés ou intentés à la suite de ou en rapport, directement ou indirectement, avec les procédures concernées.

Graco Information

TO PLACE AN ORDER, contact your Graco distributor, or call this number to identify the distributor closest to you:

1-800-328-0211 Toll Free

612-623-6921

612-378-3505 Fax

*All written and visual data contained in this document reflects the latest product information available at the time of publication.
Graco reserves the right to make changes at any time without notice.*

MM 310693

Graco Headquarters: Minneapolis

International Offices: Belgium, China, Japan, Korea

GRACO INC. P.O. BOX 1441 MINNEAPOLIS, MN 55440-1441

www.graco.com

PRINTED IN U.S.A. 310639C 04/2004, Revised 03/2005