

Heater Installation Kit

310677 rev.B

Part No. 248428

Includes parts needed to install VISCON HP heater onto cart. Order VISCON HP heater separately.



Important Safety Instructions

Read all warnings and instructions in Xtreme Mix 185 operation manual 310665 and VISCON HP Heater manual 309524. Save these instructions.

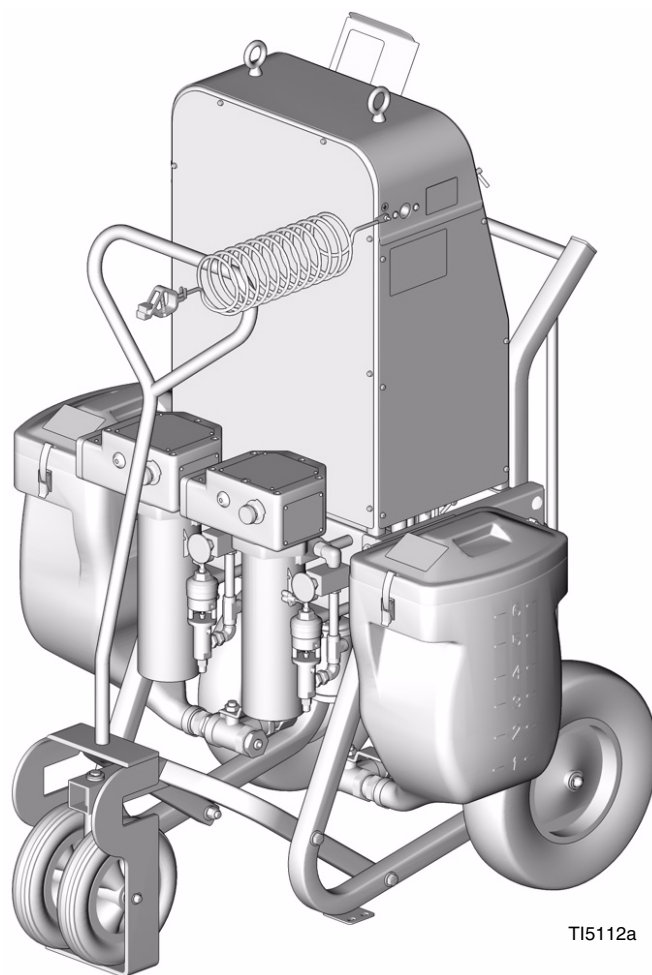

TI5112a

PROVEN QUALITY. LEADING TECHNOLOGY.

Graco Inc. P.O. Box 1441 Minneapolis, MN 55440-1441

Copyright 2004, Graco Inc. is registered to I.S. EN ISO 9001

Installation



Kit does not include heater. Order VISCON HP Heater separately.

This kit supplies parts to mount one heater. If two heaters are being installed, order two kits.

Install Heater, Dispense Valve, and Fittings

WARNING



To reduce the risk of fluid injection, which can result in serious injury, including amputation, relieve system pressure as instructed in the proportioner operation manual before installing kit.



Parts referenced with letters are not included with the kit.

Use pipe sealant on all pipe threads. Tighten fittings fully.

1. Flush fluid system (see proportioner operation manual).
2. Relieve entire system pressure (see proportioner operation manual).
3. Wire the heater power supply cord (see heater manual).
4. Mount the heater (H) on the cart with screws (20), washers (9), and spacers (19). Place it on the side that is to be heated. See FIG. 1.
5. Remove thermometer assembly (T) and fittings from heater outlet (U). Reassemble with kit fittings (17, 14, 13, 15, 12) as shown.
6. Install straight swivel (11) in dispense valve (2) inlet. Screw swivel onto elbow (12) so dispense valve is mounted below thermometer gauge.
7. Screw elbow (18) onto one length of hose (4a). Remove fitting from heater inlet and install elbow/hose assembly on heater inlet tube.
8. Install second length of hose (4b) into tee (15).
9. On side to be heated, remove fluid line and compression fittings between fluid filter (V) outlet and mix manifold inlet (W).
10. Install swivel elbow (3) in fluid filter outlet, and straight swivel (11) in mix manifold inlet (W).
11. Connect heater inlet hose (4a) to swivel elbow (3) at fluid filter outlet. Position elbow and hose to minimize possible hose damage or wear.
12. Connect heater outlet hose (4b) to straight swivel (11) at mix manifold inlet (W). Position swivel and hose to minimize possible hose damage or wear.
13. See **Install Solenoid Valve and Connect Solenoid Lines**, pages 4 and 5.

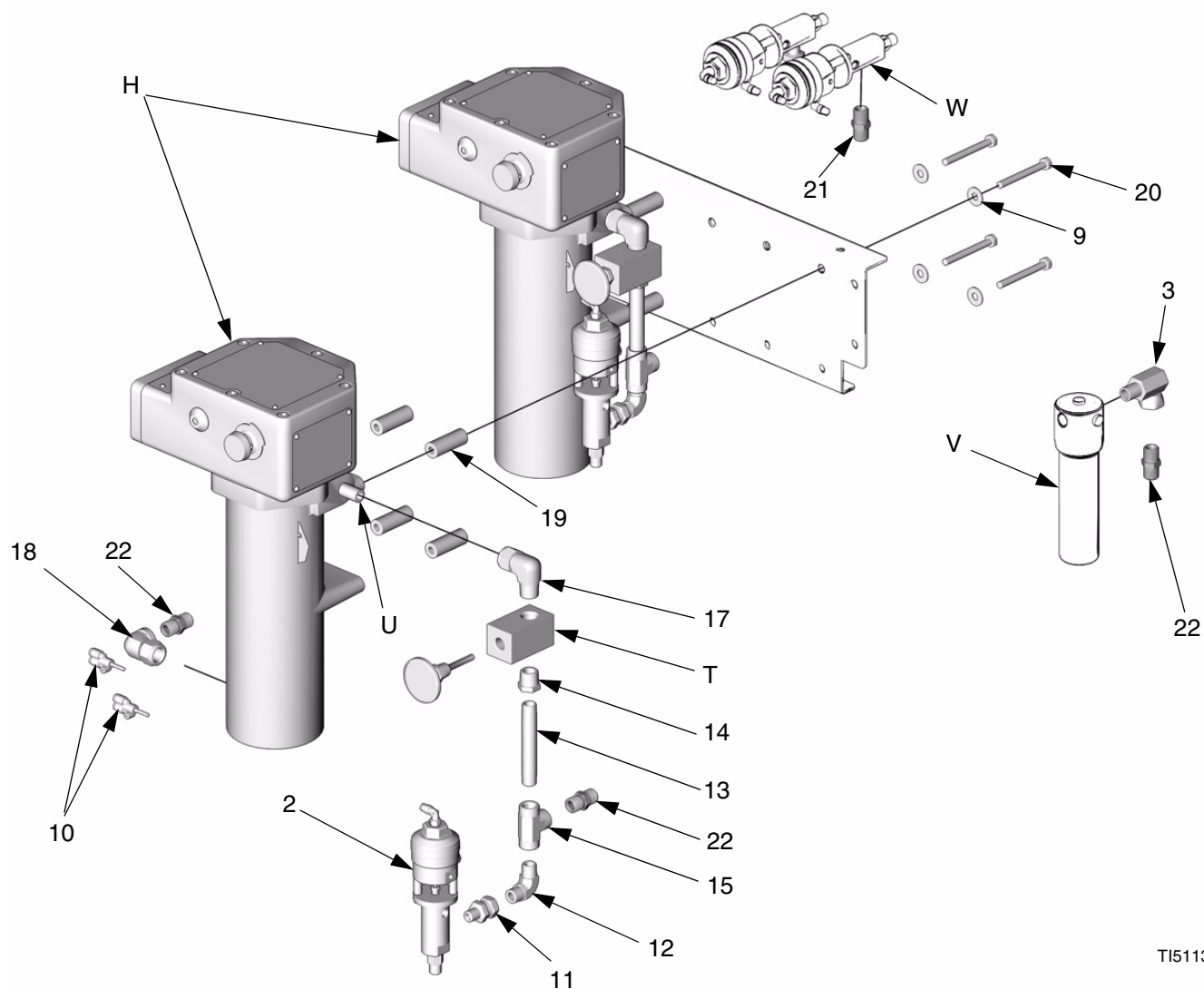

TI5113a

FIG. 1. Install Heaters, Dispense Valves, and Fittings (Two Heater Kits Shown)

Install Solenoid Valve

1. Close main air shutoff valve on air supply line and on proportioner.
2. Remove side panels (C). See FIG. 2.
3. Remove fasteners. Gently pull user interface (D) away from pneumatic control (E).
4. To completely remove user interface (D), disconnect ground wire (G), and wires from J1 and J2 on main board (K).

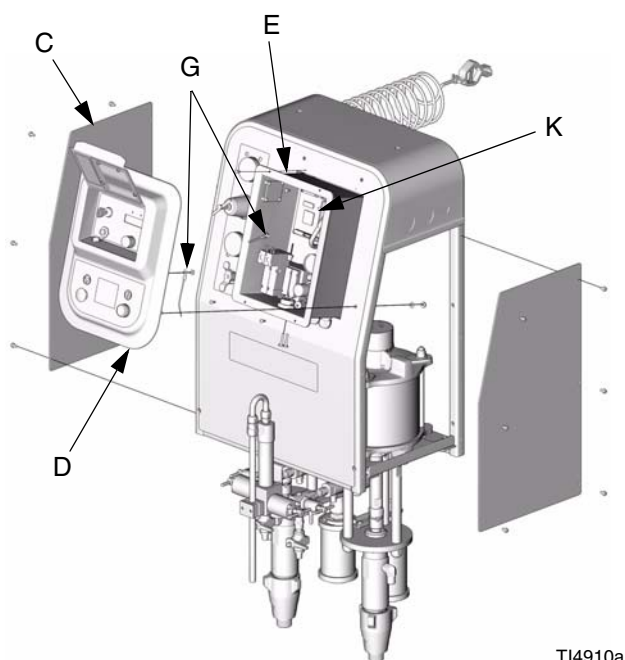

TI4910a

FIG. 2. Access Solenoid Module

Two solenoids are standard with proportioner. If a third solenoid is already installed, skip steps 5-7 and go to **Connect Solenoid Lines**. Do not install a fourth solenoid; save an extra solenoid as a spare.

5. Remove two screws and take off cover plate (P) next to existing solenoids (L). See FIG. 3.
6. Install third solenoid where plate had been. Secure with two screws.
7. Connect electrical plug to solenoid connector (N).

Wire harness for third solenoid is included in control box. Clip tie wrap to extend length enough to reach solenoid.

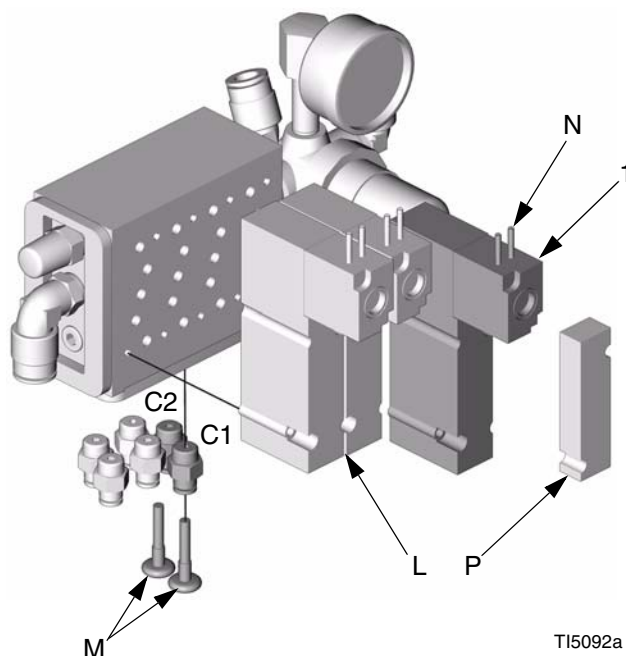

TI5092a

FIG. 3. Install Solenoid Valve

Connect Solenoid Lines

1. Remove plugs (M) from solenoid ports C1 and C2. See FIG. 3.
2. Connect clear tubing (5) between solenoid “open” port (C2) and tube fitting (C2) on dispense valve (2). See FIG. 4.
3. Connect black tubing (6) between solenoid “close” port (C1) and tube fitting (C1) on dispense valve (2).



Wrap air tubing with spiral wrap (supplied) to protect from damage and wear.



If two kits are being installed, use the Y-connectors (10) to supply air to the second dispense valve. The Y-connectors may be installed at the solenoid ports or at the tube fittings of the first dispense valve.

4. Reassemble user interface in reverse order, see page 4.

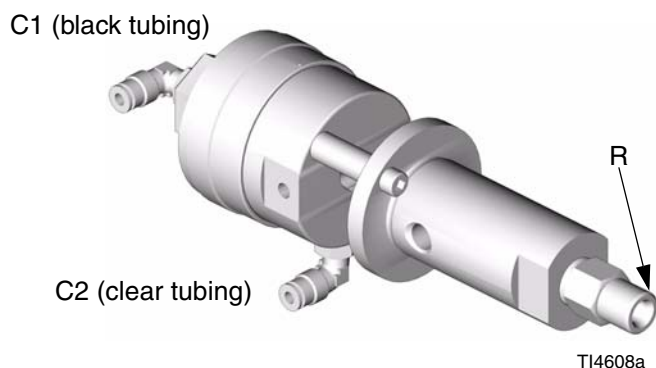

FIG. 4. Dispense Valve Connections

Connect Return Line



WARNING



Use only high pressure return hoses rated to withstand the maximum working pressure of the proportioner. See proportioner operation manual.

1. Connect the return hose (not supplied) to the dispense valve outlet (R). See FIG. 4.
2. Place the other end of the return hose in the fluid supply container.

Operation

To operate the heater, see the VISCON HP manual.

To operate the proportioner in recirculation mode, see the proportioner operation manual.

Parts

Ref. No.	Part No.	Description	Qty.
1	552180	VALVE, solenoid; 12 Vdc	1
2	287222	VALVE, dispense; see 310655	1
3	155494	ELBOW, swivel; 3/8 npt(m) x 3/8 npsm(f); cst	1
4	H53803	HOSE; nylon; 3/8 in. (10 mm) ID; 3/8 npt(fbe); 3 ft (0.9 m)	2
5	598095	TUBE, clear; nylon; 5/32 in. (4 mm) OD	3.25 ft
6	054753	TUBE, black; nylon; 5/32 in. (4 mm) OD	3.25 ft
9	100023	WASHER, flat; 3/8	4
10	198175	Y-CONNECTOR, push-in tube; 5/32 in. (4 mm) OD tube	2
11	157705	UNION, swivel; 1/4 npt(m) x 3/8 npsm(f); cst	1
12	109544	ELBOW, pipe; 3/8 npt (mbe); cst	1
13	100195	NIPPLE; 3/8 npt; cst	1
14	100081	BUSHING, pipe; 1/2 npt(m) x 3/8 npt(f); cst	1
15	105690	TEE; 3/8 npt(f); cst	1
17	15E272	ELBOW, tube; 1/2 npt(m) x 5/8 in. (16 mm) OD tube; cst	1
18	15E273	ELBOW, tube; 3/8 npt(f) x 5/8 in. (16 mm) OD tube; sst	1
19	15E391	SPACER, heater mount	4
20	107557	SCREW, cap, hex hd; M8-1.25 x 75 mm	4
21	165198	NIPPLE, reducing; 1/4 npt(m) x 3/8 npt(m); cst	1
22	156849	NIPPLE, 3/8 npt(m); cst	3

Graco Standard Warranty

Graco warrants all equipment referenced in this document which is manufactured by Graco and bearing its name to be free from defects in material and workmanship on the date of sale by an authorized Graco distributor. With the exception of any special, extended, or limited warranty published by Graco, Graco will, for a period of twelve months from the date of sale, repair or replace any part of the equipment determined by Graco to be defective. This warranty applies only when the equipment is installed, operated and maintained in accordance with Graco's written recommendations.

This warranty does not cover, and Graco shall not be liable for general wear and tear, or any malfunction, damage or wear caused by faulty installation, misapplication, abrasion, corrosion, inadequate or improper maintenance, negligence, accident, tampering, or substitution of non-Graco component parts. Nor shall Graco be liable for malfunction, damage or wear caused by the incompatibility of Graco equipment with structures, accessories, equipment or materials not supplied by Graco, or the improper design, manufacture, installation, operation or maintenance of structures, accessories, equipment or materials not supplied by Graco.

This warranty is conditioned upon the prepaid return of the equipment claimed to be defective to an authorized Graco distributor for verification of the claimed defect. If the claimed defect is verified, Graco will repair or replace free of charge any defective parts. The equipment will be returned to the original purchaser transportation prepaid. If inspection of the equipment does not disclose any defect in material or workmanship, repairs will be made at a reasonable charge, which charges may include the costs of parts, labor, and transportation.

THIS WARRANTY IS EXCLUSIVE, AND IS IN LIEU OF ANY OTHER WARRANTIES, EXPRESS OR IMPLIED, INCLUDING BUT NOT LIMITED TO WARRANTY OF MERCHANTABILITY OR WARRANTY OF FITNESS FOR A PARTICULAR PURPOSE.

Graco's sole obligation and buyer's sole remedy for any breach of warranty shall be as set forth above. The buyer agrees that no other remedy (including, but not limited to, incidental or consequential damages for lost profits, lost sales, injury to person or property, or any other incidental or consequential loss) shall be available. Any action for breach of warranty must be brought within two (2) years of the date of sale.

GRACO MAKES NO WARRANTY, AND DISCLAIMS ALL IMPLIED WARRANTIES OF MERCHANTABILITY AND FITNESS FOR A PARTICULAR PURPOSE, IN CONNECTION WITH ACCESSORIES, EQUIPMENT, MATERIALS OR COMPONENTS SOLD BUT NOT MANUFACTURED BY GRACO. These items sold, but not manufactured by Graco (such as electric motors, switches, hose, etc.), are subject to the warranty, if any, of their manufacturer. Graco will provide purchaser with reasonable assistance in making any claim for breach of these warranties.

In no event will Graco be liable for indirect, incidental, special or consequential damages resulting from Graco supplying equipment hereunder, or the furnishing, performance, or use of any products or other goods sold hereto, whether due to a breach of contract, breach of warranty, the negligence of Graco, or otherwise.

FOR GRACO CANADA CUSTOMERS

The Parties acknowledge that they have required that the present document, as well as all documents, notices and legal proceedings entered into, given or instituted pursuant hereto or relating directly or indirectly hereto, be drawn up in English. Les parties reconnaissent avoir convenu que la rédaction du présente document sera en Anglais, ainsi que tous documents, avis et procédures judiciaires exécutés, donnés ou intentés, à la suite de ou en rapport, directement ou indirectement, avec les procédures concernées.

Graco Information

TO PLACE AN ORDER, contact your Graco distributor or call to identify the nearest distributor.

Phone: 612-623-6921 **or Toll Free:** 1-800-328-0211, **Fax:** 612-378-3505

*All written and visual data contained in this document reflects the latest product information available at the time of publication.
Graco reserves the right to make changes at any time without notice.*

MM 310677

Graco Headquarters: Minneapolis
International Offices: Belgium, China, Japan, Korea

GRACO INC. P.O. BOX 1441 MINNEAPOLIS, MN 55440-1441

www.graco.com

Printed in USA 310677B

2/2006