

# Kits, Paint Hopper

310660 Rev.A

## Model Number 248393, Series A

For LineLazer II 3900 and 5900

## Model Number 248394, Series A

For LineLazer 3500 and 5000

### Installation

For LineLazer 3500

- 1 Replace suction hose with Kit 238962 (not included).

For all other LineLazer Models

- 1 See Parts Drawing. Remove old inlet strainer (3) from LineLazer suction tube assembly.
- 2 Install pipe coupling (2) on suction tube assembly with sealant provided.
- 3 Attach intake tube (1) and new inlet strainer (3) to coupling. Use sealant provided.
- 4 Mount reservoir (4) on LineLazer.

### CAUTION

Do not lift paint hopper when full. Attempting to do so may cause damage to paint hopper handles.



### WARNING

When spraying paint into hopper, hold gun firmly in contact with the metal ground strap. Only use a conductive Graco airless paint hose.

## Parts Drawing/List

Ref No.	Part No.	Description	Qty
	248393	KIT, assembly, paint hopper (for LL 3900 and 5900)	Ref
	248394	KIT, assembly, paint hopper (for LL 3500 & 5500)	Ref
1	189674	TUBE, intake	1
2	114967	COUPLING, pipe	1
3	187147	STRAINER, inlet	1

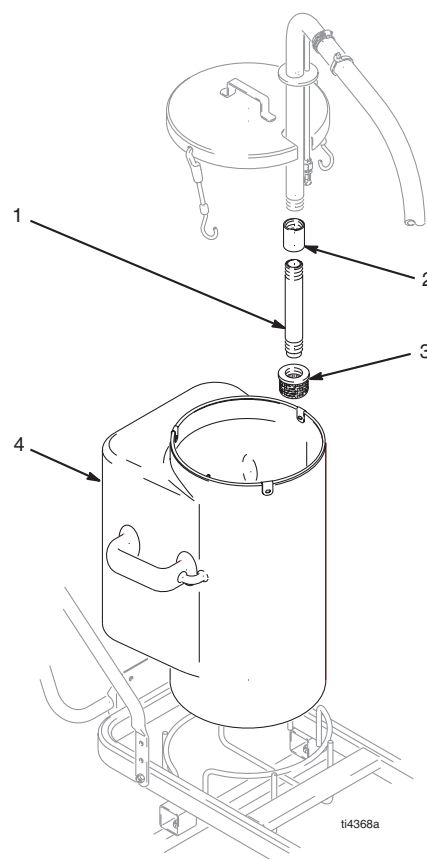

PROVEN QUALITY. LEADING TECHNOLOGY.

*All written and visual data contained in this document reflects the latest product information available at the time of publication.  
Graco reserves the right to make changes at any time without notice.*

**Sales Offices:** Minneapolis, Detroit

**International Offices:** Belgium, Korea, Hong Kong, Japan

**GRACO INC. P.O. BOX 1441 MINNEAPOLIS, MN 55440-1441**

[www.graco.com](http://www.graco.com)

Printed in USA 310660A

1/2004