

Circulation and Return Tube Kits

309852 rev.B

***For recirculation of polyurethane materials from Reactor™
Proportioner to 55 gal. (200 liter) fluid supply drums.***

4000 psi (27.6 MPa, 276 bar) Maximum Fluid Working Pressure

Part No. 246477 Return Tube Kit

Part No. 246978 Circulation Kit



Important Safety Instructions

Read all warnings and instructions in this manual.
Save these instructions.

***246978 Kit shown installed in Reactor
proportioning system. Some parts
shown are not included in kit.***

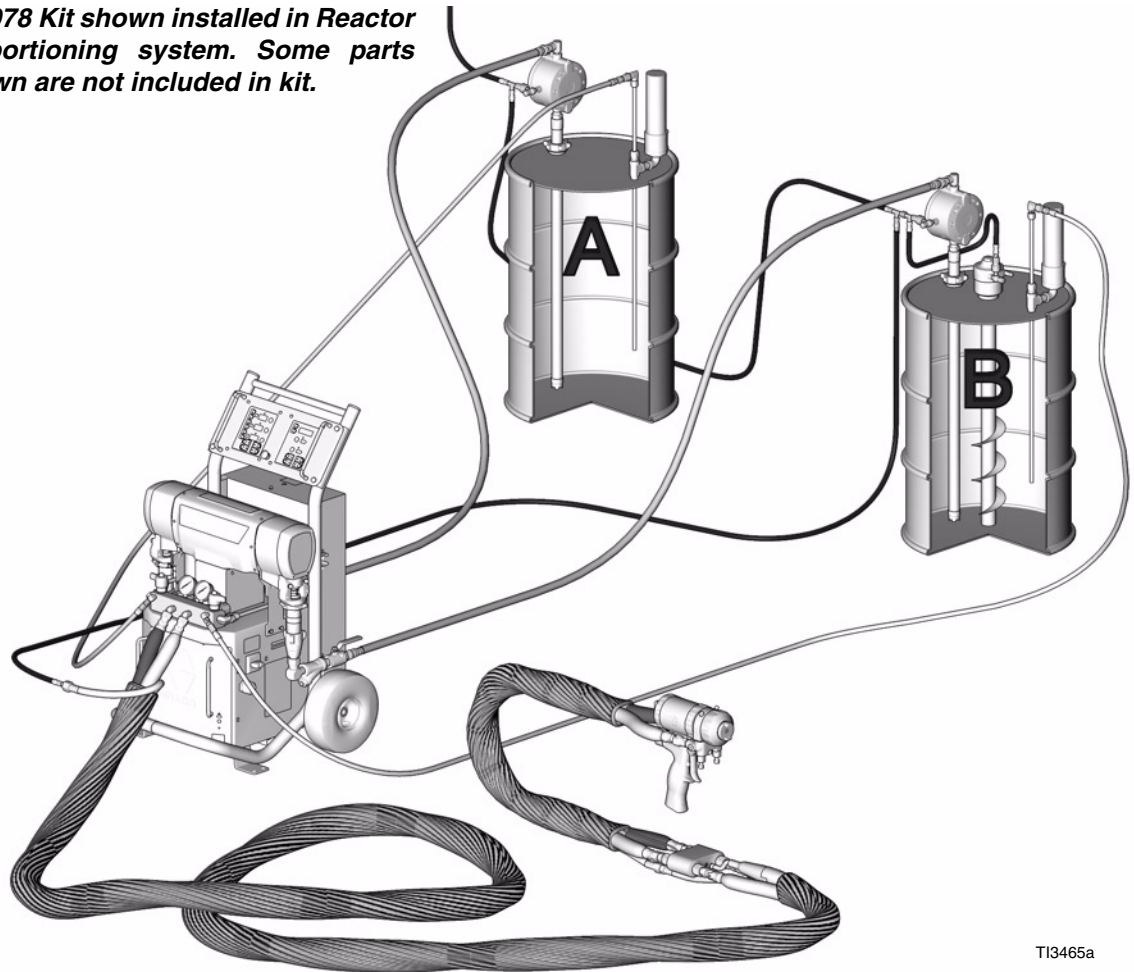

TI3465a

PROVEN QUALITY. LEADING TECHNOLOGY.

Graco Inc. P.O. Box 1441 Minneapolis, MN 55440-1441

Copyright 2003, Graco Inc. is registered to I.S. EN ISO 9001

246477 Return Tube Kit

 The 246477 Return Tube Kit can be installed singly or as a pair. Two are included in the 246978 Circulation Kit, page 3.

1. Keep A and B components separate

CAUTION

To prevent cross-contamination of fluid, mark A component (ISO) connections with red tape. Mark B component (RES) connections with blue tape. Do not interchange or cross-connect A component and B component parts.

2. Assemble return tube kit

Remove dryer carriage (C). Using awl or similar tool, punch a few small holes in each end of carriage. Reinstall carriage.

Remove large fitting included with dryer (10). It is not needed for this application.

Apply thread sealant (8) to threads. Assemble return tube kit as shown at right.

3. Install kit in drum

Open drum port. Lower kit into drum. Screw tee (6) into drum port to secure. Use bushing (5) to adjust position of tube (4) in tank.

4. Install circulation kit, page 3

WARNING



To reduce the risk of serious injury including fluid injection, use high pressure return hoses rated to withstand the maximum working pressure of the Reactor. See Reactor operation manual.

Ref.

No.	Part No.	Description	Qty
1	117532	ELBOW, 90°; 1/2 in. (13 mm) OD tube x 1/2 npt(m)	1
2	117453	FERRULE, tube; sst	1
3	117454	NUT, tube, flareless	1
4	15C514	TUBE; sst; 1/2 in. (13 mm) OD; 4 ft (1.2 m)	1
5	117811	BUSHING, strain relief; 3/4 npt(m)	1
6	111337	TEE, street; 3/4 npt (mxf) run; 3/4 npt(f) branch	1
8	110110	SEALANT, pipe; 6 ml	1
10	246640	DRYER, desiccant	1

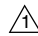
 Apply thread sealant (8) to threads.

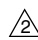
 Punch holes in ends of carriage (C).

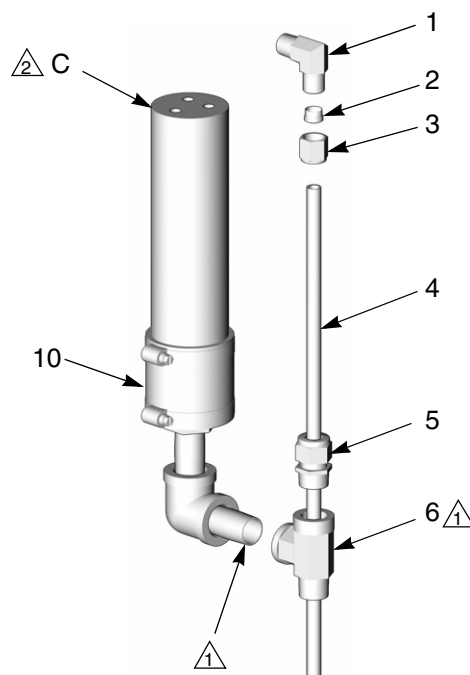

TI3446a

246978 Circulation Kit

1. Install two return tube kits, page 2

CAUTION

To prevent cross-contamination of fluid, mark A component (ISO) connections with red tape. Mark B component (RES) connections with blue tape. Do not interchange or cross-connect A component and B component parts.

2. Connect circulation kit

Remove fittings from elbows (A, B) at Reactor fluid manifold. Screw reducing nipples (104) into elbows. Connect one end of hoses (102) to each nipple.

Connect other end of A side hose (102) to elbow (E) of A component return tube kit. Repeat for B side hose.

Ref.

No.	Part No.	Description	Qty
101	246477	KIT, return tube; see page 2	2
102	H45010	HOSE, fluid; nylon; 1/2 in. (13 mm) ID; 1/2 npsm(fbe); 10 ft (3.05 m);	2
104	162449	NIPPLE, reducing; 1/2 x 1/4 npt	2

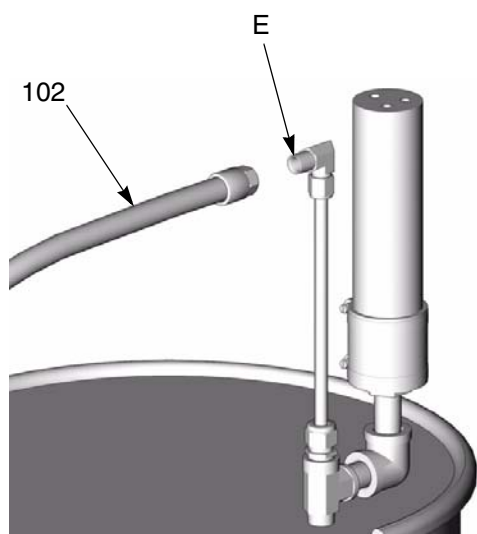

TI3512a

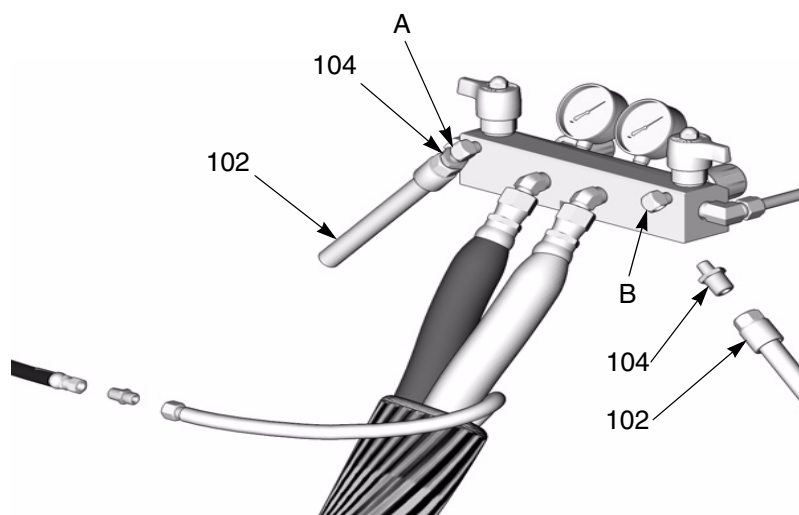

TI3510a

Graco Standard Warranty

Graco warrants all equipment referenced in this document which is manufactured by Graco and bearing its name to be free from defects in material and workmanship on the date of sale by an authorized Graco distributor to the original purchaser for use. With the exception of any special, extended, or limited warranty published by Graco, Graco will, for a period of twelve months from the date of sale, repair or replace any part of the equipment determined by Graco to be defective. This warranty applies only when the equipment is installed, operated and maintained in accordance with Graco's written recommendations.

This warranty does not cover, and Graco shall not be liable for general wear and tear, or any malfunction, damage or wear caused by faulty installation, misapplication, abrasion, corrosion, inadequate or improper maintenance, negligence, accident, tampering, or substitution of non-Graco component parts. Nor shall Graco be liable for malfunction, damage or wear caused by the incompatibility of Graco equipment with structures, accessories, equipment or materials not supplied by Graco, or the improper design, manufacture, installation, operation or maintenance of structures, accessories, equipment or materials not supplied by Graco.

This warranty is conditioned upon the prepaid return of the equipment claimed to be defective to an authorized Graco distributor for verification of the claimed defect. If the claimed defect is verified, Graco will repair or replace free of charge any defective parts. The equipment will be returned to the original purchaser transportation prepaid. If inspection of the equipment does not disclose any defect in material or workmanship, repairs will be made at a reasonable charge, which charges may include the costs of parts, labor, and transportation.

THIS WARRANTY IS EXCLUSIVE, AND IS IN LIEU OF ANY OTHER WARRANTIES, EXPRESS OR IMPLIED, INCLUDING BUT NOT LIMITED TO WARRANTY OF MERCHANTABILITY OR WARRANTY OF FITNESS FOR A PARTICULAR PURPOSE.

Graco's sole obligation and buyer's sole remedy for any breach of warranty shall be as set forth above. The buyer agrees that no other remedy (including, but not limited to, incidental or consequential damages for lost profits, lost sales, injury to person or property, or any other incidental or consequential loss) shall be available. Any action for breach of warranty must be brought within two (2) years of the date of sale.

GRACO MAKES NO WARRANTY, AND DISCLAIMS ALL IMPLIED WARRANTIES OF MERCHANTABILITY AND FITNESS FOR A PARTICULAR PURPOSE, IN CONNECTION WITH ACCESSORIES, EQUIPMENT, MATERIALS OR COMPONENTS SOLD BUT NOT MANUFACTURED BY GRACO. These items sold, but not manufactured by Graco (such as electric motors, switches, hose, etc.), are subject to the warranty, if any, of their manufacturer. Graco will provide purchaser with reasonable assistance in making any claim for breach of these warranties.

In no event will Graco be liable for indirect, incidental, special or consequential damages resulting from Graco supplying equipment hereunder, or the furnishing, performance, or use of any products or other goods sold hereto, whether due to a breach of contract, breach of warranty, the negligence of Graco, or otherwise.

FOR GRACO CANADA CUSTOMERS

The Parties acknowledge that they have required that the present document, as well as all documents, notices and legal proceedings entered into, given or instituted pursuant hereto or relating directly or indirectly hereto, be drawn up in English. Les parties reconnaissent avoir convenu que la rédaction du présente document sera en Anglais, ainsi que tous documents, avis et procédures judiciaires exécutés, donnés ou intentés, à la suite de ou en rapport, directement ou indirectement, avec les procédures concernées.

Graco Information

TO PLACE AN ORDER, contact your Graco distributor, or call this number to identify the distributor closest to you:

1-800-367-4023 Toll Free

612-623-6921

612-378-3505 Fax

*All written and visual data contained in this document reflects the latest product information available at the time of publication.
Graco reserves the right to make changes at any time without notice.*

MM 309852

Sales Offices: Minneapolis, Detroit

International Offices: Belgium Korea, Hong Kong, Japan

GRACO INC. P.O. BOX 1441 MINNEAPOLIS, MN 55440-1441

www.graco.com

Printed in USA 309852B

4/2006