

Accessory Display Kit

309826 rev. D



INSTRUCTIONS

This manual contains important warnings and information.
READ AND KEEP FOR REFERENCE.

287098, Series A – Ultra 395/495/595; Ultimate Nova 395; Ultimate Super Nova 495/595; ST Max 395/495/595; Performance Max 395/495/595; FinishPro 395

287904, Series A – Ultra Max 490/495/595; Ultimate MXII 490/495/595; ST Max II 490/495/595

Pressure Relief Procedure

WARNING



INJECTION HAZARD

System pressure must be manually relieved to prevent system from starting or spraying accidentally. Fluid under high pressure can be injected through skin and cause serious injury. To reduce risk of injury from injection, splashing fluid, or moving parts, follow **Pressure Relief Procedure** whenever you:

- are instructed to relieve pressure,
- stop spraying,
- check or service any system equipment,
- or install or clean spray tip.

1. Lock gun safety latch.
2. Turn ON/OFF switch to OFF.
3. Unplug power supply cord.
4. Unlock gun safety latch. Hold metal part of gun firmly to grounded metal pail. Trigger gun to relieve pressure.
5. Lock gun safety latch.
6. Open pressure drain valve. Leave pressure drain valve open until ready to spray again.

If suspected that spray tip or hose is completely clogged, or that pressure has not been fully relieved after following steps above, VERY SLOWLY loosen tip guard retaining nut or hose end coupling to relieve pressure gradually, then loosen completely. Now clear tip or hose obstruction.

Install

CAUTION

Electrostatic discharges can damage components on PC board. Use a ground strap when handling or installing PC board.

Using configurations other than those specified at right results in poor sprayer performance.

1. Follow **Pressure Relief Procedure**.
2. Remove four screws (12) and existing pressure control cover.
3. Plug digital display cable (A) into control board connector (B).
4. Install digital display cover (50) with four screws (12).

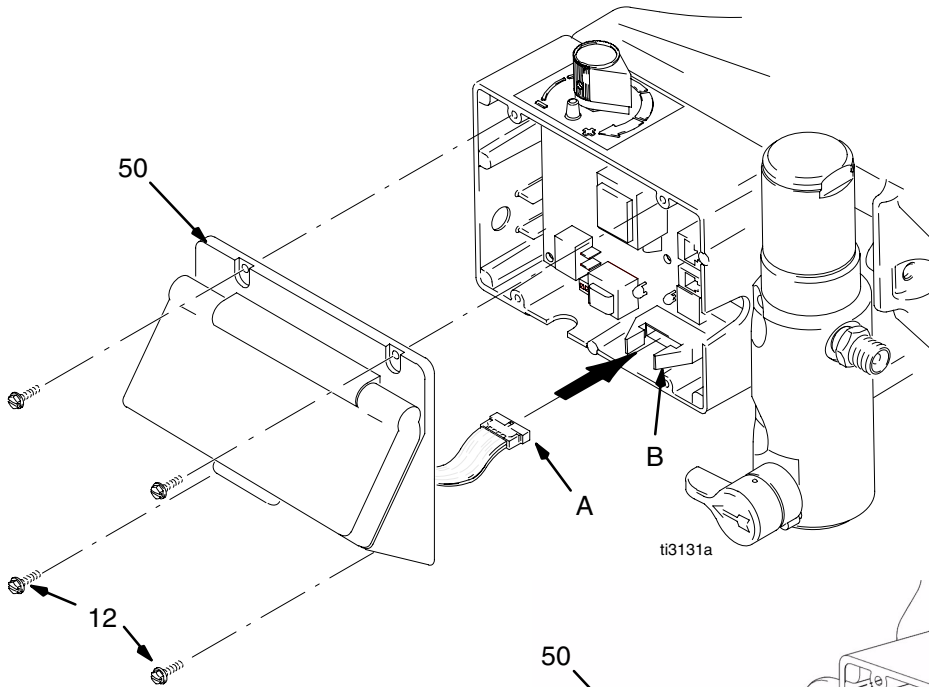

Part No. 287098

Part No. 287904

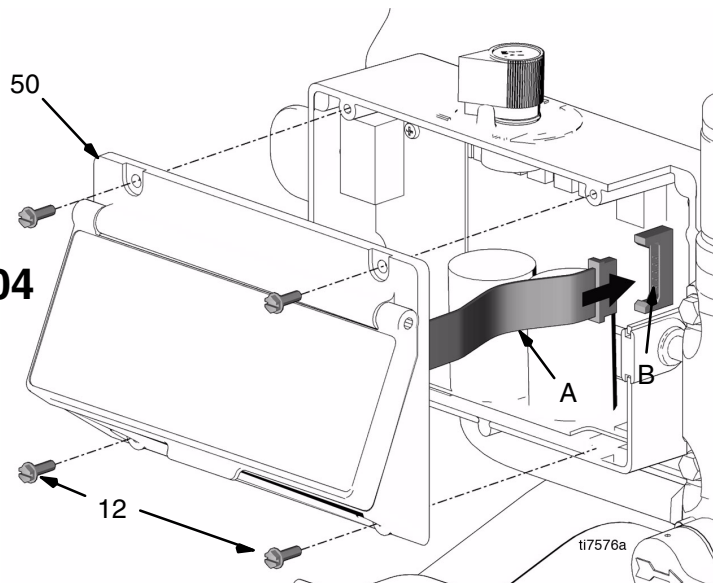

TO PLACE AN ORDER OR FOR SERVICE, contact your Graco distributor, or call 1-800-690-2894 to identify the nearest distributor.

*All written and visual data contained in this document reflects the latest product information available at the time of publication.
Graco reserves the right to make changes at any time without notice.*

Sales Offices: Minneapolis

International Offices: Belgium, Korea, China, Japan

GRACO INC. P.O. BOX 1441 MINNEAPOLIS, MN 55440-1441

www.graco.com

309826 01/2003, Revised 3/2007