

246013 Hour Meter Kit

309541 rev.A

32–277 VAC, 0.25 mA, Flash Setting 40 hours



Read all warnings and instructions.

WARNING



ELECTRIC SHOCK HAZARD

Failure to observe the electrical hazards described below could result in serious injury, including electrocution.

To help prevent harmful electrical shock:

- Unplug sprayer when performing any maintenance or repair.
- Follow all grounding instructions in your sprayer instruction manual.
- Comply with all local, state, and national fire, electrical, and safety regulations.

Resetting the Hour Meter

The Hour Meter display blinks after 40 hours of motor run time; the average pump packing life. The blinking display signals the user that the pump packings should be replaced (See Pump Repair Manual 309060 for packing replacement instructions).

After the pump packings have been replaced, reset the Hour Meter:

- Touch and hold tip of reset tool (supplied) to indicated meter reset area until display stops blinking and “SVC” indicator disappears.

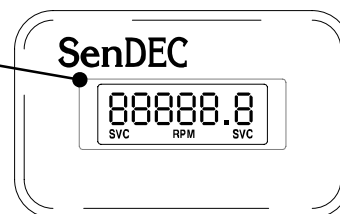

ti2209a

NOTE: The number of hours displayed is cumulative and will not reset to 0 (zero).

After 40 hours of use the Hour Meter display will blink again, reminding the user to replace the pump packings.

Wiring Diagram

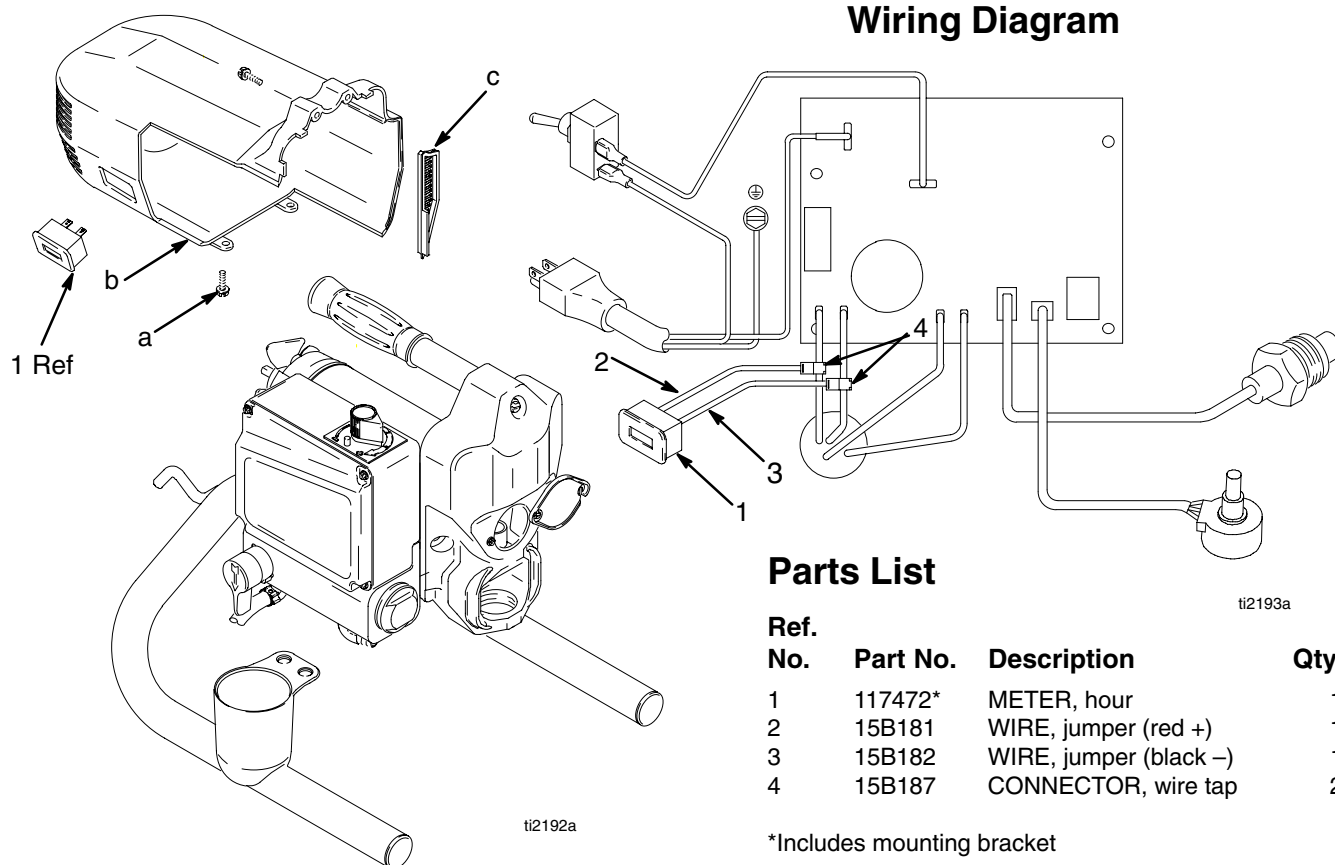

Parts List

Ref. No.	Part No.	Description	Qty.
1	117472*	METER, hour	1
2	15B181	WIRE, jumper (red +)	1
3	15B182	WIRE, jumper (black -)	1
4	15B187	CONNECTOR, wire tap	2

*Includes mounting bracket

Disassembly

1. Remove motor shroud screws (a).
2. Slide motor shroud (b) back 3–4 inches.
3. Disconnect Hour Meter leads (2 & 3) from wire taps (4).
4. Remove motor shroud (b) completely.
5. Disconnect jumper wires (2 & 3) from back of Hour Meter (1).
6. Remove mounting bracket from back of Hour Meter (1).
7. Slide Hour Meter (1) out of mounting hole in motor shroud.

3. If necessary, attach wire taps (4) to motor leads.
4. Slide motor shroud partially over motor.
5. Connect Hour Meter leads to wire taps.

Note: The black Hour Meter lead connects to wire tap on black motor wire. The red Hour Meter lead connects to red motor wire tap.

6. Slide motor completely over motor, making sure there are no wires protruding outside of shroud and/or pinched in motor fan blade.
7. Secure motor shroud.
8. To verify the Hour Meter was assembled correctly, carefully turn on sprayer and run pump. When the motor is running the hourglass indicator on the side of the Hour Meter display should blink. If this does not occur, check wire connections.

Assembly

1. Insert Hour Meter in mounting hole on motor shroud.
2. Secure with supplied bracket.

All written and visual data contained in this document reflects the latest product information available at the time of publication. Graco reserves the right to make changes at any time without notice.

Sales Offices: Minneapolis, Detroit
International Offices: Belgium, Korea, Hong Kong, Japan

GRACO INC. P.O. BOX 1441 MINNEAPOLIS, MN 55440-1441

www.graco.com

PRINTED IN USA 309541 06/2002