

Instructions



For use with ProDispense™ controller

Fluid Panels

309399 Rev.B



See ProDispense system manual 309301
for warnings, instructions and parts list.

Part No. 244599

Oil/Lubricant Fluid Panel

1500 psi (10 MPa, 103 bar) Maximum Working Pressure

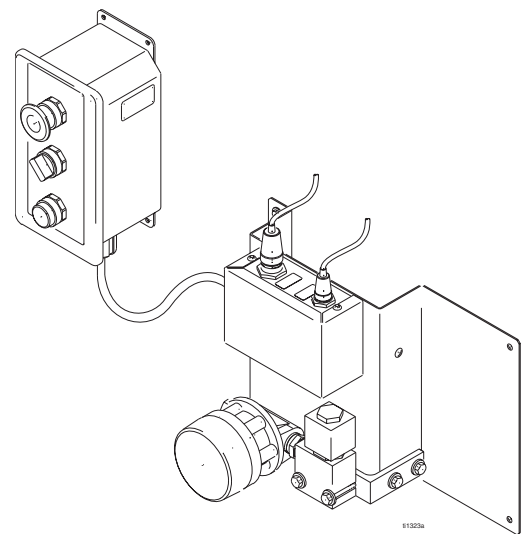

Part No. 244600

Water/Antifreeze Fluid Panel

250 psi (1.7 MPa, 17 bar) Maximum Working Pressure

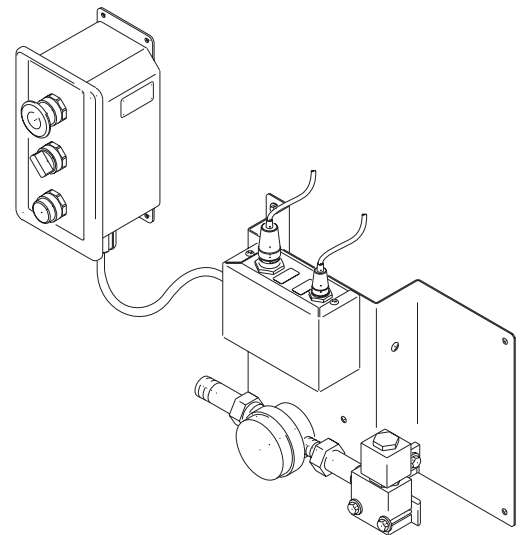

PROVEN QUALITY. LEADING TECHNOLOGY.

Part No. 244601 (G3000 HR)

Grease/Paint Fluid Panel

3000 psi (21 MPa, 207 bar) Maximum Working Pressure

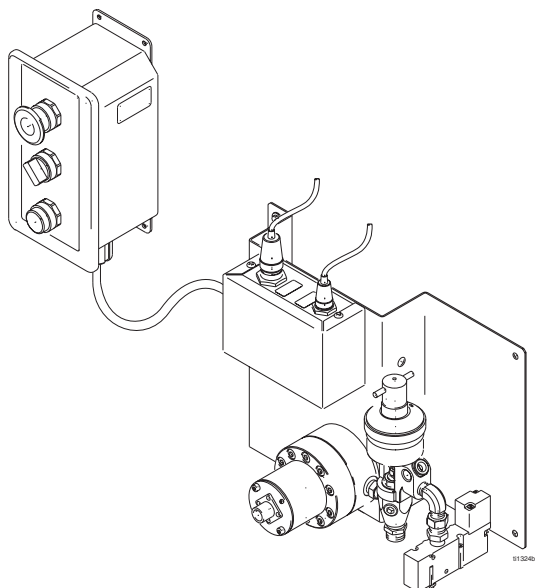

Part No. 246838

Grease/Paint Fluid Panel (no meter)

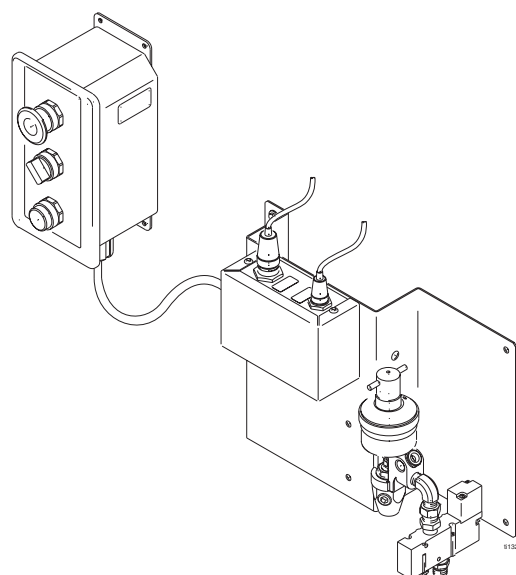

Part No. 246837 (G3000 HR)

Grease/Paint Fluid Panel

3000 psi (21 MPa, 207 bar) Maximum Working Pressure

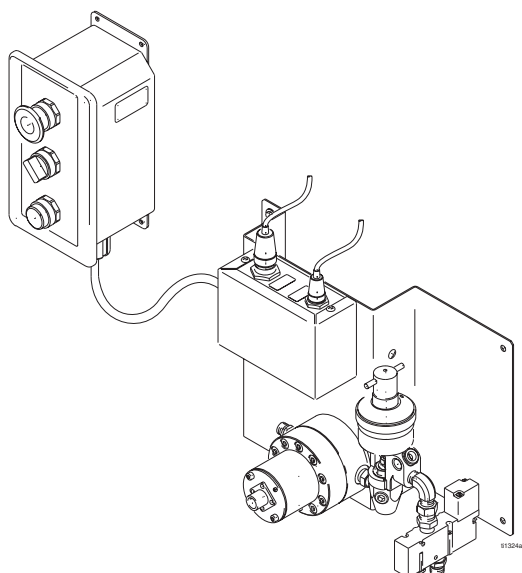

Part No. 246839

Grease/Paint Fluid Panel (Helical Meter)

3000 psi (21 MPa, 207 bar) Maximum Working Pressure

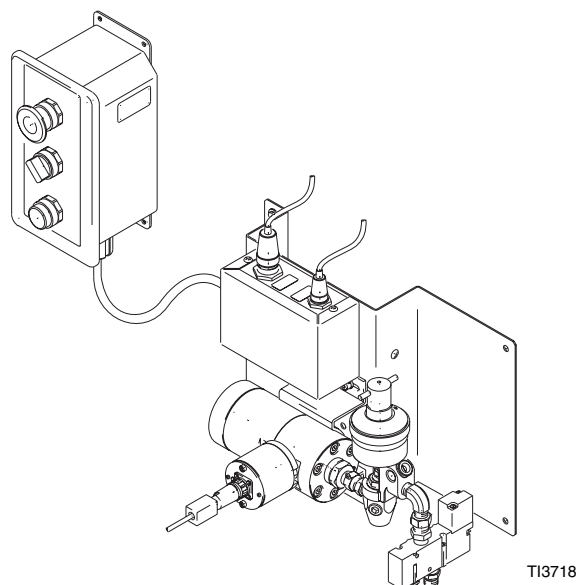

All written and visual data contained in this document reflects the latest product information available at the time of publication.
Graco reserves the right to make changes at any time without notice.

Sales Offices: Minneapolis, Detroit
International Offices: Belgium, Korea, Hong Kong, Japan
GRACO INC. P.O. BOX 1441 MINNEAPOLIS, MN 55440-1441
www.graco.com
Printed in USA 309399B
6/2003