

Instructions



309394

Rev. A



Read and keep for reference. For detailed instructions and warnings, see manual 309300.

Dispense Valve Kit 244792

For installing additional dispense valves on the ProBatch™ system. Dispense valve must be ordered separately.

Kit includes:

Ref. #	Part No.	Description	Qty.
1	513308	Fitting, 1/4 npt x 3/8 OD tube	1
2	244375	Fluid Pressure Regulator	1
3	115942	Hex Nut, 1/4-20 UNC	2
4	510223	Elbow Fitting, 1/4 npt x 3/8 OD tube	1
5	116369	Nut, 3/8-18 npt	1
6	598095	Nylon Tube, 5/32 OD, 4 ft. (1.22 m).	1
7	597350	PTFE Tube, 3/8 OD, 3 ft. (0.9 m)	

Installing Dispense Valve Kit



To reduce the risk of injury from pressurized fluid or electric shock, before servicing equipment:

- Relieve pressure as instructed in manual 309300.
- Turn off ProBatch power switch and disconnect electrical power supply.

1. Purge ProBatch system and relieve pressure as instructed in manual 309300.
2. Turn off ProBatch power switch and disconnect electrical power supply.
3. Loosen the four screws and remove front manifold cover.



If the regulator is being installed in either of the two top ports, remove the control box as instructed in manual 309300. Install regulator through top service cutout behind control box.

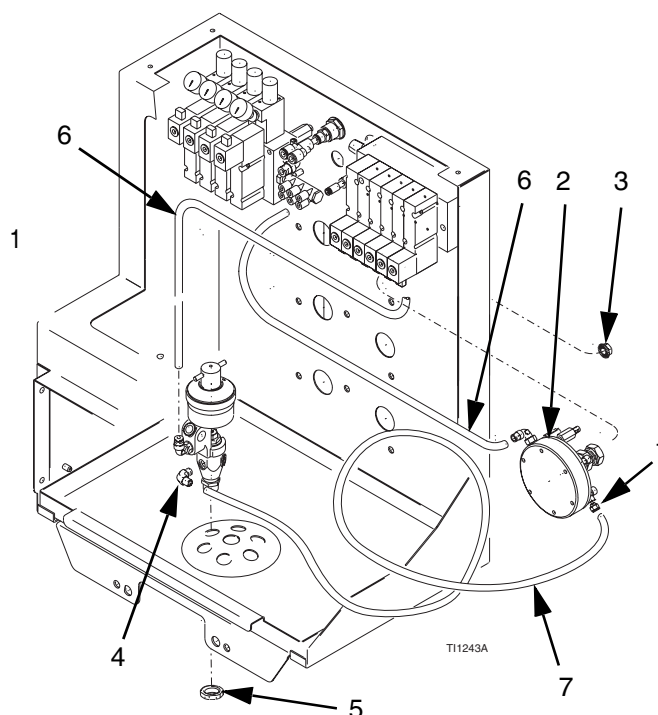

FIG. 1

4. Apply anaerobic pipe sealant to the fitting (1) threads and install fitting into 1/4" regulator outlet. See FIG. 1.
5. Install regulator (2) in desired port and secure it with the two hex nuts (3).

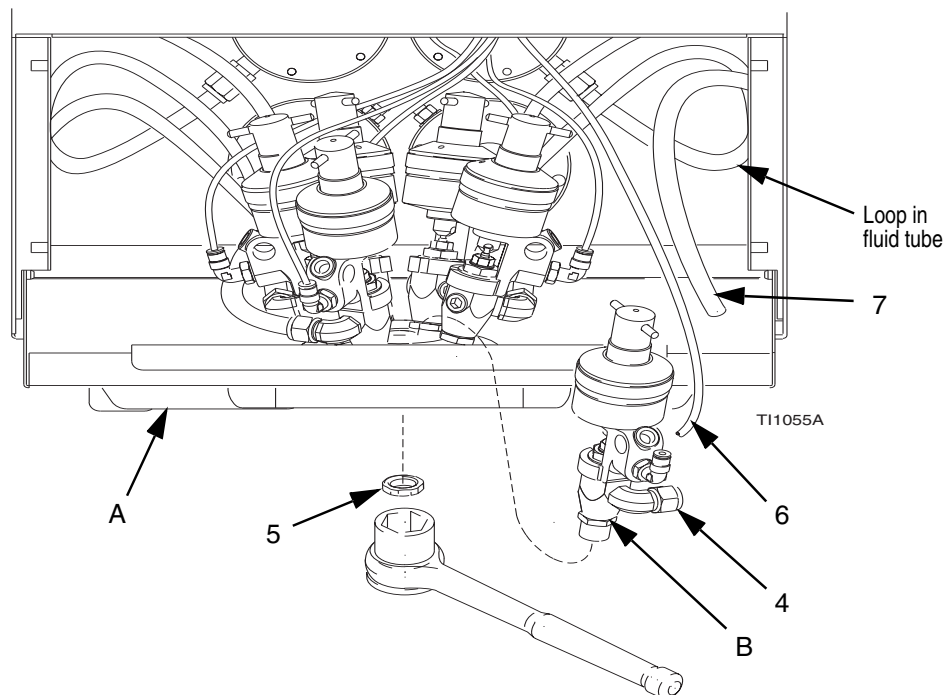

FIG. 2

6. Slide out dispense valve tray (A). Tip down and hook the notch on the pin to hold tray in place. See **FIG. 2**.
7. Install elbow fitting (4) in dispense valve (B) fluid inlet.
8. Install dispense valve (B) in desired port in the tray and secure it with the nut (5), using a 7/8" 6-point socket wrench. Be sure that PTFE-coated side of nut (5) faces the valve.



*Cut tubing (7 and 6) to length needed. Place a loop in the fluid tube (7) as shown in **FIG. 2** to avoid crimping it.*

9. Connect PTFE fluid tube (7) between dispense valve fitting (4) and regulator fitting (1). See **FIG. 1**.
10. Connect one piece of nylon tube (6) between regulator air inlet and the solenoid manifold tube fitting.
11. Connect other piece of nylon tube (6) between dispense valve air inlet (4) and corresponding solenoid valve.