



INSTRUCTIONS

This manual contains important  
warnings and information.  
**READ AND KEEP FOR REFERENCE**

Part No. 244913

## ES ON/OFF Valve Conversion Kit

For PRO™ Xs3 and PRO™ Xs4 Electrostatic Air Spray Guns

Converts the gun's ES ON/OFF valve to a constant ON setting, ensuring that an electrostatic charge will be present whenever the gun is triggered. The ball valve included in the kit shuts off all air to the gun when flushing or relieving pressure.

### **WARNING**

#### **Pressurized Equipment Hazard**

Before installing this kit, follow the **Pressure Relief Procedure** below to reduce the risk of fire, explosion, electric shock, and splashing of fluid in the eyes or on the skin.

#### **Pressure Relief Procedure**

1. Turn the ES ON/OFF valve OFF.

**NOTE:** After this kit is installed, shut off the air line ball valve to turn the gun's electrostatics off.

2. *Xs3 waterborne gun only:* Discharge the electrical charge.
3. Turn off the air bleed valves to the fluid source and to the gun.
4. Trigger the gun into a grounded metal waste container to relieve the fluid pressure.
5. Open the pump drain valve, having a waste container ready to catch the drainage. Leave the pump drain valve open until you are ready to spray again.

6. If the nozzle or hose is completely clogged or pressure is not fully relieved, slowly loosen the hose end coupling. Now clear the nozzle or hose

#### **Disassembly**

1. Loosen the screw (A) with a 5/32 in. hex allen wrench.
2. Remove the valve knob (B) from the gun handle.

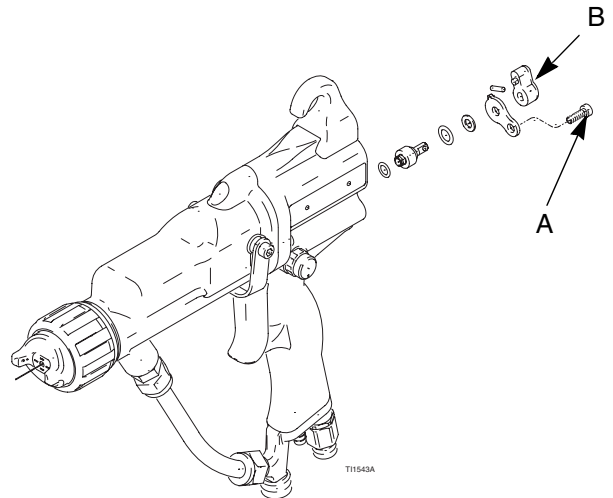

**Fig. 1: Remove the Old ES ON/OFF Valve**

## Install the Kit

1. Lubricate the o-ring on the plug assembly with petroleum jelly. Install the plug into the gun handle and secure with the screw (A).
2. Install the ball valve (2) at the gun air inlet, as shown. The ball valve has left-hand threads.
3. Connect the Graco Grounded Air Supply Hose (C) to the ball valve.

### **WARNING**

#### **Fire, Explosion, and Electric Shock Hazard**

To reduce the risk of fire, explosion, and electric shock, the gun air supply hose must be electrically connected to a true earth ground. Use only the Graco Grounded Air Supply Hose.

4. Check the electrical grounding as instructed in your gun repair manual.

### **WARNING**

#### **Fire, Explosion, and Electric Shock Hazard**

To reduce the risk of fire, explosion, and electric shock, always shut off the air line ball valve (2) installed with this kit when flushing or relieving pressure. Shutting off the air line ball valve turns off the gun's electrostatics.

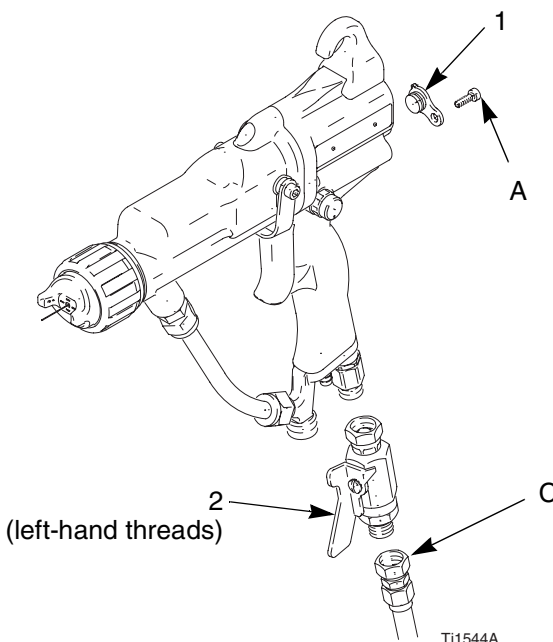

**Fig. 2: Install the Kit**

## Parts List

Ref. No.	Part No.	Description	Qty
1	244922	PLUG, always on, ES	1
2	224754	VALVE, ball; 1/4 npsm; left-hand threads	1

## Graco Phone Numbers

**TO PLACE AN ORDER**, contact your Graco distributor,  
or call one of these numbers  
to identify the distributor closest to you:  
**1-800-367-4023 Toll Free**  
**612-623-6921**  
**612-378-3505 Fax**

*All written and visual data contained in this document reflects the latest product information available at the time of publication. Graco reserves the right to make changes at any time without notice.*

**Sales Offices:** Minneapolis, Detroit  
**International Offices:** Belgium, Korea, Hong Kong, Japan  
**GRACO INC. P.O. BOX 1441 MINNEAPOLIS, MN 55440-1441**  
**www.graco.com**  
**PRINTED IN USA 309358 09/2001**