

INSTRUCTIONS–PARTS LIST



309357 rev.D



Important Safety Instructions

Read all warnings and instructions in this manual. Save these instructions.

US Patent Pending

HVLP Compressor Gun

Pressure Feed Gun for Use With HVLP V–Comp Spray System

135 psi (0.93 MPa, 9.3 bar) Maximum Inlet Air Pressure

50 psi (0.35 MPa, 3.5 bar) Maximum Inlet Fluid Pressure

Related Manuals

309245 – HVLP–V–Comp Spray System

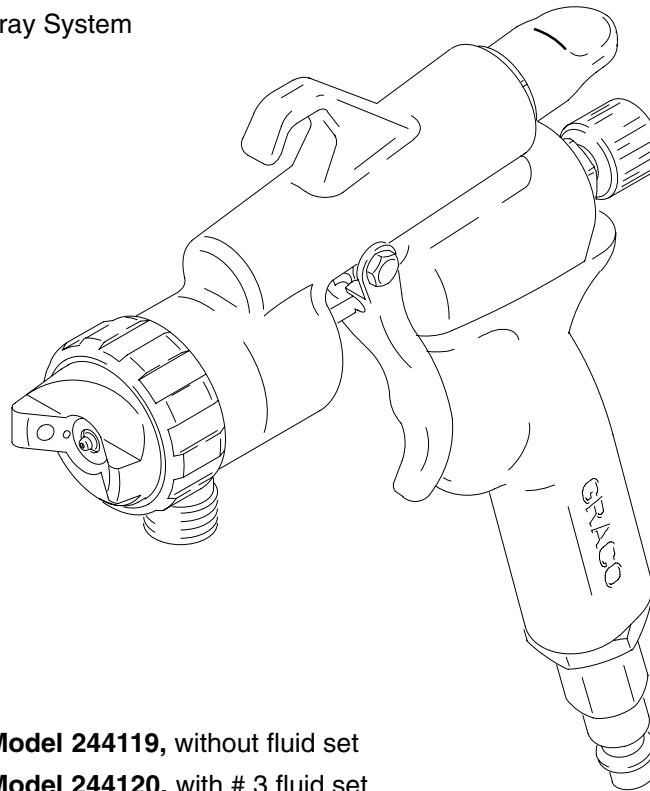

Model 244119, without fluid set

Model 244120, with # 3 fluid set

TI1320A

GRACO INC. P.O. BOX 1441 MINNEAPOLIS, MN 55440–1441

©COPYRIGHT 2001, GRACO INC.

Graco Inc. is registered to I.S. EN ISO 9001

Table of Contents

Symbols	2
Warnings	3
Component Identification	4
Setup	7
Spray	7
Shutdown	8
Technical Data	14
Graco Phone Number	16

Warning Symbol



This symbol alerts you to the possibility of serious injury or death if you do not follow instructions.

Caution Symbol



This symbol alerts you to the possibility of damage to or destruction of equipment if you do not follow instructions.

You will need:

Cleaning fluids: a compatible solvent; water-based paint also requires soap and water.

Suggested proper clothing:

- Safety glasses
- Sturdy boots or shoes
- Respirator
- Gloves



WARNINGS

KNOW ALL HAZARDS BEFORE OPERATING SPRAYER!

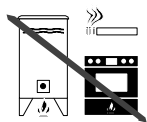

Fire and explosion hazard: Solvent and paint fumes can ignite or explode.

- Sprayers generate sparks. Keep sprayer at least 20 feet (6 m) from explosive vapors.
- **Use in an extremely well ventilated area.**
- Eliminate all ignition sources; such as pilot lights, cigarettes and static arcs from plastic drop cloths. Do not plug or unplug power cords or turn lights on or off in spray area.
- Ground Sprayer, object being sprayed, paint and solvent pails.
- Do not use 1,1,1-trichloroethane, methylene chloride, other halogenated hydrocarbon solvents or fluids containing such solvents in pressurized aluminum equipment. Such use could result in a chemical reaction, with the possibility of explosion.



INSTRUCTIONS

Equipment Misuse Hazard: Equipment misuse can cause the equipment to rupture or malfunction and result in serious injury.

- Before operating equipment, read all instruction manuals, tags, and labels.
- Check equipment daily. Repair or replace worn or damaged parts immediately.
- Do not exceed maximum working pressure (MWPR) of the lowest-rated system component.
- Use fluids and solvents that are compatible with the equipment wetted parts.
- Wear hearing protection when operating this equipment.
- Do not "blow back" fluid; this is not an air spray system.
- Follow **Pressure Relief** before cleaning, checking or servicing the equipment.



TOXIC FLUID HAZARD: Hazardous fluid or toxic fumes can cause serious injury or death if splashed in eyes or on skin, inhaled, or swallowed.

- Know specific hazards of fluid you are using and take protective measures as recommended by the fluid and solvent manufacturer.

Component Identification

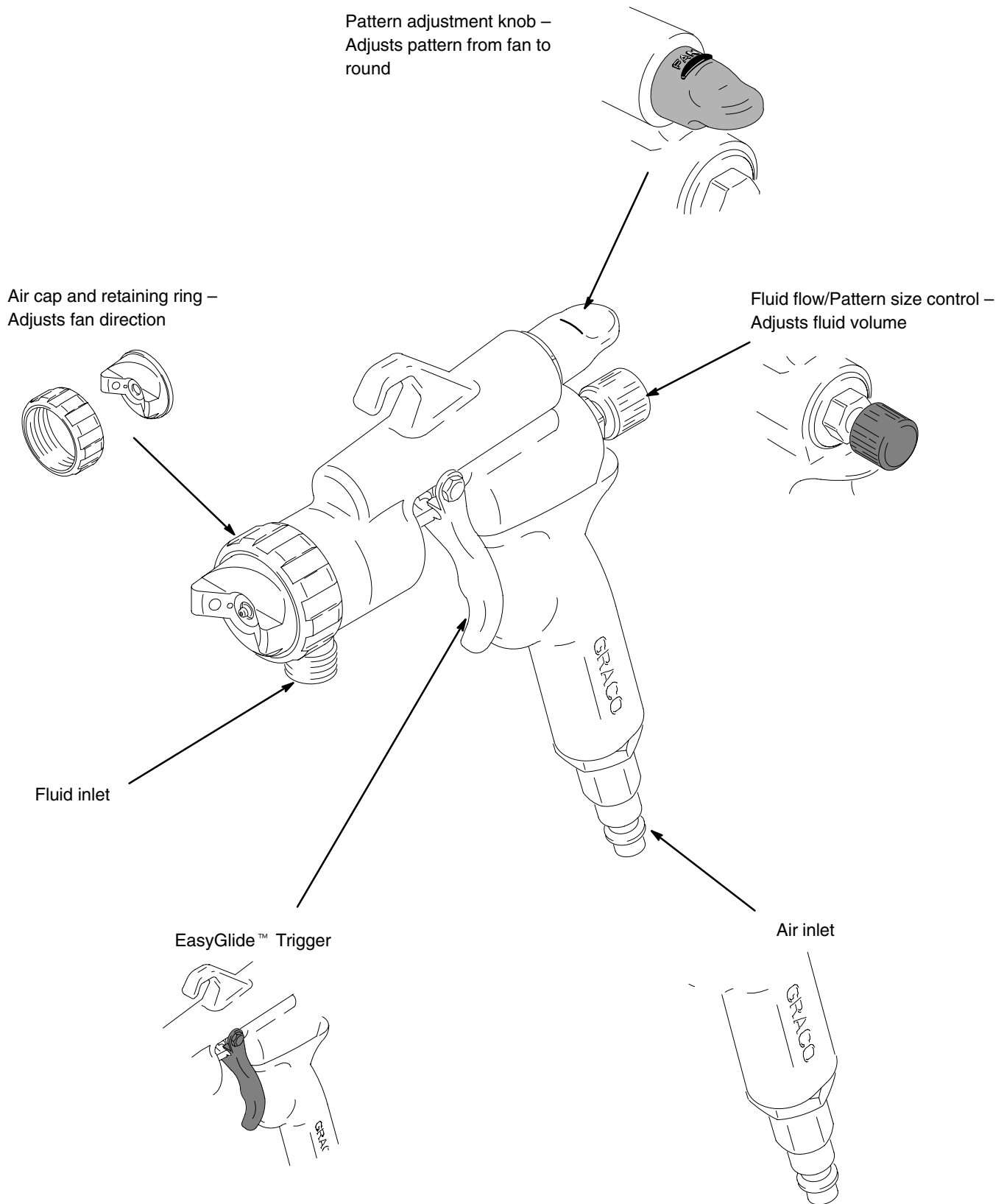

PRESSURE RELIEF – Follow this procedure when cleaning, repairing or shutting down sprayer



Follow these instructions whenever you stop spraying.

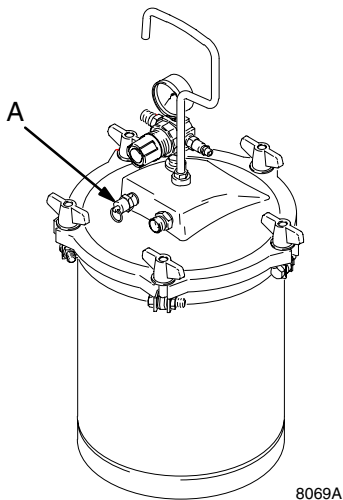

8069A

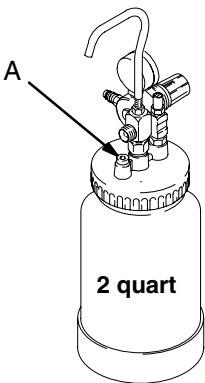

1. Turn off air supply to the pot.
2. Open pressure relief (A) on pot until pressure is completely relieved. Close relief.

NOTE: All material and pressure noted in Selection Guide (below) are to be used with a #3 fluid set.

Material / Pressure Selection Guide						
Material	* Spray Air Pressure					
	10 psi	20 psi	30 psi	40 psi	50 psi	60 psi
Dye						
Ink						
Non-Wiping Stain						
Automotive Finish						
Lacquer						
Stain						
Enamel						
Epoxy						
Urethane						
Varnish						
Primer						
Industrial Finishes						
Latex						
Multi-Spec						
Butyrate						
Nitrate Dope						
Oil Wall Paint						

Note:
For best quality paint pattern at low pressures follow paint manufacturer's recommendation for thinning.
Read instruction manual for additional information.
* Spray Air Pressure with gun not triggered.

HVLP Spray

Air Spray

198401, Rev. B

Fig. 1

Replacing the Fluid Set

CAUTION

Trigger the gun whenever you tighten or remove the nozzle. This keeps the needle away from the nozzle sealing surface and prevents it from being scratched.

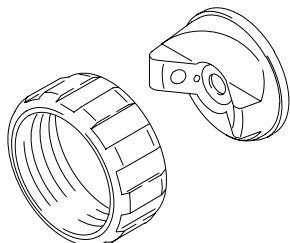

1. Use your hand to loosen and remove the air cap retaining ring and air cap housing.

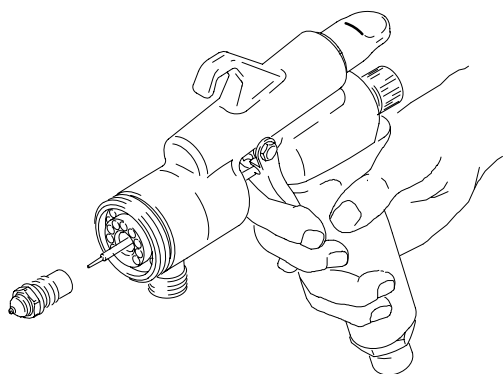

2. **While triggering the gun**, use your hand to loosen and remove the nozzle.

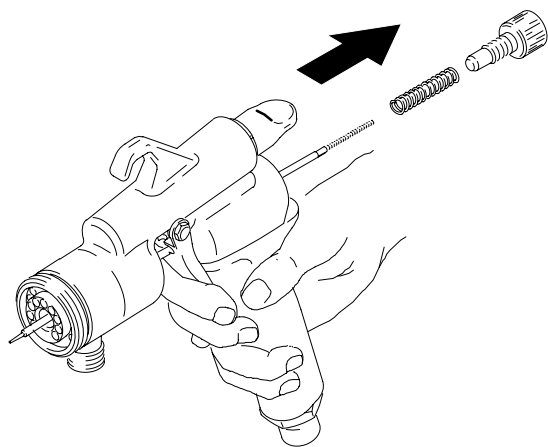

3. Use your hand to loosen and remove the fluid knob assembly and compression spring from the back of the gun. Remove the old needle.

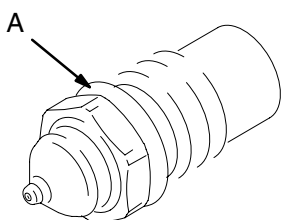

4. Insert new needle assembly in the back of the gun. Reassemble fluid knob and spring, nozzle, air cap housing and air cap retaining ring. Hand tighten.

NOTE: Only use a #3 fluid set with pressure feed guns.

Note: Nozzle should always have an o-ring (A).

Setup

1. Connect .375 in. (9.53 mm) diameter air hose to gun and compressor.
Connect 0.25 in. (6.35 mm) diameter air hose to pressure pot and compressor.

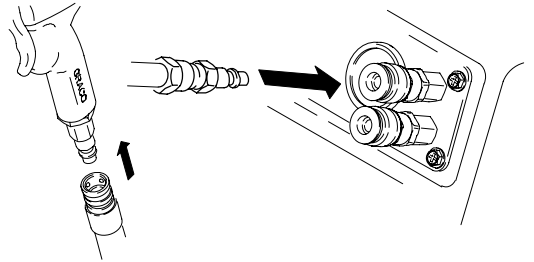

ti1321a

2. Connect fluid hose to gun and pressure pot.

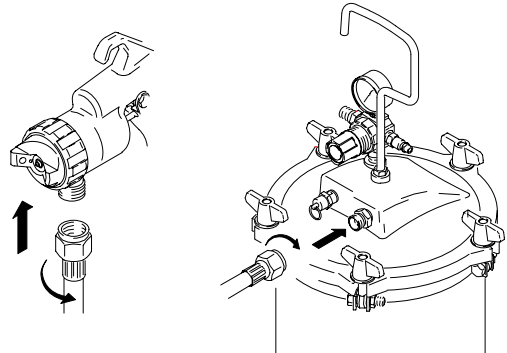

ti1321a

For remote pressure pot, hold gun parallel to floor and adjust fluid pressure to an 8 to 10 inch (203 to 254 mm) fluid stream.

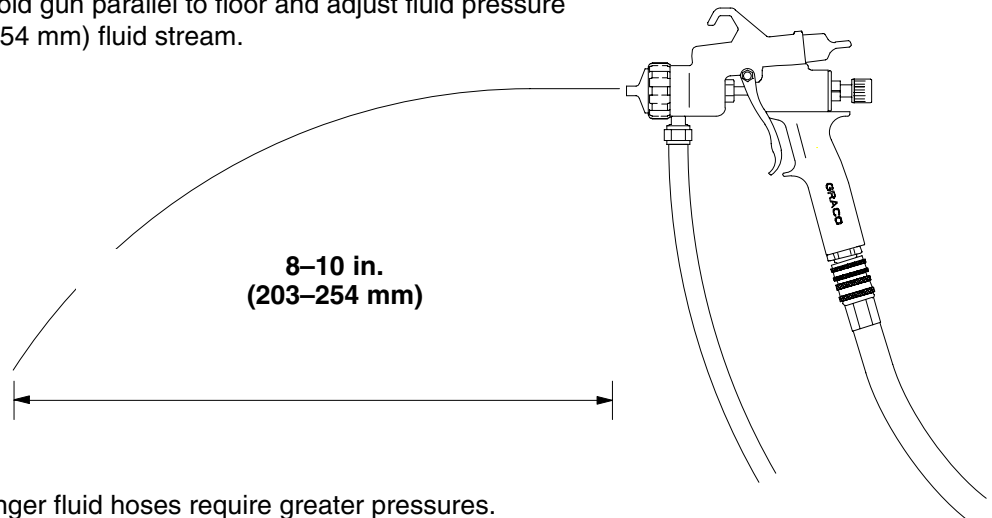

NOTE: Heavier fluids or longer fluid hoses require greater pressures.

Reduce and test catalyze all paint to manufacturer's specifications.

- If no reduction instructions are given, mix fluid thoroughly. Gradually mix in reducer. To check fluid consistency: remove stir stick from thinned paint. When paint streaming off stick breaks into droplets, first few drops should be one second apart.
- To compensate for faster drying time of compressor-based systems, use a reducer one step slower than used for conventional air spray systems.

Setup

3. Plug power cord into a grounded outlet.

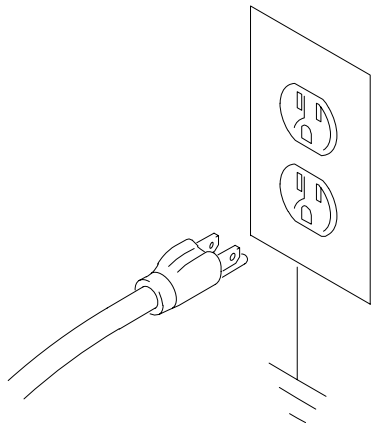

SPRAY

1. Turn power switch on. Allow sprayer to run until the motor stops and maximum tank pressure is reached.

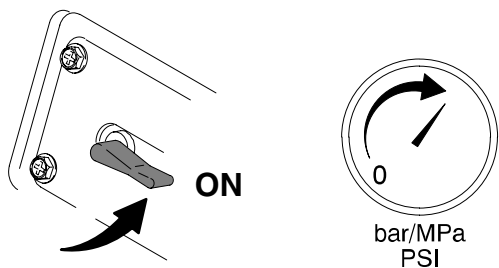

2. Turn air cap to obtain desired fan pattern direction.

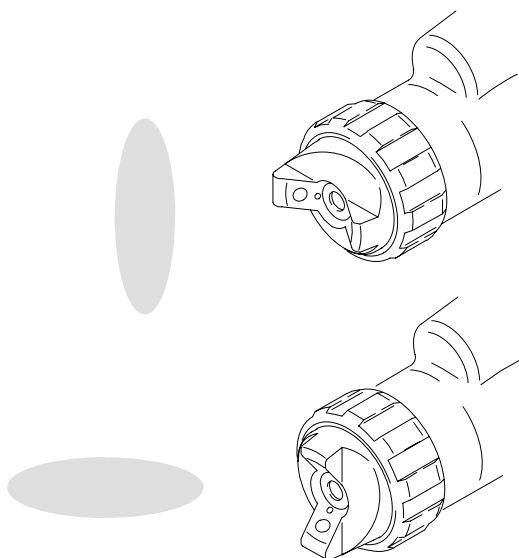

-
3. Hold aircap in place by tightening retaining ring.

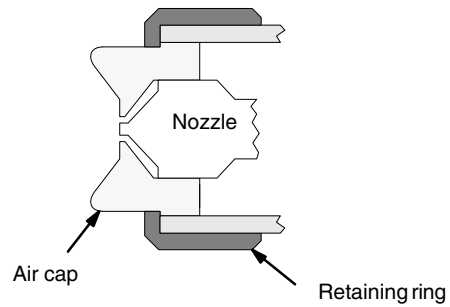

-
4. Select spray pattern by adjusting the fluid knob and pattern adjustment knob.

Round Pattern
Set knob to RND



Vertical Pattern
Set knob to FAN



Horizontal Pattern
Set knob to FAN

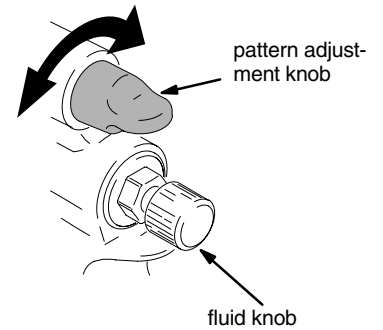

Note: If fluid is not atomizing properly, fluid may need to be thinned further, or a different tip size may be used.

-
5. Hold gun perpendicular, 6–8 inches from surface.
Move gun first, then pull gun trigger to spray.

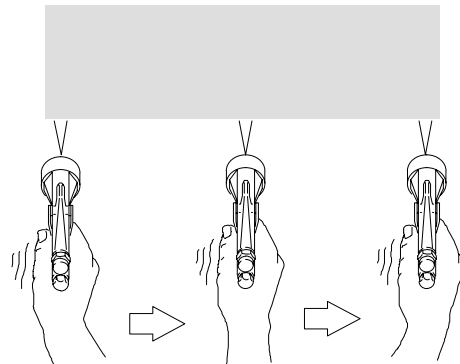

-
6. To control over-spray, reduce fluid volume.

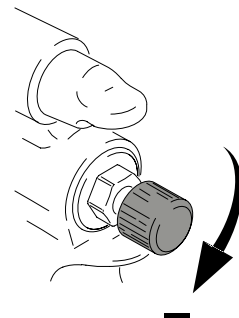

Note: If fluid is not atomizing properly, fluid may need to be thinned further, or a different tip size may be used.

Shutdown

Cleaning the Spray Gun



1. Perform **Pressure Relief Procedure**. Empty excess material from pressure pot.

-
2. Add compatible cleaning solvent or soapy water (water base) to pot.

-
3. Turn fan control to round spray pattern.

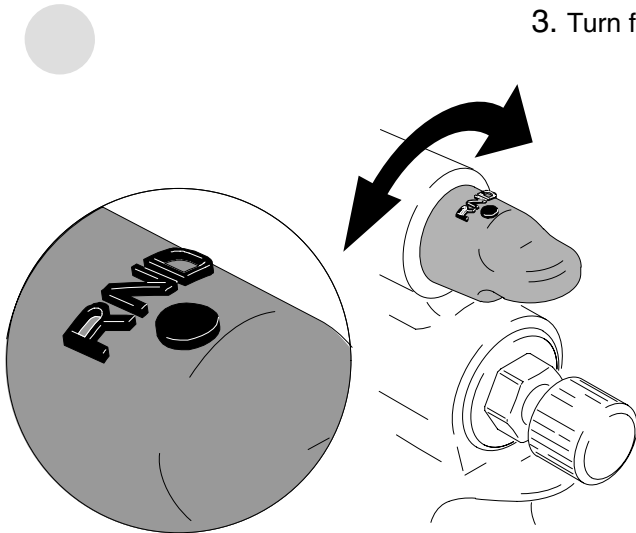

-
4. Trigger gun until solvent or soapy water (water base) runs clean.

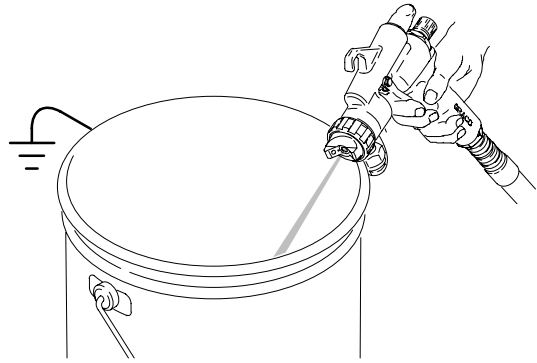

-
5. Turn power switch to off.

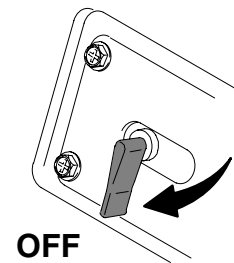

-
6. **Perform Pressure Relief.** Properly dispose of excess solvent in accordance with local regulations.



Parts for HVLP V-COMP Gun

Models 244119, 244120

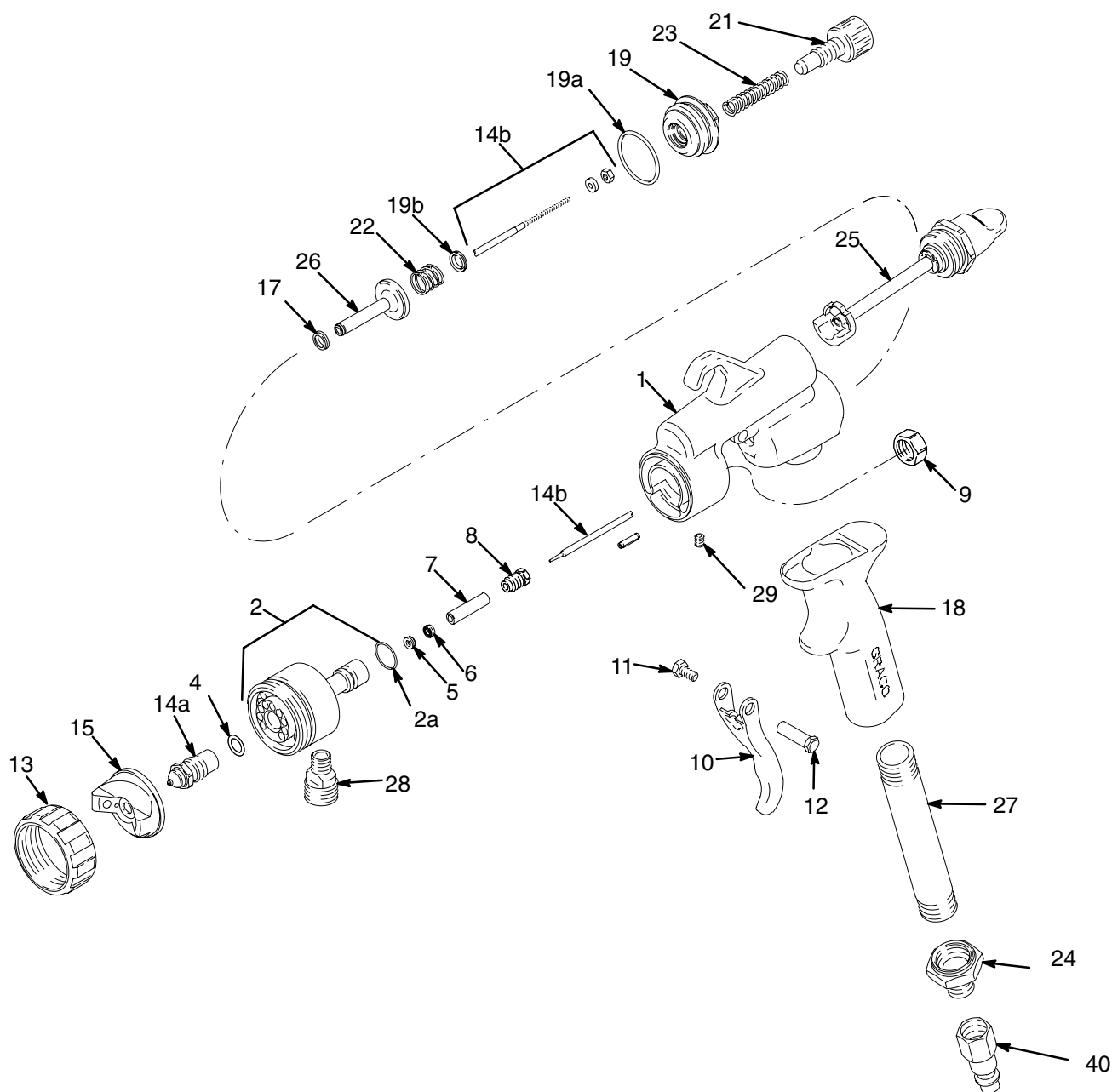

T10745

Parts for HVLP V-COMP GUN

Models 244119, 244120

Ref. No.	Part No.	Description	Qty.	Ref. No.	Part No.	Description	Qty.
1	244427	BODY, gun	1	25	244191	VALVE, fan, compressor	1
2	244430	HOUSING, nozzle (with packings)	1	26	243842	VALVE, air	1
2a	112085	PACKING, o-ring	1	27	196463	TUBE, handle	1
4†	113137	PACKING, o-ring	1	28	196468	FITTING, adapter	1
5	188494	SPREADER, u-cup,	1	29	M71149	SCREW, set	1
6	188495	PACKING, u-cup	1	31	197457▲	LABEL, instruction	1
7	196438	SPACER, packing	1	33	M70613	BRUSH, cleaning (not shown)	1
8	192352	SCREW, packing	1	34	070303	LUBRICANT, grease (not shown)	1
9	192348	NUT, hex; 1/2-20 UNF	1	35	197448	TOOL, wrench (not shown)	1
10	196439	TRIGGER	1	40	169967	FITTING, line, air	1
11	203953	SCREW, cap, hex head	1	▲ Replacement instruction and warning labels are available at no cost. † Model 244120 only			
12	192272	PIN, pivot	1				
13	196415	RING, retaining, air cap	1				
14†	244124	FLUID SET, #3	1				
14a		NOZZLE, fluid, #3	1				
14b		NEEDLE ASSY	1				
15†	244229	AIR CAP, compressor gun	1				
17	188493	PACKING, u-cup, gun	1				
18	196462	HANDLE, gun	1				
19	244428	HOUSING, valve, fluid (with packings)	1				
19a	110066	PACKING, o-ring	1				
19b	110453	PACKING, u-cup	1				
21	196649	KNOB, fluid control	1				
22	114069	SPRING, compression	1				
23	114072	SPRING, compression	1				
24	197015	FITTING	1				

Technical Data

Maximum inlet fluid pressure	50 psi (0.35 MPa, 3.5 bar)
Maximum inlet air pressure	135 psi (0.93 MPa, 9.3 bar)
Air inlet	Quick-disconnect
Fluid inlet	3/8 nps
Sound levels per ISO 3744	
Sound power level	less than 65.0 dB(A)
Sound pressure level	less than 65.0 dB(A)
Wetted parts	
Spray gun	stainless steel, aluminum
2 ¹ / ₂ -gallon accessory remote pressure pot	PTFE finish, polyethylene

Accessories

SST 1 Qt. Cup w/Single Air Regulator Kit 245181
1 qt. (0.95 liter) capacity, 304 SST cup. Includes a pressure relief valve and a single cup air regulator and gauge.

[illegible]

Graco Warranty

Graco warrants all equipment manufactured by Graco and bearing its name to be free from defects in material and workmanship on the date of sale by an authorized Graco distributor to the original purchaser for use. With the exception of any special, extended, or limited warranty published by Graco, Graco will, for a period of twelve months from the date of sale, repair or replace any part of the equipment determined by Graco to be defective. This warranty applies only when the equipment is installed, operated and maintained in accordance with Graco's written recommendations.

This warranty does not cover, and Graco shall not be liable for general wear and tear, or any malfunction, damage or wear caused by faulty installation, misapplication, abrasion, corrosion, inadequate or improper maintenance, negligence, accident, tampering, or substitution of non-Graco component parts. Nor shall Graco be liable for malfunction, damage or wear caused by the incompatibility of Graco equipment with structures, accessories, equipment or materials not supplied by Graco, or the improper design, manufacture, installation, operation or maintenance of structures, accessories, equipment or materials not supplied by Graco.

This warranty is conditioned upon the prepaid return of the equipment claimed to be defective to an authorized Graco distributor for verification of the claimed defect. If the claimed defect is verified, Graco will repair or replace free of charge any defective parts. The equipment will be returned to the original purchaser transportation prepaid. If inspection of the equipment does not disclose any defect in material or workmanship, repairs will be made at a reasonable charge, which charges may include the costs of parts, labor, and transportation.

THIS WARRANTY IS EXCLUSIVE, AND IS IN LIEU OF ANY OTHER WARRANTIES, EXPRESS OR IMPLIED, INCLUDING BUT NOT LIMITED TO WARRANTY OF MERCHANTABILITY OR WARRANTY OF FITNESS FOR A PARTICULAR PURPOSE.

Graco's sole obligation and buyer's sole remedy for any breach of warranty shall be as set forth above. The buyer agrees that no other remedy (including, but not limited to, incidental or consequential damages for lost profits, lost sales, injury to person or property, or any other incidental or consequential loss) shall be available. Any action for breach of warranty must be brought within two (2) years of the date of sale.

Graco makes no warranty, and disclaims all implied warranties of merchantability and fitness for a particular purpose in connection with accessories, equipment, materials or components sold but not manufactured by Graco. These items sold, but not manufactured by Graco (such as electric motors, switches, hose, etc.), are subject to the warranty, if any, of their manufacturer. Graco will provide purchaser with reasonable assistance in making any claim for breach of these warranties.

In no event will Graco be liable for indirect, incidental, special or consequential damages resulting from Graco supplying equipment hereunder, or the furnishing, performance, or use of any products or other goods sold hereto, whether due to a breach of contract, breach of warranty, the negligence of Graco, or otherwise.

FOR GRACO CANADA CUSTOMERS

The parties acknowledge that they have required that the present document, as well as all documents, notices and legal proceedings entered into, given or instituted pursuant hereto or relating directly or indirectly hereto, be drawn up in English. Les parties reconnaissent avoir convenu que la rédaction du présent document sera en Anglais, ainsi que tous documents, avis et procédures judiciaires exécutés, donnés ou intentés à la suite de ou en rapport, directement ou indirectement, avec les procédures concernées.

ADDITIONAL WARRANTY COVERAGE

Graco does provide extended warranty and wear warranty for products described in the "Graco Contractor Equipment Warranty Program".

Graco Phone Number

TO PLACE AN ORDER, contact your Graco distributor, or call this number to identify the distributor closest to you:
1-800-690-2894 Toll Free

*All written and visual data contained in this document reflect the latest product information available at the time of publication.
Graco reserves the right to make changes at any time without notice.*

Sales Office: Minneapolis
International Offices: Belgium, Korea, Hong Kong, Japan

GRACO INC. P.O. BOX 1441 MINNEAPOLIS, MN 55440-1441

www.graco.com

PRINTED IN USA 309357
05/2001, Rev. 09/2005