

Instructions – Parts List



WALL MOUNT

Bulk Oil Transfer Packages 309351 Rev.C

Model No. 244846, 3:1 President

180 psi (1.2 MPa, 12 bar) Maximum Air Inlet Pressure

540 psi (3.7 MPa, 37 bar) Maximum Fluid Working Pressure

Model No. 244628, 6:1 President

180 psi (1.2 MPa, 12 bar) Maximum Air Inlet Pressure

1100 psi (7.6 MPa, 76 bar) Maximum Fluid Working Pressure

Model No. 244847, 10:1 President

180 psi (1.2 MPa, 12 bar) Maximum Air Inlet Pressure

1800 psi (12.4 MPa, 124 bar) Maximum Fluid Working Pressure

Model No. 244629, 5:1 Bulldog

100 psi (0.7 MPa, 7 bar) Maximum Air Inlet Pressure

500 psi (3.4 MPa, 34 bar) Maximum Fluid Working Pressure

Model No. 244630, 10:1 Bulldog

100 psi (0.7 MPa, 7 bar) Maximum Air Inlet Pressure

1000 psi (6.9 MPa, 69 bar) Maximum Fluid Working Pressure

Model No. 244631, 20:1 King

90 psi (0.6 MPa, 6 bar) Maximum Air Inlet Pressure

1800 psi (12.4 MPa, 124 bar) Maximum Fluid Working Pressure



Read warnings and instructions.

See pump and motor manuals (supplied) for important safety warnings and installation, operation, and service instructions.

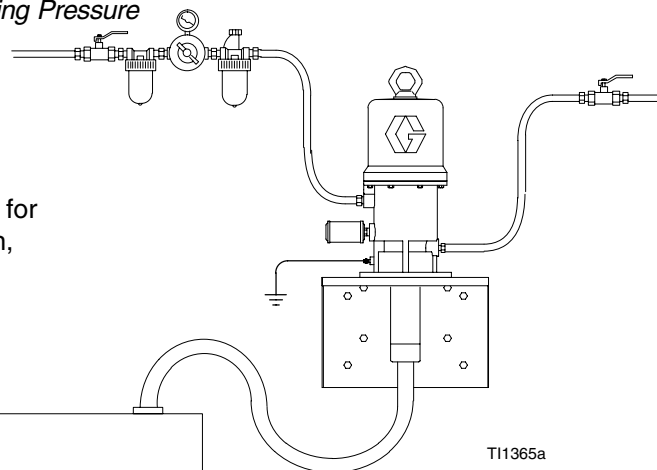

Bulk Supply

President Model Shown

Installation

Models 244628, 244846, and 244847

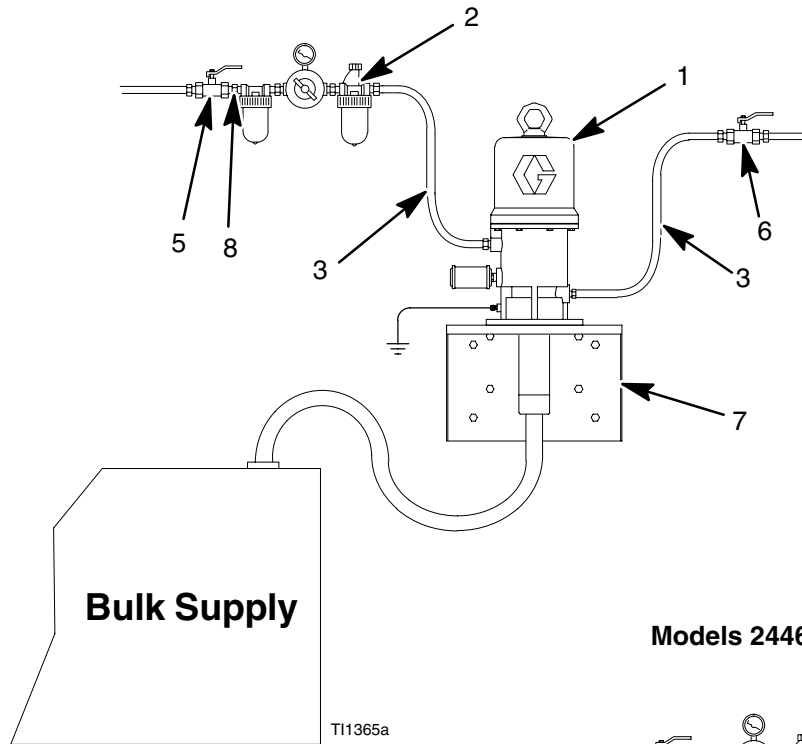

Models 244629, 244630, and 244631

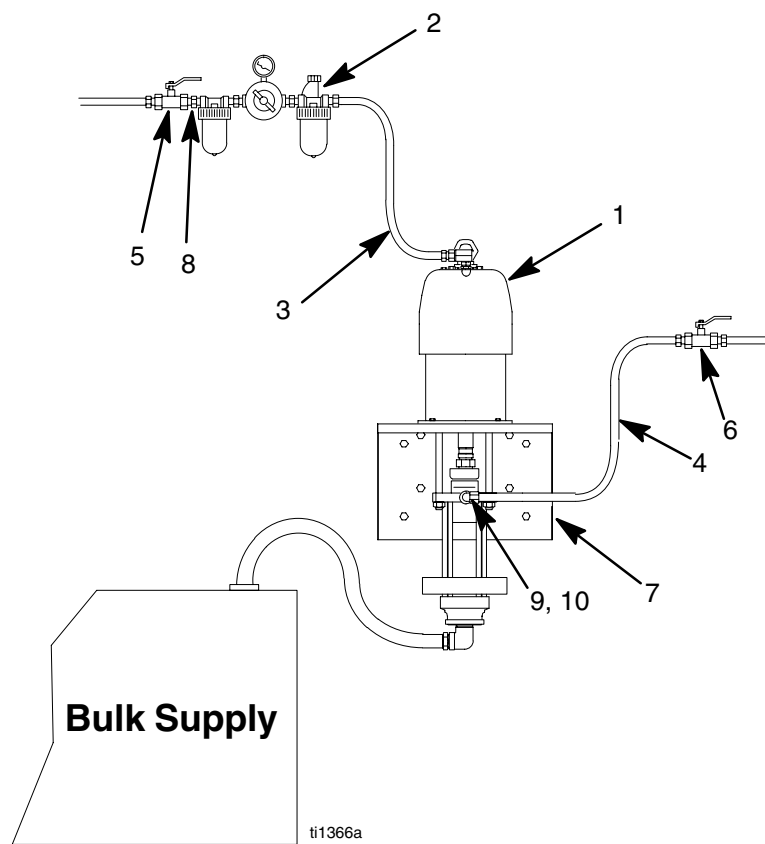

NOTE: See pump and motor manuals for important **safety warnings** and installation, operation, and service instructions.

Parts List

Model No. 244846, 3:1 President

(includes items 1–3 and 5–8)

Model No. 244628, 6:1 President

(includes items 1–3 and 5–8)

Model No. 244847, 10:1 President

(includes items 1–3 and 5–8)

Model No. 244629, 5:1 Bulldog

(includes items 1–10)

Model No. 244630, 10:1 Bulldog

(includes items 1–10)

Model No. 244631, 20:1 King

(includes items 1–10)

Ref. No.	Part No.	Description	Qty.	Ref. No.	Part No.	Description	Qty.
1	237526	PUMP, 3:1 President (used on model 244846; see manual 308485)	1	5	110225	VALVE, air shutoff; 1/2 in. npt(fbe) (used on models 244628, 244846, and 244847)	1
	238108	PUMP, 6:1 President (used on model 244628; see manual 308608)	1		110226	VALVE, air shutoff; 3/4 in. npt(fbe) (used on models 244629, 244630, and 244631)	1
	205626	PUMP, 10:1 President (used on model 244847; see manual 308655)	1	6	108537	VALVE, fluid shutoff; 3/4 in. npt(fbe) (used on models 244628, 244846, and 244847)	1
	221104	PUMP, 5:1 Bulldog (used on model 244629; see manuals 307049, 308043, and 307871)	1		512152	VALVE, fluid shutoff; 1 in. npt(fbe) (used on models 244629, 244630, and 244631)	1
	222826	PUMP, 10:1 Bulldog (used on model 244630; see manuals 307049 and 308151)	1	7	238245	BRACKET, wall mounting (used on models 244628, 244846, and 244847)	1
	222832	PUMP, 20:1 King (used on model 244631; see manuals 309347 and 308151)	1		206221	BRACKET, wall mounting (used on models 244629, 244630, and 244631; see manual 306783)	1
2	217072	FILTER, REGULATOR, LUBRICATOR; 1/2 in. npt(fbe) (used on models 244628, 244846, and 244847; see manuals 308167 and 308169)	1	8	158491	NIPPLE; 1/2 in. npt (used on models 244628, 244846, and 244847)	1
	217073	FILTER, REGULATOR, LUBRICATOR; 3/4 in. npt(fbe) (used on models 244629, 244630, and 244631; see manuals 308168 and 308169)	1		156849	NIPPLE; 3/8 in. npt (used on models 244629, 244630, and 244631)	1
3	222068	KIT, hose and fitting; 18 in. (used on models 244628, 244846, and 244847; see manual 306520)	1	9	116650	COUPLING; 1–1/2 in. npt(f) x 1 in. npt(f) (used on models 244630 and 244631)	1
	110047	HOSE, air; 3/4 in. ID; 3/4 in. npt(mbe) x 18 in. (used on models 244629, 244630, and 244631)	1		116687	BUSHING; 1 in. npt(f) x 1–1/2 in. npt(m) (used on model 244629)	1
4	115042	HOSE, fluid; 1 in. ID; 1 in. npt(mbe) x 72 in. (used on models 244629, 244630, and 244631)	1	10	160022	ADAPTER, swivel, straight; 1 in. npt(m) x 1 in. npsm(f) (used on models 244629, 244630, and 244631)	1

Technical Data

See the cover for system maximum air and fluid working pressure ratings. See the separate pump and motor instruction manuals (supplied) for pump and motor Technical Data.

Graco Standard Warranty

Graco warrants all equipment manufactured by Graco and bearing its name to be free from defects in material and workmanship on the date of sale to the original purchaser for use. With the exception of any special, extended, or limited warranty published by Graco, Graco will, for a period of twelve months from the date of sale, repair or replace any part of the equipment determined by Graco to be defective. This warranty applies only when the equipment is installed, operated and maintained in accordance with Graco's written recommendations.

This warranty does not cover, and Graco shall not be liable for general wear and tear, or any malfunction, damage or wear caused by faulty installation, misapplication, abrasion, corrosion, inadequate or improper maintenance, negligence, accident, tampering, or substitution of non-Graco component parts. Nor shall Graco be liable for malfunction, damage or wear caused by the incompatibility of Graco equipment with structures, accessories, equipment or materials not supplied by Graco, or the improper design, manufacture, installation, operation or maintenance of structures, accessories, equipment or materials not supplied by Graco.

This warranty is conditioned upon the prepaid return of the equipment claimed to be defective to an authorized Graco distributor for verification of the claimed defect. If the claimed defect is verified, Graco will repair or replace free of charge any defective parts. The equipment will be returned to the original purchaser transportation prepaid. If inspection of the equipment does not disclose any defect in material or workmanship, repairs will be made at a reasonable charge, which charges may include the costs of parts, labor, and transportation.

THIS WARRANTY IS EXCLUSIVE, AND IS IN LIEU OF ANY OTHER WARRANTIES, EXPRESS OR IMPLIED, INCLUDING BUT NOT LIMITED TO WARRANTY OF MERCHANTABILITY OR WARRANTY OF FITNESS FOR A PARTICULAR PURPOSE.

Graco's sole obligation and buyer's sole remedy for any breach of warranty shall be as set forth above. The buyer agrees that no other remedy (including, but not limited to, incidental or consequential damages for lost profits, lost sales, injury to person or property, or any other incidental or consequential loss) shall be available. Any action for breach of warranty must be brought within two (2) years of the date of sale.

Graco makes no warranty, and disclaims all implied warranties of merchantability and fitness for a particular purpose in connection with accessories, equipment, materials or components sold but not manufactured by Graco. These items sold, but not manufactured by Graco (such as electric motors, switches, hose, etc.), are subject to the warranty, if any, of their manufacturer. Graco will provide purchaser with reasonable assistance in making any claim for breach of these warranties.

In no event will Graco be liable for indirect, incidental, special or consequential damages resulting from Graco supplying equipment hereunder, or the furnishing, performance, or use of any products or other goods sold hereto, whether due to a breach of contract, breach of warranty, the negligence of Graco, or otherwise.

FOR GRACO CANADA CUSTOMERS

The parties acknowledge that they have required that the present document, as well as all documents, notices and legal proceedings entered into, given or instituted pursuant hereto or relating directly or indirectly hereto, be drawn up in English. Les parties reconnaissent avoir convenu que la rédaction du présent document sera en Anglais, ainsi que tous documents, avis et procédures judiciaires exécutés, donnés ou intentés à la suite de ou en rapport, directement ou indirectement, avec les procédures concernées.

Graco Phone Numbers

TO PLACE AN ORDER, contact your Graco distributor, or call one of the following numbers to identify the distributor closest to you:

1-800-533-9655 Toll Free

612-623-6928

612-378-3590 Fax

*All written and visual data contained in this document reflect the latest product information available at the time of publication.
Graco reserves the right to make changes at any time without notice.*

Sales Offices: Minneapolis

International Offices: Belgium, Korea, Hong Kong, Japan

GRACO INC. P.O. BOX 1441 MINNEAPOLIS, MN 55440-1441

www.graco.com

PRINTED IN USA 309351 06/2001, Revised 06/2004