

# Installation Instructions

Form No. 309349

Rev. A



INSTRUCTIONS

For detailed HVLP–Turbine Gun information and warnings see Operating Instructions manual 309317.



This manual contains kit installation instructions only.

## Check Valve Conversion Kit for HVLP–T™ Guns

To find your local Graco authorized service center

- Call us at 1–800–690–2894
- Visit our website at [www.graco.com](http://www.graco.com)

Kit No. 244836

### WARNING

Relieve all fluid pressure in the system before you install, remove, or replace any parts. See the **Pressure Relief Procedure** below or for more information refer to Operating Instructions manual 309317.

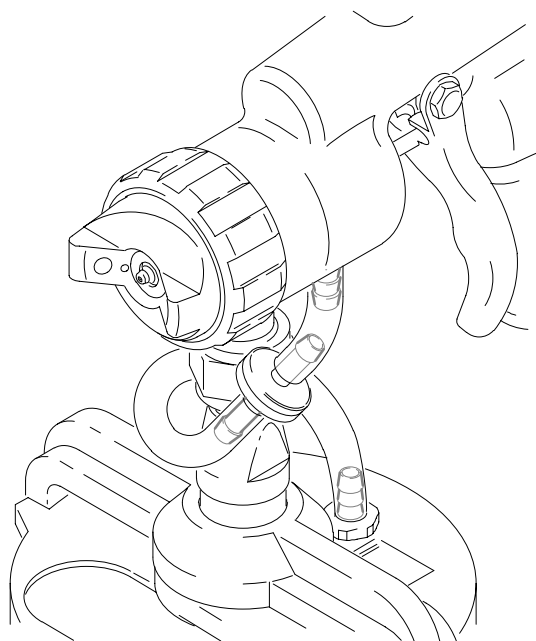

**Pressure Relief Procedure**



1. Turn off turbine and air supply to gun.

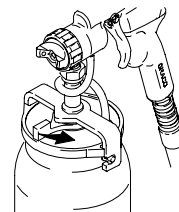

2. Unlatch cup



GRACO INC. P.O. BOX 1441 MINNEAPOLIS, MN 55440–1441

©COPYRIGHT 2001, GRACO INC.

Graco Inc. is registered to I.S. EN ISO 9001

# Check Valve Conversion Kit

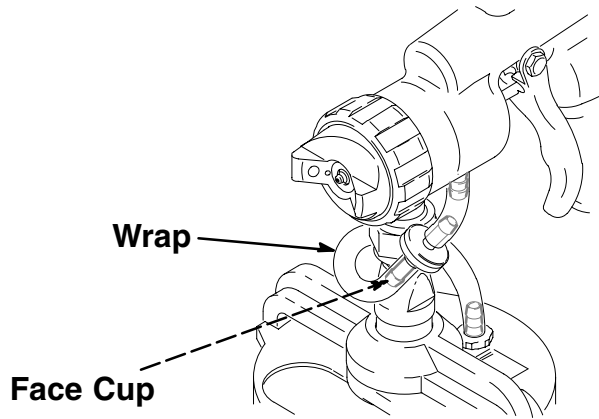

1. Relieve pressure following the **Pressure Relief Procedure** provided on the front of this instruction sheet or in manual 309317.
2. Remove air pressure tube and duckbill check valve (if equipped) from gun.
3. Insert replacement tube with check valve (1) . Be sure the black tapered end of the check valve faces cup.

**NOTE:** Wrapping the tube as shown allows cup to swivel freely. **See Swivel Tube Adjustment.**

## Swivel Tube Adjustment

### **⚠ WARNING**

Paint cup is under continuous pressure even after air line has been disconnected. **DO NOT PULL TRIGGER AFTER SPRAYING!!!**

Relieve pressure following the **Pressure Relief Procedure** provided on the front of this instruction sheet or in manual 309317 .

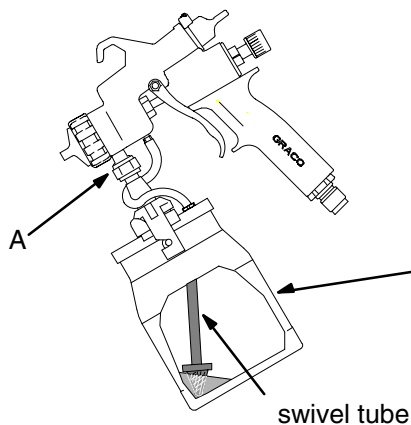

### Swivel tube positioned for spraying DOWN

1. Relieve pressure following the **Pressure Relief Procedure** provided on the front of this instruction sheet or in manual 309317.

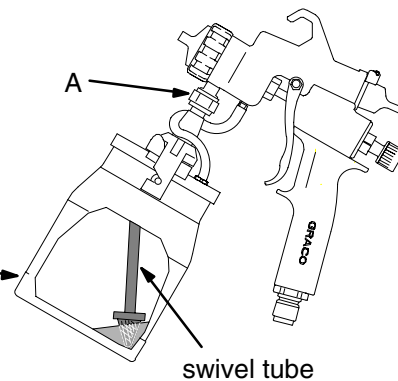

### Swivel tube positioned for spraying UP

2. Loosen nut (A) with wrench.
3. Rotate cup to desired spray position.
4. Retighten nut (A) with wrench.

*All written and visual data contained in this document reflects the latest product information available at the time of publication.  
Graco reserves the right to make changes at any time without notice.*

**Sales Offices:** Minneapolis, Detroit

**International Offices:** Belgium, Korea, Hong Kong, Japan

**GRACO INC. P.O. BOX 1441 MINNEAPOLIS, MN 55440-1441**

**[www.graco.com](http://www.graco.com)**

PRINTED IN USA 309349 3/2001