

# INSTRUCTIONS



# 309327

Rev C



For detailed sprayer information and warnings, see Operating Instructions manual 309225 included with MAGNUM sprayers or 309388 included with 150 RPX Roller and Spray System.

First choice when  
quality counts.™

This manual contains kit  
installation instructions only.

## Control Board Kit for

**MAGNUM™**  
by GRACO

## dx Airless Sprayers and RPX 150 Roller and Spray System

**Control Board Replacement Kit: 245079, 245677, 245986**

### Pressure Relief Procedure

#### **WARNING**



To help prevent injection injuries, follow this procedure when you stop spraying and before you service or clean the sprayer, remove parts, or repair leaks.

1. Turn Power switch OFF. Unplug sprayer.
2. Turn Spray/Prime valve to PRIME to relieve pressure. Turn PPressure Control knob left (counter-clockwise) to minimize pressure.
3. Put trigger safety in SAFETY ON position.

**NOTE:** Leave Spray/Prime valve in the PRIME position until you are ready to spray again.



9565A

*If you suspect that the spray tip or hose is completely clogged or that pressure has not been fully relieved after following the steps above, VERY SLOWLY loosen the tip guard retaining nut or hose end coupling to relieve pressure gradually. Then loosen it completely. Clear the tip or hose obstruction.*

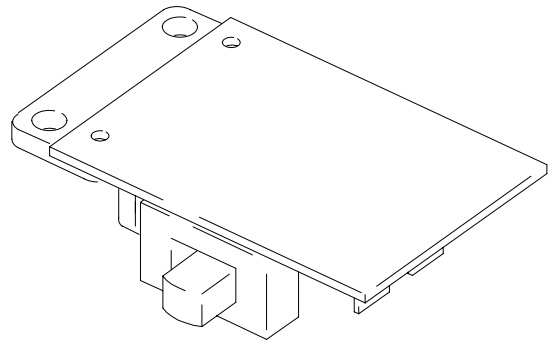

ti1093A

**GRACO INC. P.O. BOX 1441 MINNEAPOLIS, MN 55440-1441**

©COPYRIGHT 2001, GRACO INC.

Graco Inc. is registered to I.S. EN ISO 9001

## Control Board Replacement Kit

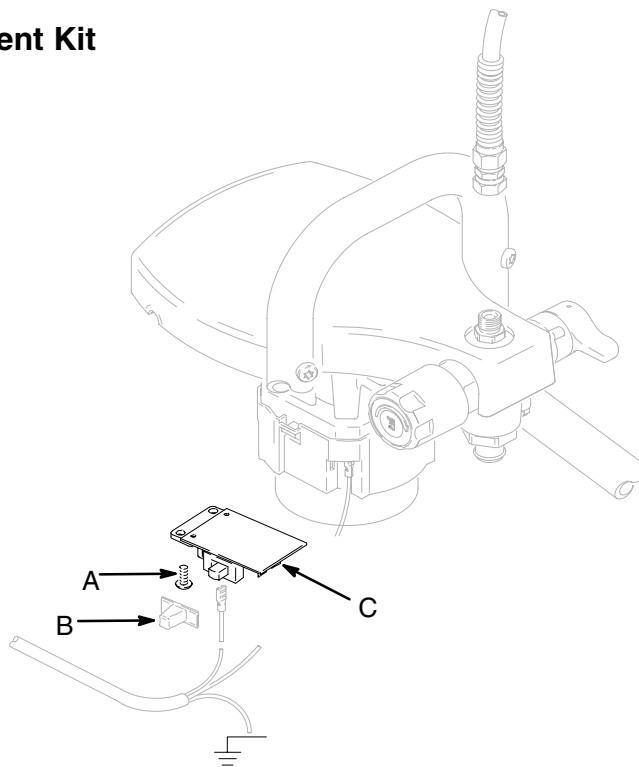

ti1093a

Fig. 1

### Disassembly (Fig. 1)

1. Unplug electrical cord.
2. **Relieve Pressure** by following the procedure described on page 1, or see the Operating Instructions manual 309225.
3. Tip unit on its back.
4. Remove 3 motor enclosure screws using a T-20 torx or straight blade screw driver.
5. Disconnect motor harness, electrical cord, and pressure control knob leads
6. Remove 2 screws (A) that mount control board to housing using a T-20 torx or straight blade screw driver.
7. Lift the control board out of the housing.
8. Remove switch cover (B) and save.
9. Discard old control board (C).

### Assembly (Fig. 1)

1. Place switch cover (B) over switch on new control board (C).
2. Insert new control board (C) into housing.
3. Replace 2 control board mounting screws (A).

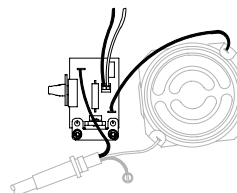

ti1093A

Fig. 2

4. Connect motor harness, electrical cord and pressure control knob leads. (Fig. 2)
5. Replace cover and screws. Before tightening, be sure switch cover is aligned with two grooves in motor enclosure.

*All written and visual data contained in this document reflects the latest product information available at the time of publication. Graco reserves the right to make changes at any time without notice.*

**Sales Office:** Minneapolis  
**International Offices:** Belgium, Korea, Hong Kong, Japan

**GRACO INC. P.O. BOX 1441 MINNEAPOLIS, MN 55440-1441**

**www.graco.com**

PRINTED IN USA 309327 April 2001, Revised, September 2004