

Operating Instructions

Form No. 309048

Rev. A



This manual contains important warnings and information.
READ AND KEEP FOR REFERENCE.

INSTRUCTIONS

To find your local Graco/MAGNUM authorized service center

- Call us at 1-888-541-9788
- Visit our website at www.graco.com
- See the Graco/MAGNUM Authorized Service Centers list (Part No. 302367)



Pressure Roller

Model 243060, Series A

- 20 in. (50 cm) heavy-duty extension
- 45° swivel adapter
- 9 in. (23 cm) roller frame
- 1/2 in. (13 mm) nap roller cover

*3600 psi (24.8 MPa, 248 bar) Maximum Fluid Inlet Pressure **

* This maximum pressure is only possible if the roller frame is completely plugged. The best operating pressure is the lowest pressure that provides an even paint supply to the roller and typically does not exceed 300 psi (2.1 MPa, 21 bar).

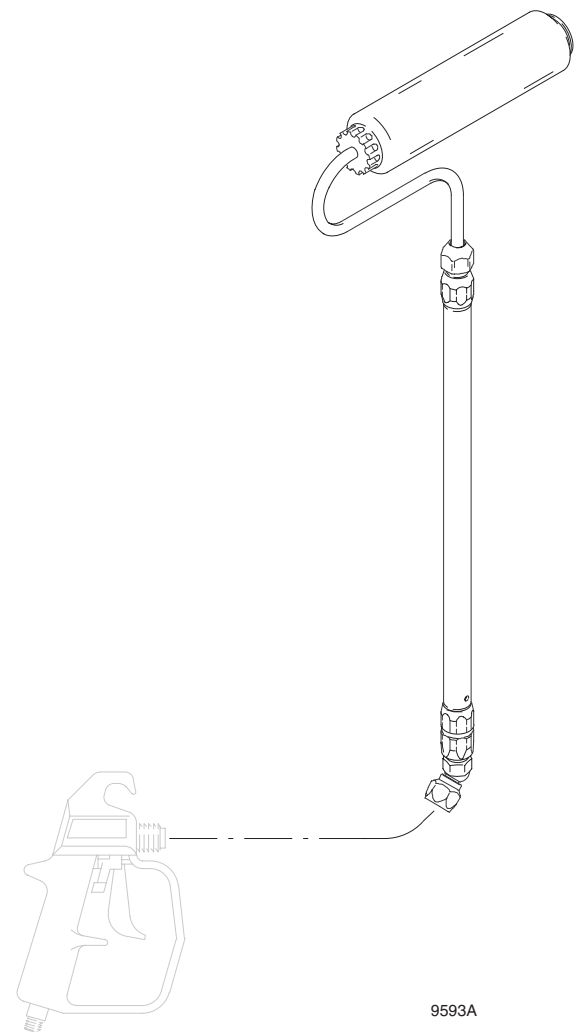

9593A

Airless spray
gun not included









GRACO INC. P.O. BOX 1441 MINNEAPOLIS, MN 55440-1441

©COPYRIGHT 1999, GRACO INC.

Graco Inc. is registered to I.S. EN ISO 9001

Warnings and Cautions

 WARNING	
EQUIPMENT MISUSE HAZARD Misuse can cause the equipment to rupture or malfunction and result in serious injury. To help prevent injury <ul style="list-style-type: none"> Do not modify the extension tube or roller frame or use parts not designed for this equipment. Do not use 1,1,1-trichloroethane, methylene chloride, other halogenated hydrocarbon solvents or fluids containing such solvents in this or any other pressurized aluminum equipment. Such use could result in a chemical reaction, with the possibility of explosion. 	 INSTRUCTIONS 
FIRE AND EXPLOSION HAZARD Improper grounding, poor ventilation, open flames or sparks can cause a hazardous condition and result in a fire or explosion and serious injury. To help prevent injury from fire or explosion <ul style="list-style-type: none"> Provide fresh air ventilation to avoid the buildup of flammable fumes from flushing fluids or the coating being applied. Keep the application area free of debris, including solvent, rags, and gasoline. 	 
FLUID INJECTION HAZARD If high-pressure fluid pierces your skin, the injury might look like "just a cut". But it is a serious wound. Get immediate medical attention. To help prevent injection <ul style="list-style-type: none"> Keep your hands and body away from the roller frame when flushing. High pressure fluid emitted from the holes in the frame could cause an injection injury. Always relieve pressure before you check or repair leaks and when you turn off pump or stop painting. Never use components rated less than system <i>Maximum Working Pressure</i>. 	
ELECTROCUTION HAZARD Failure to observe the electrical hazards described below could result in serious injury, including burns or electrocution. To help prevent harmful electrical shock <ul style="list-style-type: none"> Avoid contact with power lines. Follow all grounding instructions in your separate pump and gun instruction manual, and comply with all local, state, and national fire, electrical, and safety regulations. Use only MAGNUM or Graco paint hoses. 	

Preventing Corrosion Damage and Freezing

CAUTION

Never leave water in the pump, gun, or pressure roller. Doing so could cause corrosion and damage from freezing. For storage, flush the system with Graco Pump Armor™ or mineral spirits/paint thinner. See **Flushing** on page 3.

Installation

Assemble the pressure roller as shown in the **Parts Drawing** on page 3.

Pressure Relief Procedure

WARNING



psi/MPa/bar

To help prevent injection injuries, follow this procedure whenever you stop painting.

- Put gun trigger safety in SAFETY ON position.
- Shut off power to pump.
- Put pump prime/drain valve (required for pressure relief) in DRAIN position to relieve pressure in system.
- Put gun trigger safety in SAFETY OFF position, and trigger gun to relieve any pressure in hose.
- Put gun trigger safety in SAFETY ON position, and keep pump prime/drain valve in DRAIN position until you paint again.

Operation

- Follow pump priming instructions using lowest pressure setting at which pump primes.
 - Put pump prime/drain valve in position that delivers fluid to hose.
 - Disengage gun safety latch, and trigger gun briefly until paint comes to roller.
 - Experiment with triggering gun and rolling paint.
- NOTE:** Trigger the gun briefly when you need more paint. Determine how often you must trigger the gun to maintain an even paint supply to the roller.
- Increase pump pressure only if triggering gun cannot supply enough paint for your rolling speed.



See **Pressure Relief Procedure** on page 2.

- Whenever you stop painting, **relieve the pressure**, and elevate roller end of extension tube to prevent paint from draining out.

Flush the pump, gun, and pressure roller immediately after each use to prevent paint from drying in the pressure roller and damaging it. See **Flushing** on page 3.

Flushing

This is the procedure for flushing the pressure roller. The pump and gun you are using may have additional flushing steps, such as cleaning filters and screens. See the pump and gun flushing instructions.

NOTE: Leave the pressure roller attached to the gun for this procedure.



See **Pressure Relief Procedure** on page 2.

1. **Relieve the pressure.**
 2. Remove roller cover (6) and diffuser from roller frame as follows (see **Parts Drawing** at right):
 - a. Hold roller cover, and unscrew retaining nut.
 - b. Slide diffuser and roller cover off of roller frame.
 - c. Pull roller cover off of diffuser.
 3. Clean roller cover with compatible fluid, and clean diffuser by shaking vigorously in pail of compatible fluid to remove wet paint. Use soft bristled brush to remove any dried paint on diffuser.
 4. Place roller frame (1) in empty waste pail.
 5. Prime pump with flushing fluid compatible with paint you are using, and use the lowest pressure setting at which pump primes.
 6. Put pump prime/drain valve in position that delivers fluid to hose.
- NOTE:** Perform Step 7 at the lowest pressure possible.
7. Trigger gun until flushing fluid coming out of roller frame is relatively clear.
 8. Shut off the pump, and **relieve the pressure.**
 9. To prevent corrosion, lubricate paint holes in roller frame with lightweight oil that does not contain silicone.

Storage

If you are going to store the airless equipment for an extended period of time after flushing with water-base fluid, flush again with Graco Pump Armor or mineral spirits/paint thinner. Leave the fluid in the system during storage.

Additional Roller Covers

The following MAGNUM pressure roller covers are available at your local distributor:

- | | |
|---------------|--------------------------------------|
| 243062 | 9 in. (23 cm); 3/8 in. (9.5 mm) nap |
| 243063 | 9 in. (23 cm); 1/2 in. (13 mm) nap |
| 243064 | 9 in. (23 cm); 3/4 in. (19 mm) nap |
| 243065 | 9 in. (23 cm); 1-1/4 in. (32 mm) nap |

Parts Drawing

MAGNUM Pressure Roller, Model 243060, Series A

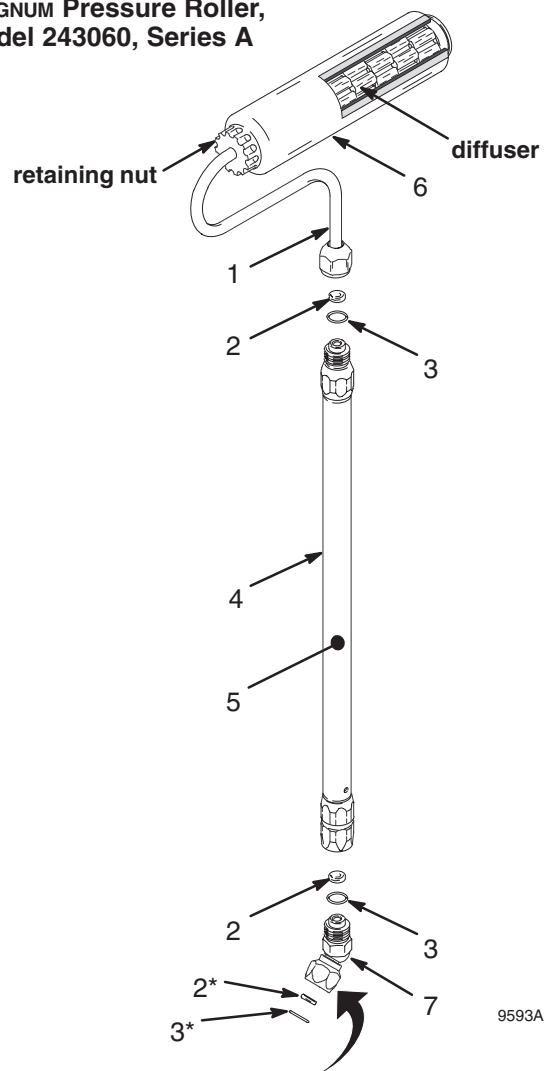

HINT:

When replacing gasket (2*) and o-ring (3*) in swivel adapter (7), position o-ring first, then press gasket into place.

Parts List

Ref. No.	Part No.	Description	Qty.
1	243061	FRAME, roller	1
2	162863	GASKET, non-metallic	3
3	114049	PACKING, o-ring	3
4	243051	TUBE, extension; 20 in. (50 cm)	1
5▲	195804	LABEL, warning	1
6	243063	COVER, roller; 9 in. (23 cm); 1/2 in. (13 mm) nap	1
7	243057	ADAPTER, 45° swivel	1

▲ Call 1-800-328-0211 for free extras.

Limited Warranty

Graco Inc. warrants to the original retail purchaser (other than for purposes of resale or rental) all equipment manufactured by Graco and bearing its name to be free from defects in material and workmanship if operated in accordance with Graco's printed recommendations and instructions. This warranty applies for one year from the date of purchase.

This warranty does not cover and Graco shall not be liable for general wear and tear, or any malfunction, damage or wear caused by improper use, accidents, user negligence, use of non-Graco component parts or service or repair performed by anyone other than a Graco authorized service center.

IMPLIED WARRANTIES, INCLUDING THOSE OF MERCHANTABILITY AND FITNESS FOR A PARTICULAR PURPOSE, ARE LIMITED TO ONE YEAR FROM THE DATE OF ORIGINAL PURCHASE.

GRACO SHALL NOT IN ANY EVENT BE LIABLE FOR ANY INCIDENTAL, INDIRECT, OR CONSEQUENTIAL LOSS, DAMAGE OR EXPENSE OF ANY KIND, WHETHER FROM BREACH OF THIS WARRANTY OR ANY OTHER REASON. Some states do not allow the exclusion or limitation of incidental or consequential damages, so the above limitation or exclusion may not apply to you.

To make a claim under this warranty, return the product with proof of purchase, transportation prepaid, to any Authorized Graco Service Center. Graco's Authorized Service Center, at its option, will either repair or replace the product and return it to you, postage prepaid. A listing of Authorized Graco Service Centers is enclosed with this product. You may also find the nearest Authorized Graco Service Center by calling 1-888-541-9788 or by visiting our website at www.graco.com.

This warranty gives you specific legal rights and you may also have other rights which may vary from state to state.

*All written and visual data contained in this document reflect the latest product information available at the time of publication.
Graco reserves the right to make changes at any time without notice.*

GRACO INC. P.O. BOX 1441 MINNEAPOLIS, MN 55440-1441
www.graco.com

PRINTED IN USA 309048 12/1999