



This manual contains important warnings and information.  
**READ AND KEEP FOR REFERENCE.**

INSTRUCTIONS

*First choice when quality counts.™*

## Kit, Euro Pail Holder

### Model 240717, Series A

LineLazer II 3900 and 5900

LineLazer III 3900 and 5900

LineLazer III 200HS

### Installation

For all LineLasers.

1. Refer to Parts Drawings.
2. Install pail plate (1) on Line Lazer (A) as shown. Make sure side rail notchs (B) are face down.
3. Use pail cover (2) on paint pail or hopper. If desired, secure with elastic cord.

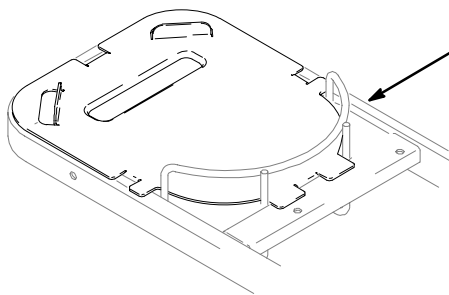
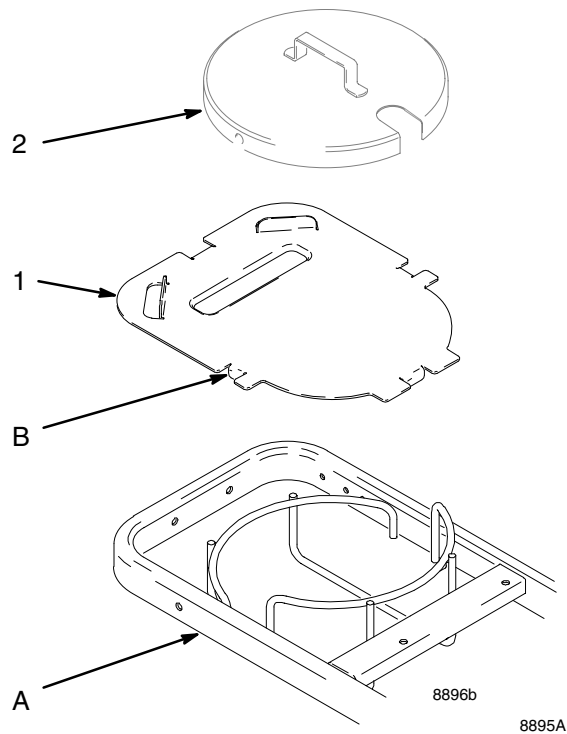

Model 240717 Shown

### Parts Drawing/List

Ref No.	Part No.	Description	Qty
	240717	KIT, euro pail holder (for LL II 3900 and LL II 5900)	Ref
1	194312	. PLATE, pail	1
2	240926	. COVER, pail	1

GRACO INC. P.O. BOX 1441 MINNEAPOLIS, MN 55440-1441

©COPYRIGHT 1999, GRACO INC.

Graco Inc. is registered to I.S. EN ISO 9001

## Graco Phone Number

**TO PLACE AN ORDER**, contact your Graco distributor, or call this number to identify the distributor closest to you:  
**1-800-690-2894 Toll Free.**

*All written and visual data contained in this document reflects the latest product information available at the time of publication.  
Graco reserves the right to make changes at any time without notice.*

**Sales Offices:** Minneapolis, Detroit  
**International Offices:** Belgium, Korea, Hong Kong, Japan

**GRACO INC. P.O. BOX 1441 MINNEAPOLIS, MN 55440-1441**

**<http://www.graco.com>**

PRINTED IN USA 308945 March 1999, Revised 8/2003