



INSTRUCTIONS

This manual contains important warnings and information.
READ AND KEEP FOR REFERENCE.

RoadLazer™ Auxiliary Air Kit

100 psi (7 bar, 0.7 MPa) Maximum Working Pressure

Model 240496, Series A

Pressure Relief Procedure

WARNING



INJECTION HAZARD

The system pressure must be manually relieved to prevent the system from starting or spraying accidentally. Fluid under high pressure can be injected through the skin and cause serious injury. To reduce the risk of an injury from injection, splashing fluid, or moving parts, follow the **Pressure Relief Procedure** whenever you:

- are instructed to relieve the pressure,
- stop spraying,
- check or service any of the system equipment,
- install or clean the spray tip.

1. Set hydraulic bypass valve to BYPASS position.
2. Stop engine by turning key to OFF position.
3. Place empty pail under paint guns to catch drainage.
4. Relieve hose pressure: use Programmable Skip-line Controller to trigger each gun for at least 3 seconds each.
5. Close paint gun ball valves.
6. Place empty pail under paint drain valves to catch drainage.
7. Open all drain valves, one at a time.
8. Close valves immediately to prevent paint from drying in system.

9. Relieve beads system pressure by turning bead system valve to OFF position

If you suspect that the spray gun or hose is completely clogged, or that pressure has not been fully relieved after following the steps above, **very slowly** loosen the hose end coupling and relieve pressure gradually, then loosen completely. Now clear the valve or hose.

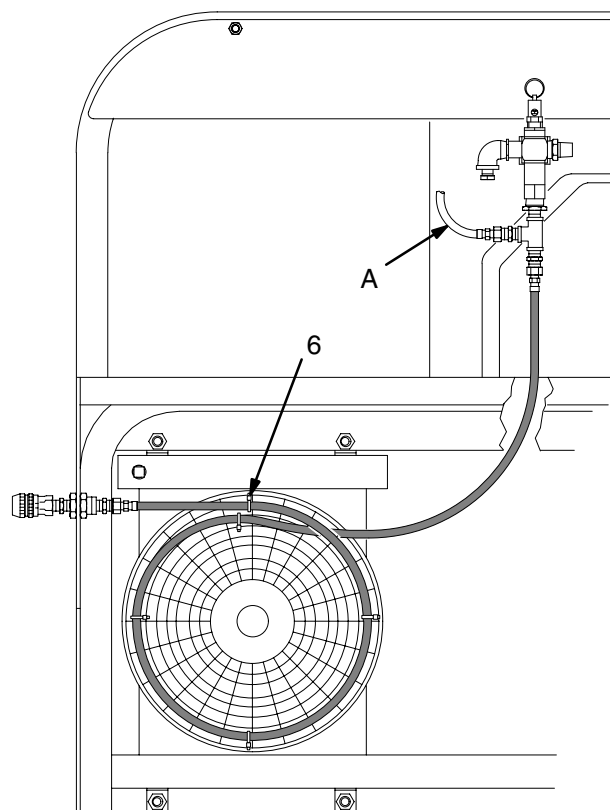

8284A

Fig. 1

Installation

1. Follow **Pressure Relief Procedure** on page 1.
2. Disconnect existing air line (A) from air compressor. Fig. 1.

Note: Use pipe sealant (7) on all threads.

3. Install Tee (3) into air compressor.
4. Install existing air line (A) into Tee.
5. Install nipple (5) into Tee.
6. Install air line (4) into Tee.
7. Connect and route kit air hose past fan.

8. Use tie-wrap (6) to secure top loop of air hose (4) to fan housing.

Note: Air hose is mounted in front of fan housing to cool the air.

9. Locate 3/4 in. hole on passenger side of Road Lazer chassis. If no hole, drill 3/4 in. hole. See following parts drawing.
10. Use bulkhead fitting (2) to install air line coupler (1) on bulkhead with nipples (5) on each side.
11. Connect air hose (4) to inside nipple (5).

Parts

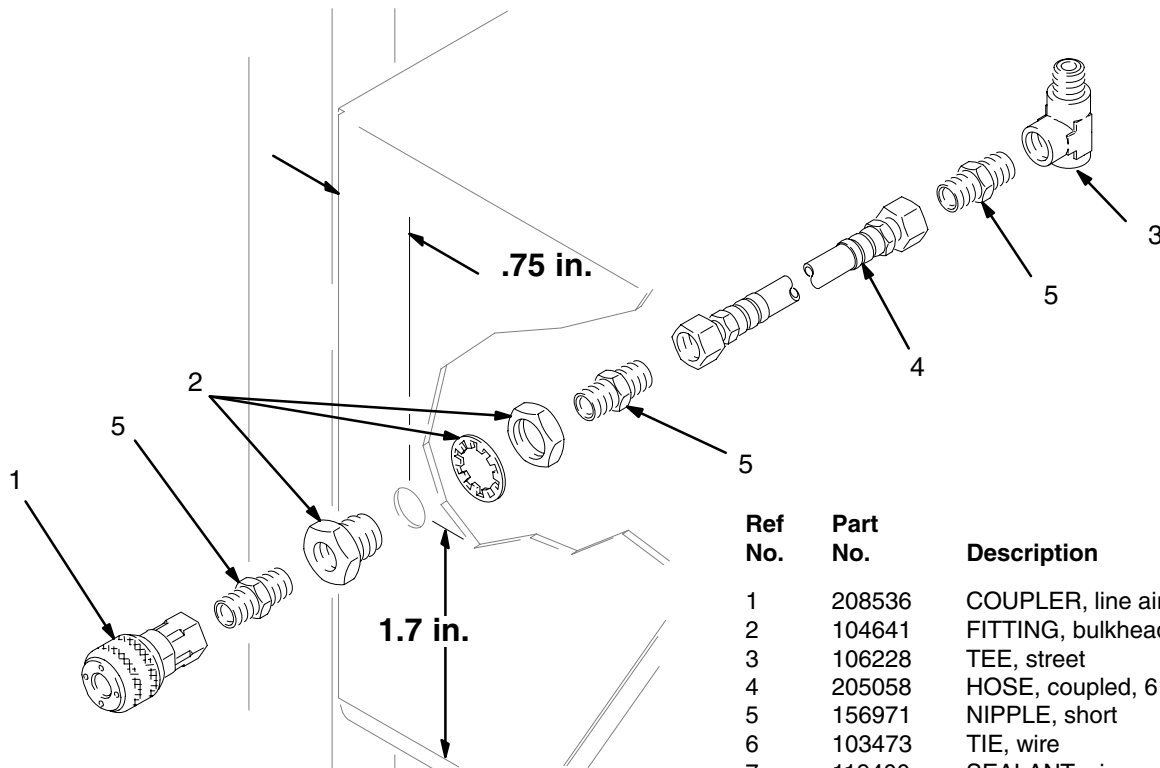

8282A

All written and visual data contained in this document reflects the latest product information available at the time of publication. Graco reserves the right to make changes at any time without notice.

Sales Offices: Minneapolis
International Offices: Belgium, Korea, Hong Kong, Japan

GRACO INC. P.O. BOX 1441 MINNEAPOLIS, MN 55440-1441

<http://www.graco.com>

©1998 Graco Inc. 308831 Rev. C 10/2004 PRINTED IN U.S.A.