

# UNPACKING INSTRUCTIONS



## Road Lazer 231378

308671 rev.D

US PATENT NO. 6,811,351

EUROPEAN PATENT NO. 0807714 & 1229171

### WARNING



#### FALLING PARTS

Do not remove the Road Lazer from pallet without the use of your vehicle. Attempting to move the unit manually could cause it to become unstable and tip, resulting in serious injury.

1. Mount the two receivers on the trailer hitch as shown in manual 308670.
2. Install two ball mounts in hitch receivers.
  - a. Insert pin.
  - b. Insert clip.
3. Remove the lag screws securing the sight guide to the pallet. Remove the sight guide.
4. Remove the metal straps securing the gun arm to the base of the pallet.
5. Remove metal straps securing main beam to the base of the pallet.

### WARNING

Be sure to use at *least* two people when connecting the gun-arm. The gun-arm is too heavy for one person to lift, and could cause serious injury and equipment damage.

6. Hang gun-arm on rear of Road-Lazer with hitch pin (A) and secure it with clip (B). *Do not* twist any hoses. Fig. 1.

**Note:** Before continuing, make sure that the gun-arm is securely attached to the Road-Lazer.

7. Unlock three red-handle clamps (D). Fig. 1.
8. Remove left handle (H) from main beam (L) by removing cotter pin (G).
9. Remove left capscrew (K) and locknut (J) from main beam.

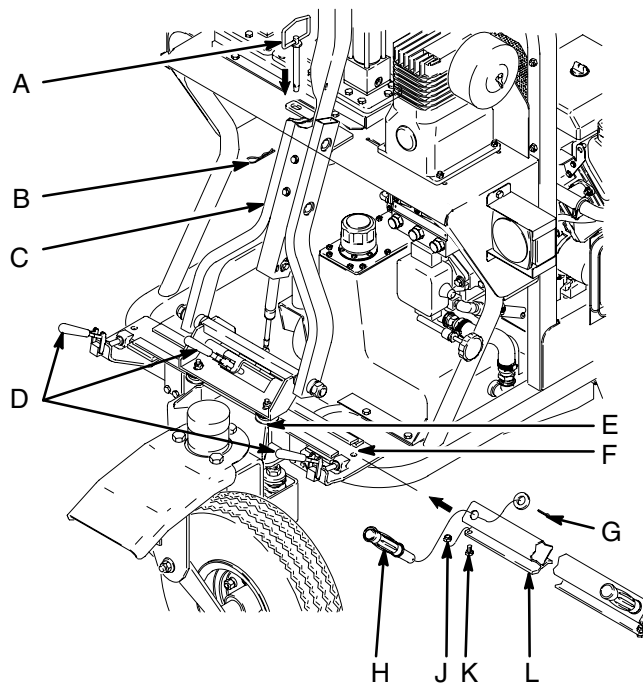

Fig. 1

06202A

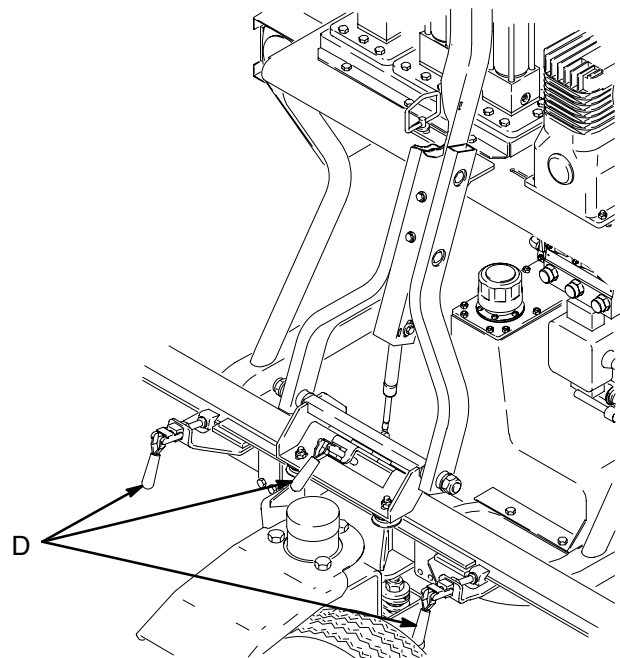

Fig. 2

06204A

GRACO INC. P.O. BOX 1441 MINNEAPOLIS, MN 55440-1441

©COPYRIGHT 1996, GRACO INC.

Graco Inc. is registered to I.S. EN ISO 9001

10. Slide main beam (L) through guide bracket (F) making sure that wheels (E) of gun-arm are securely attached. Fig. 1.
11. Center main beam on Road Lazer. Fig. 2.
12. Lock clamps (D) on main beam. Fig. 1.
13. Reconnect left handle (H) and capscrew (K) to main beam.
14. Extend jacks (T) with trailer arm height adjustment screws (R) and remove wooden support from under Road Lazer. Fig. 3.
15. Carefully, back-up truck and attach two trailer hitches to truck's ball mounts.
  - a. Crank trailer arm height adjustment screws to clear vehicle ball mounts (M).
  - b. Roll vehicle to Road Lazer. Align Road-Lazer trailer arms (P) with ball mounts.
  - c. Crank trailer arm height adjustment screws to Lower Road Lazer trailer arms onto ball mounts.
  - d. Lock trailer arms on Road Lazer with retaining handle (N).
  - e. Rotate jacks to horizontal position. Snap jacks retaining handles in place to secure jacks.
  - f. Connect safety chains (S).
16. Secure paint hoses and Road Lazer gas tank in rear of tow vehicle.
17. Using a screwdriver, remove assembly (V) securing rear wheel. Fig. 4.
18. Remove screws on wooden locks (U) securing each of two jack wheels. Fig. 4.

## ⚠ CAUTION

To avoid damaging this equipment, make sure that no items have been left on the pallet before removing the Road Lazer.

19. *Slowly*, tow Road Lazer off pallet.

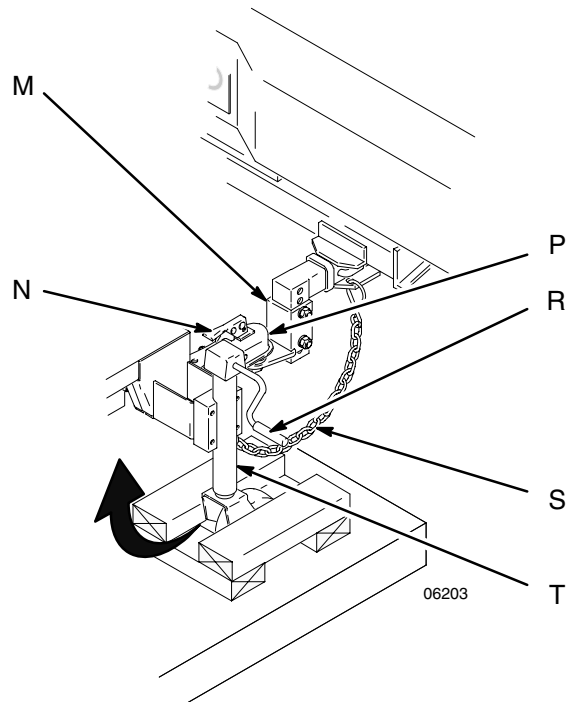

**Fig. 3**

06203

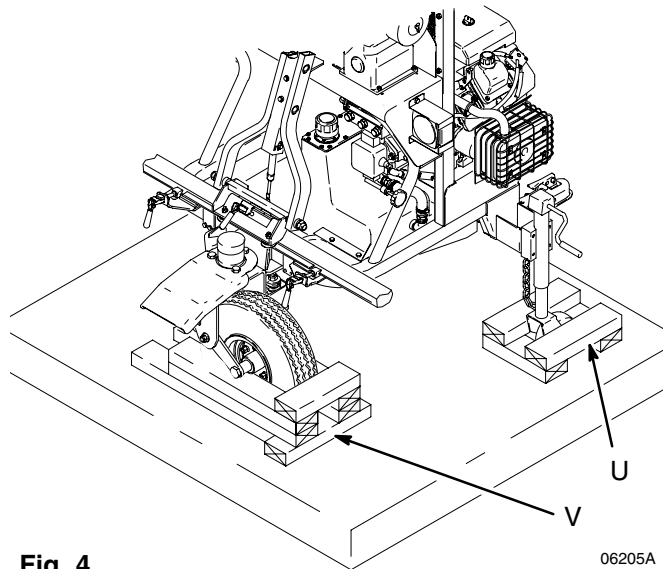

**Fig. 4**

06205A

*All written and visual data contained in this document reflects the latest product information available at the time of publication.  
Graco reserves the right to make changes at any time without notice.*

MM 308671

**Graco Headquarters:** Minneapolis  
**International Offices:** Belgium, China, Japan, Korea

**GRACO INC. P.O. BOX 1441 MINNEAPOLIS, MN 55440-1441**

**www.graco.com**

PRINTED IN USA 308671  
05/1996 Rev. 08/2005