

# Instructions – Parts List



19 LITER (5 GALLON) PAIL SIZE

## Cart

308567 Rev.B

**For Stubby Check-Mate 200™ and Check-Mate 450™ Pumps**

**Part No. 237557, Series A**

Universal Bare Cart

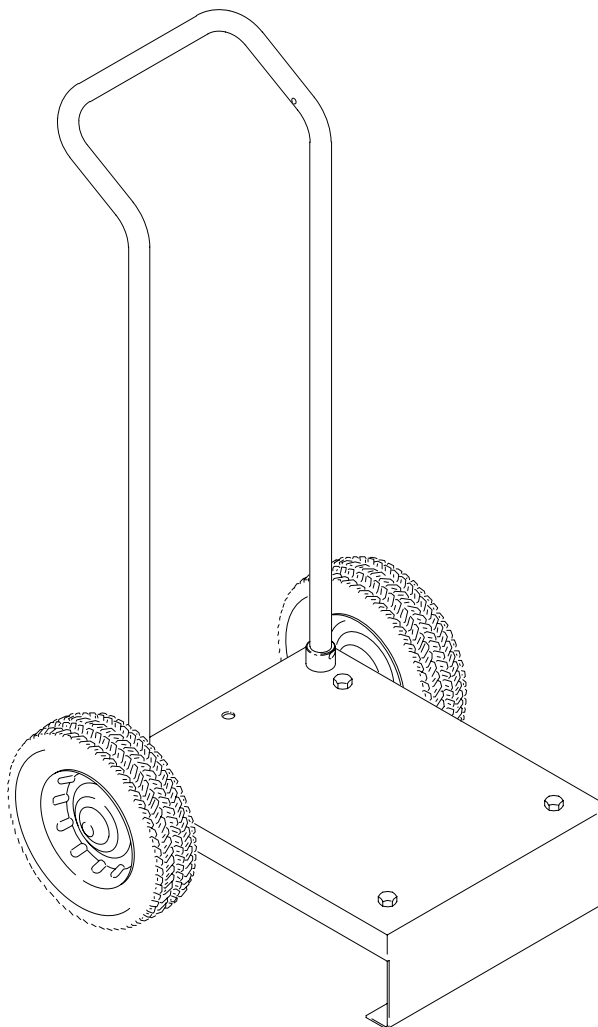

05504



**Read warnings and instructions.**  
See page 2 for Table of Contents.

**PROVEN QUALITY. LEADING TECHNOLOGY.**

**GRACO INC. P.O. BOX 1441 MINNEAPOLIS, MN 55440-1441**  
Copyright 1995, Graco Inc. is registered to I.S. EN ISO 9001

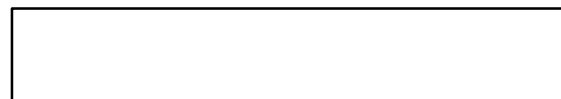

# Table of Contents

Warnings ..... 2  
Installation ..... 3  
Parts ..... 4  
Dimensions ..... 5  
Graco Standard Warranty ..... 6  
Graco Information ..... 6

# Symbols

## Warning Symbol





This symbol alerts you to the possibility of serious injury or death if you do not follow the instructions.

## Caution Symbol



This symbol alerts you to the possibility of damage to or destruction of equipment if you do not follow the instructions.

 <b>WARNING</b>	
 INSTRUCTIONS	<b>EQUIPMENT MISUSE HAZARD</b> Equipment misuse can cause the equipment to rupture or malfunction and result in serious injury. <ul style="list-style-type: none"><li>• This equipment is for professional use only.</li><li>• Read all instruction manuals, tags, and labels before operating the equipment.</li><li>• Use the equipment only for its intended purpose. If you are not sure, call Graco Technical Assistance at 1-800-543-0339.</li><li>• Do not alter or modify this equipment.</li><li>• Check equipment daily. Repair or replace worn or damaged parts immediately.</li><li>• Do not exceed the maximum working pressure stated on the equipment or in the <b>Technical Data</b> for your equipment.</li><li>• Wear hearing protection when operating this equipment.</li><li>• Comply with all applicable local, state, and national fire, electrical, and safety regulations.</li></ul>
	<b>MOVING PARTS HAZARD</b> Moving parts, such as the pump's priming piston and the wiper plate can pinch or amputate your fingers. <ul style="list-style-type: none"><li>• Keep clear of all moving parts when starting or operating the pump.</li><li>• Keep hands and fingers away from the priming piston during operation and whenever the pump is charged with air.</li><li>• Before servicing the equipment, follow the <b>Pressure Relief Procedure</b> in your separate pump manual to prevent the equipment from starting unexpectedly.</li></ul>

# Installation

## **Mounting a Ram on the Bare Cart**

Position a 5 gallon (19 liter) ram on the cart base. Secure with the four screws, washers, and nuts (18, 19, 20). See the Parts drawing on page 4.

## **Wiper Plates 222812 and 222909**

Wiper plates 222812 (carbon steel) and 222909 (stainless steel) are available. The plates must be modified for use with tapered pails. Refer to the separate wiper plate manual 308049 for details.

# Parts

## Part No. 237557, Series A Universal Bare Cart

Ref. No.	Part No.	Description	Qty.
4	190266	HANDLE, cart	1
10	237558	BASE, cart	1
11	106062	WHEEL, semi-pneumatic	2
16	104811	HUB CAP	2
17	101242	RING, retaining	2
18	100424	SCREW, cap, hex hd; 1/2-13; 1-1/4" (38 mm) long	4
19	100018	LOCKWASHER, spring; 1/2" size	4
20	100321	NUT, hex; 1/2-13	4
23	100664	SCREW, set, socket; 1/4-20; 1/2" (13 mm) long	2
24	103345	SCREW, cap, socket; 1/4-20; 1-1/4" (38 mm) long	2
25	100015	NUT, hex; 1/4-20	2

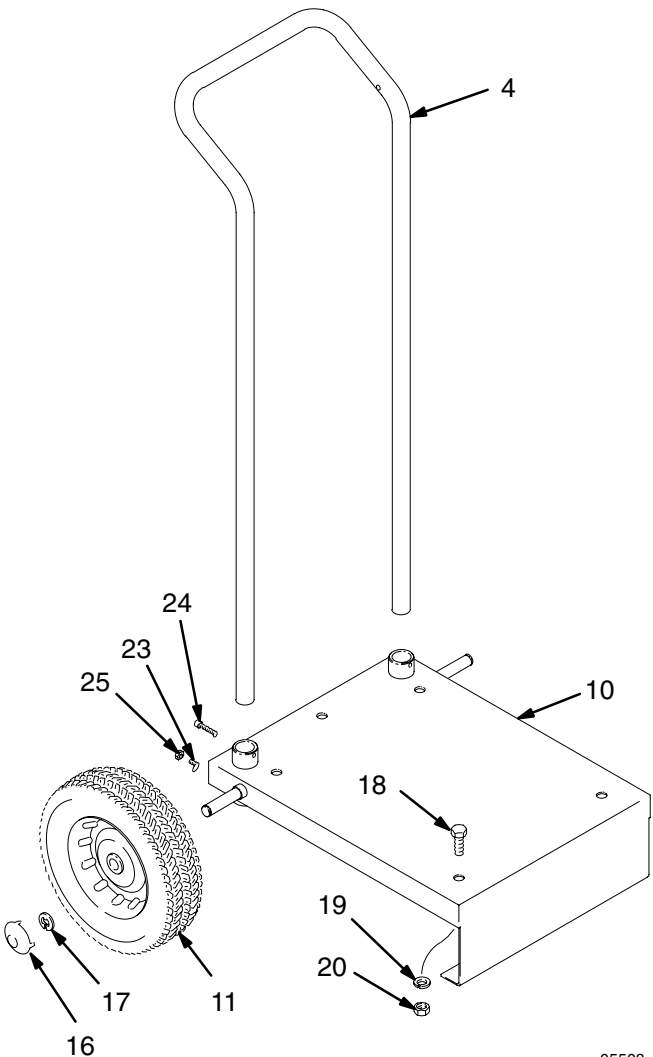

05508

# Dimensions

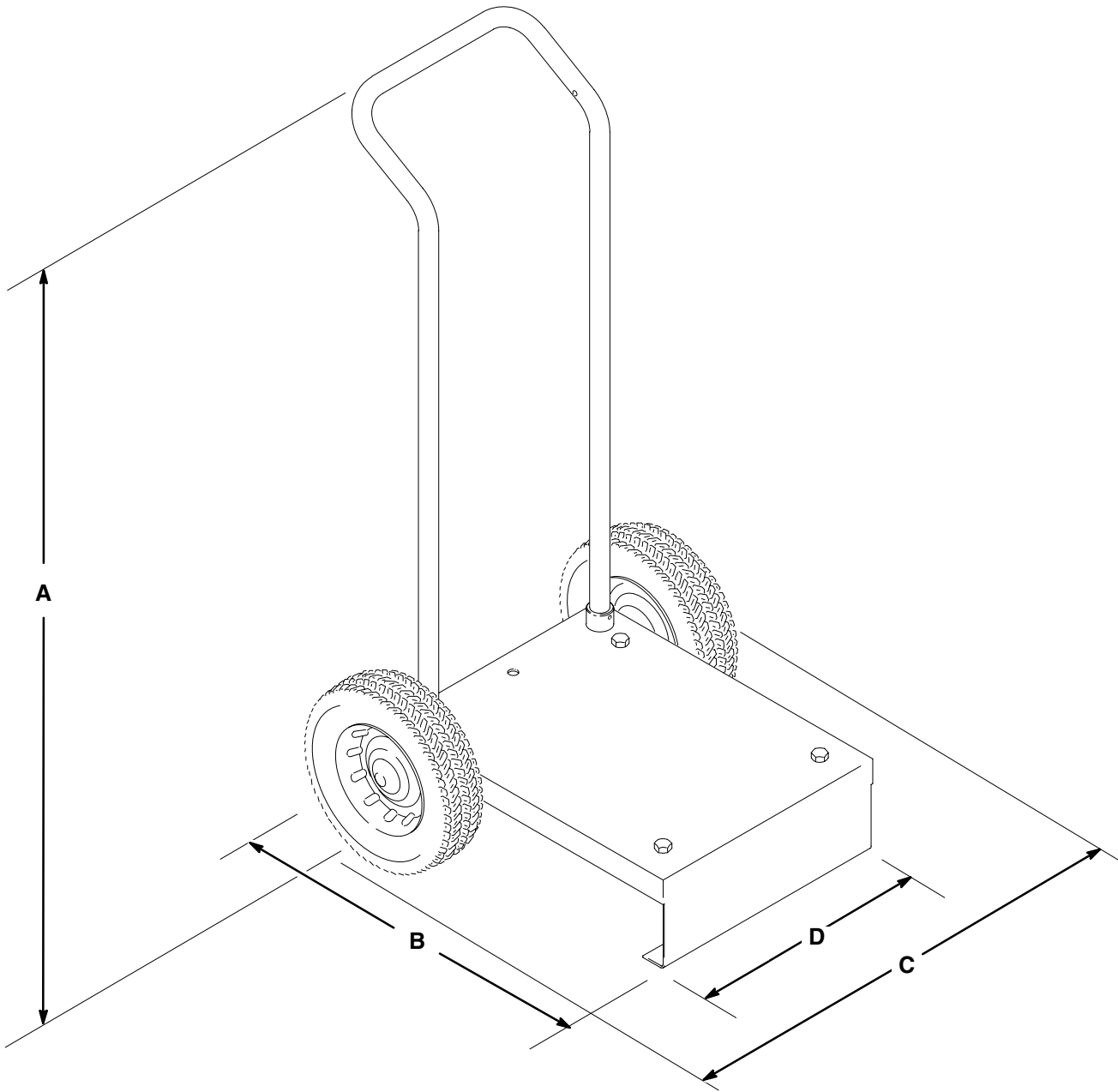

05505

Ram Model	A	B	C	D	Weight
237557	1021 mm (40.2 in.)	558.8 mm (22.0 in.)	571.5 mm (22.5 in.)	371.6 mm (14.63 in.)	79.2 kg (36 lb)

# Graco Standard Warranty

Graco warrants all equipment manufactured by Graco and bearing its name to be free from defects in material and workmanship on the date of sale to the original purchaser for use. With the exception of any special, extended, or limited warranty published by Graco, Graco will, for a period of twelve months from the date of sale, repair or replace any part of the equipment determined by Graco to be defective. This warranty applies only when the equipment is installed, operated and maintained in accordance with Graco's written recommendations.

This warranty does not cover, and Graco shall not be liable for general wear and tear, or any malfunction, damage or wear caused by faulty installation, misapplication, abrasion, corrosion, inadequate or improper maintenance, negligence, accident, tampering, or substitution of non-Graco component parts. Nor shall Graco be liable for malfunction, damage or wear caused by the incompatibility of Graco equipment with structures, accessories, equipment or materials not supplied by Graco, or the improper design, manufacture, installation, operation or maintenance of structures, accessories, equipment or materials not supplied by Graco.

This warranty is conditioned upon the prepaid return of the equipment claimed to be defective to an authorized Graco distributor for verification of the claimed defect. If the claimed defect is verified, Graco will repair or replace free of charge any defective parts. The equipment will be returned to the original purchaser transportation prepaid. If inspection of the equipment does not disclose any defect in material or workmanship, repairs will be made at a reasonable charge, which charges may include the costs of parts, labor, and transportation.

**THIS WARRANTY IS EXCLUSIVE, AND IS IN LIEU OF ANY OTHER WARRANTIES, EXPRESS OR IMPLIED, INCLUDING BUT NOT LIMITED TO WARRANTY OF MERCHANTABILITY OR WARRANTY OF FITNESS FOR A PARTICULAR PURPOSE.**

Graco's sole obligation and buyer's sole remedy for any breach of warranty shall be as set forth above. The buyer agrees that no other remedy (including, but not limited to, incidental or consequential damages for lost profits, lost sales, injury to person or property, or any other incidental or consequential loss) shall be available. Any action for breach of warranty must be brought within two (2) years of the date of sale.

Graco makes no warranty, and disclaims all implied warranties of merchantability and fitness for a particular purpose in connection with accessories, equipment, materials or components sold but not manufactured by Graco. These items sold, but not manufactured by Graco (such as electric motors, switches, hose, etc.), are subject to the warranty, if any, of their manufacturer. Graco will provide purchaser with reasonable assistance in making any claim for breach of these warranties.

In no event will Graco be liable for indirect, incidental, special or consequential damages resulting from Graco supplying equipment hereunder, or the furnishing, performance, or use of any products or other goods sold hereto, whether due to a breach of contract, breach of warranty, the negligence of Graco, or otherwise.

## **FOR GRACO CANADA CUSTOMERS**

The parties acknowledge that they have required that the present document, as well as all documents, notices and legal proceedings entered into, given or instituted pursuant hereto or relating directly or indirectly hereto, be drawn up in English. Les parties reconnaissent avoir convenu que la rédaction du présente document sera en Anglais, ainsi que tous documents, avis et procédures judiciaires exécutés, donnés ou intentés à la suite de ou en rapport, directement ou indirectement, avec les procédures concernées.

# Graco Information

**TO PLACE AN ORDER**, contact your Graco distributor, or call one of the following numbers to identify the distributor closest to you:

**1-800-367-4023 Toll Free**

**612-623-6921**

**612-378-3505 Fax**

*All written and visual data contained in this document reflects the latest product information available at the time of publication.  
Graco reserves the right to make changes at any time without notice.*

**Sales Offices:** Minneapolis, Detroit  
**International Offices:** Belgium, Korea, Hong Kong, Japan

**[www.graco.com](http://www.graco.com)**

PRINTED IN USA 308567 09/1995, Revised 12/2003