

# Instructions – Parts List



## Electronic Lubricant Meters

307999 rev.K

### Electronic Control

#### 235–878 Gallon/Quart/Pint

Used in all gallon/quart/pint applications

#### 235–901 Liter

Used in all liter applications



#### Important Safety Instructions

Read all warnings and instructions in this manual.  
Save these instructions.

### WARNING

#### Pressure Relief Procedure

To reduce the risk of serious bodily injury, including fluid injection or splashing in the eyes or on the skin, always follow this procedure when you shut down the system and before you check or repair the meter or any part of the system.

1. Turn off the power supply to the pump.
2. Trigger the valve into a waste container to relieve pressure.
3. Open any bleed-type master air valves and fluid drain valves in the system.
4. Leave the drain valve open until you are ready to dispense again.

#### Handle and dispose of a used electronic control properly.

To reduce the risk of a fire, explosion, and serious burns to the body, handle and dispose of a used electronic control properly.

The electronic control contains a lithium battery. Do not short circuit, charge, force over discharge, disassemble, crush, penetrate, incinerate, or heat the battery to a temperature exceeding 185° F (85° C). Any misuse or abuse of the battery could cause it to leak or explode.

PROVEN QUALITY. LEADING TECHNOLOGY.

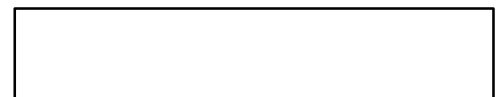

# Service

## ⚠ CAUTION

To avoid damaging the electronic components of the control:

- **Always** use the personal grounding strap provided with the kits when you remove the cover (A) and while you replace parts. This strap protects the electronic components from damage due to electrostatic discharge.
- Do not lay anything on the control.
- Be sure the open side of the control faces up if you lay it down.
- Do not twist or force parts. Align them properly as instructed below.

### 1. Relieve the pressure.

## ⚠ WARNING

To reduce the risk of serious injury, when you are instructed to relieve pressure, always follow the **Pressure Relief Procedure** on page 1.

2. Attach the disposable grounding wrist strap to your wrist. Connect the adhesive-backed copper foil at the other end to any convenient electrical ground, such as the grounding screw or metal case of a grounded electrical outlet.
3. Lift the bottom edge of the black cover (A) away from the meter, and pull the cover off. Remove and discard the screws (B). Lift off the electronic control (D). Remove and discard the large o-ring (F), if one is used. See Fig. 1.
4. Install a new electronic control (D). Install the large o-ring (F) over the lip on the top of the metering unit (E). Align the notch on the side of the electronic control (D) with the notch on the side of the metering unit (E). Install the new screws (B), and tighten them oppositely and evenly 3 in-lb to 5 in-lb (0.34 N-m to 0.57 N-m) until a complete seal is obtained, as shown in the DETAIL in Fig. 1.
5. Install the cover so the rolled-in edges are parallel with the inlet fluid passage of the metering unit.

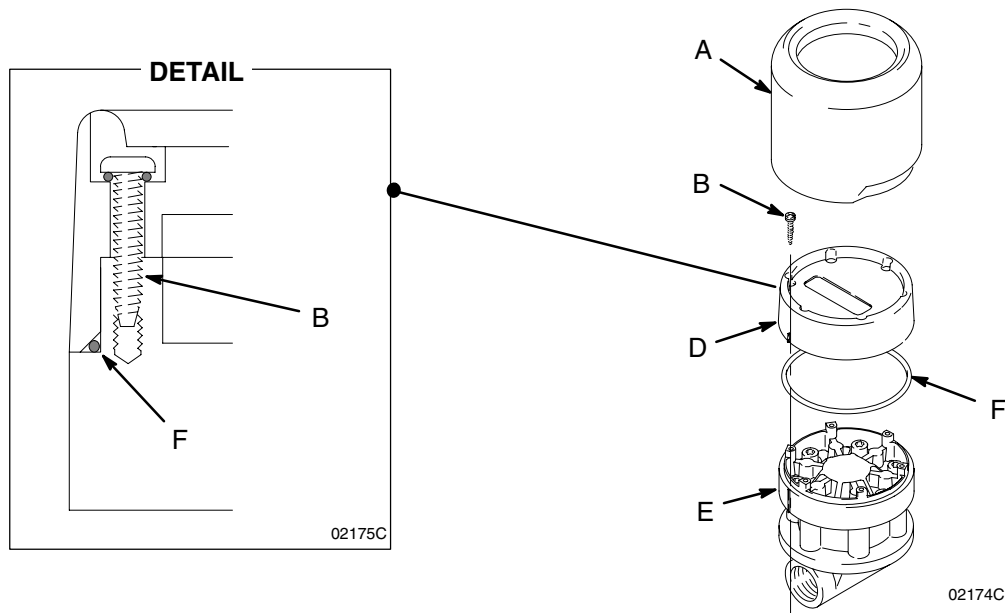

Fig. 1

*All written and visual data contained in this document reflects the latest product information available at the time of publication.  
Graco reserves the right to make changes at any time without notice.*

MM 307999

**Graco Headquarters:** Minneapolis  
**International Offices:** Belgium, Korea, China, Japan

**GRACO INC. P.O. BOX 1441 MINNEAPOLIS, MN 55440-1441**  
**www.graco.com**

307999 June 1989, Revised 06/2006